

## DISASSEMBLY – UPHOLSTERED SEAT

### EXPLODED VIEW

BOM ID	Description	Qty	Material
1	Arm Screw #10-16x3/4" FLTPHIL	4	Stainless Steel
2	Seat Screw #12x1/2" PAN PHIL	10	Stainless Steel
3	Glide	4	Plastic
4	Seat Screw	8	Stainless Steel
5	Frame	12	Steel
6	Seat Shell	1	Plastic
7	Arm Cap	6	Plastic
8	Seat Insert	1	Plastic
9	Seat Foam	1	Steel
10	Shroud	1	Plastic

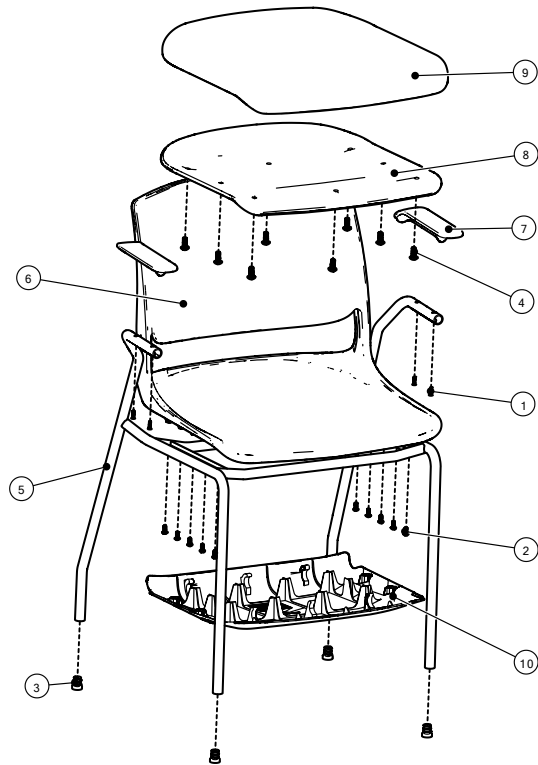

### 1- REMOVE SHROUD

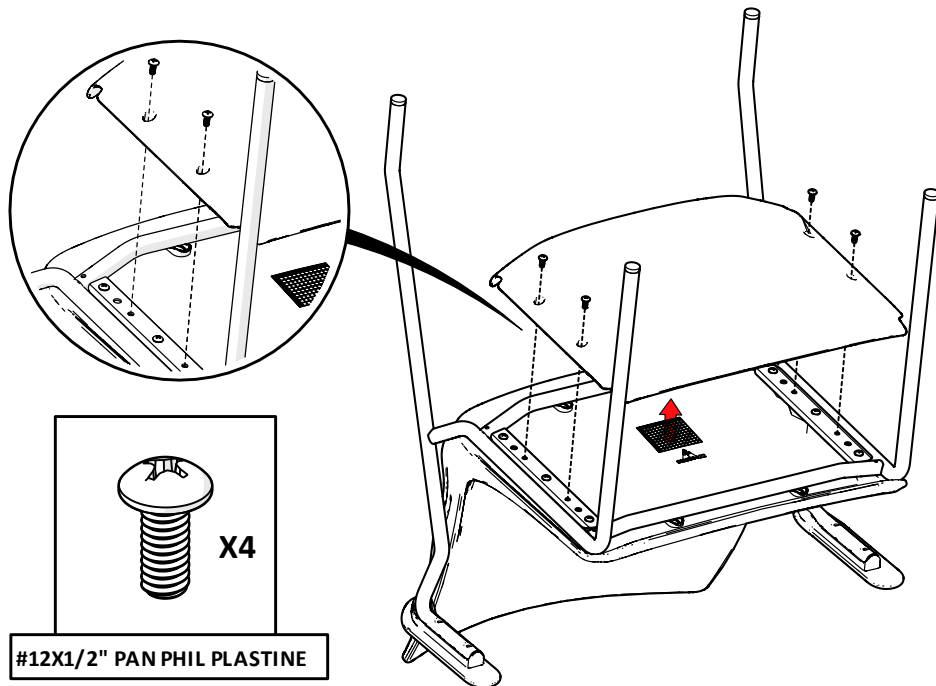

## 1- REMOVE SHROUD

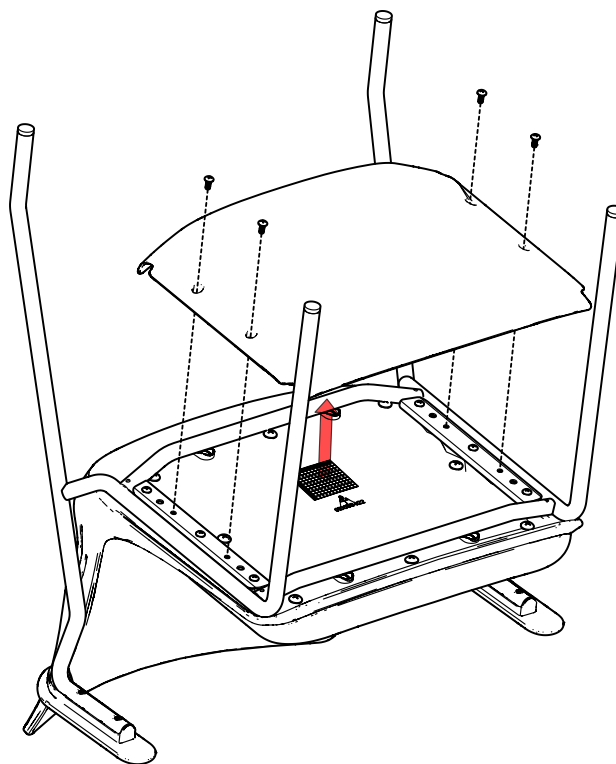

## 2- REMOVE FRAME FROM SEAT

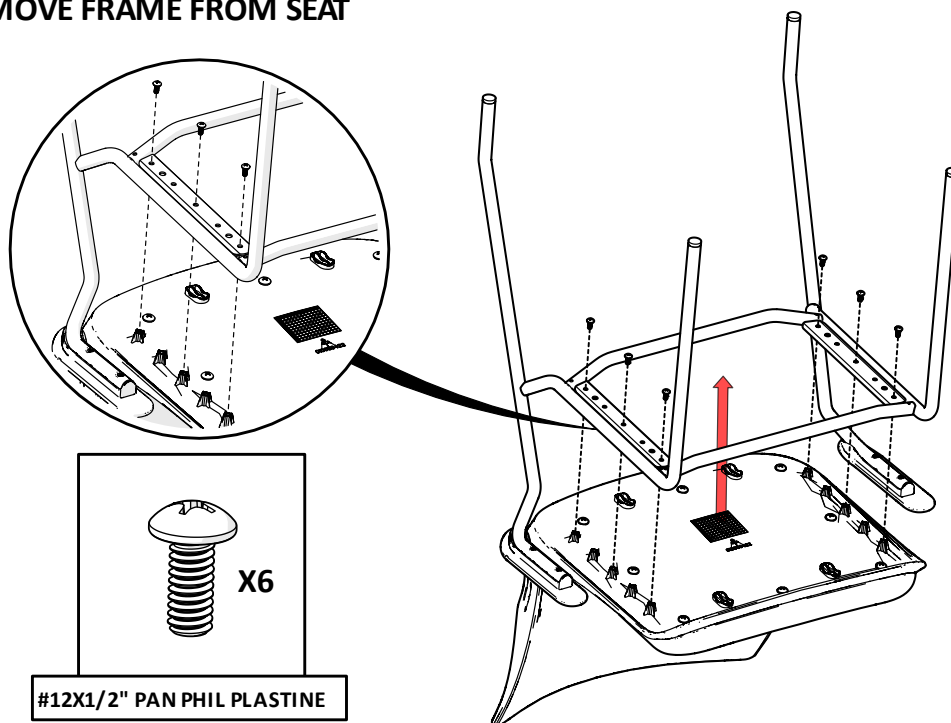

### 3- REMOVE SEAT

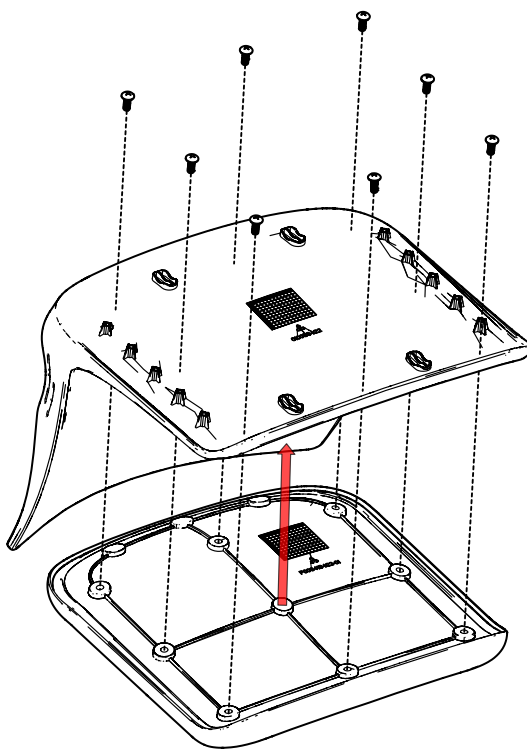
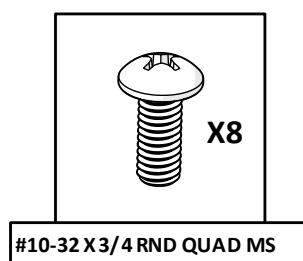

### 4- REMOVE GLIDES

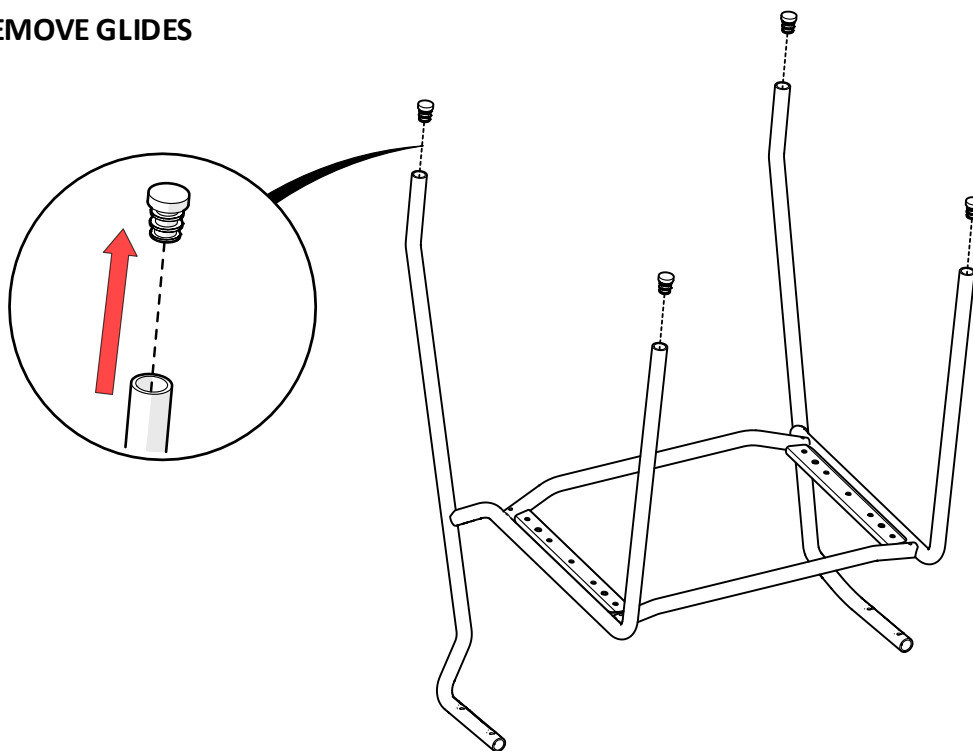

END

#### 4.1- REMOVE CASTERS

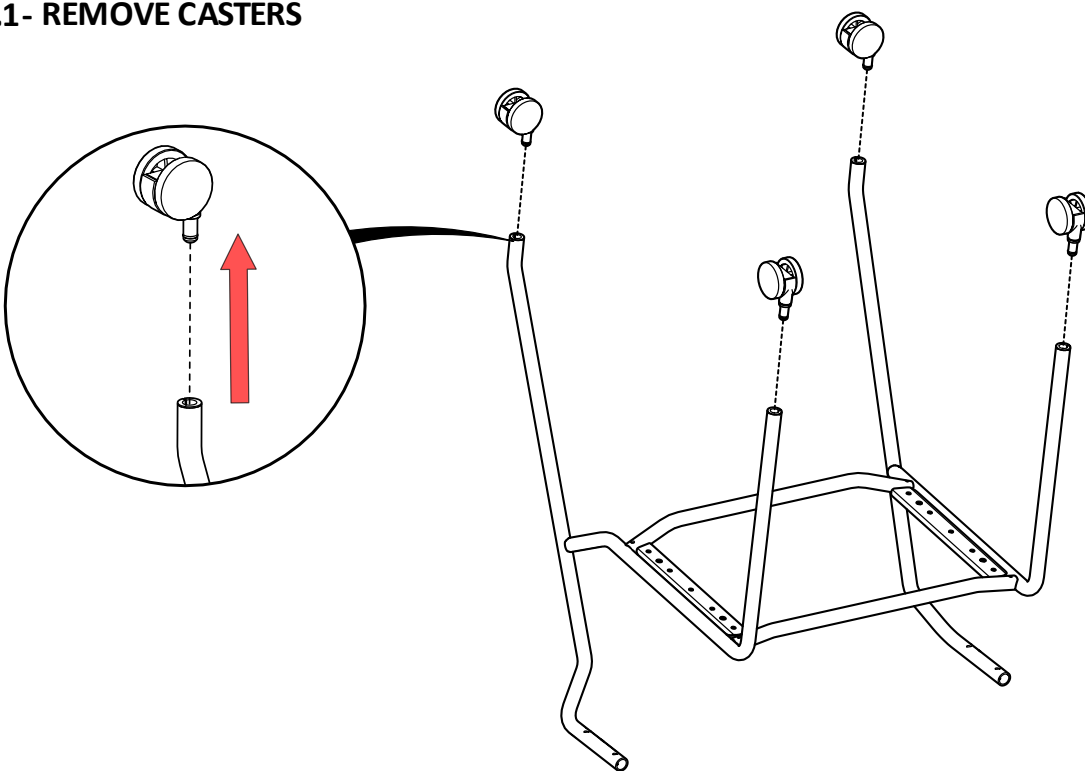

#### 4.2- REMOVE GLIDES

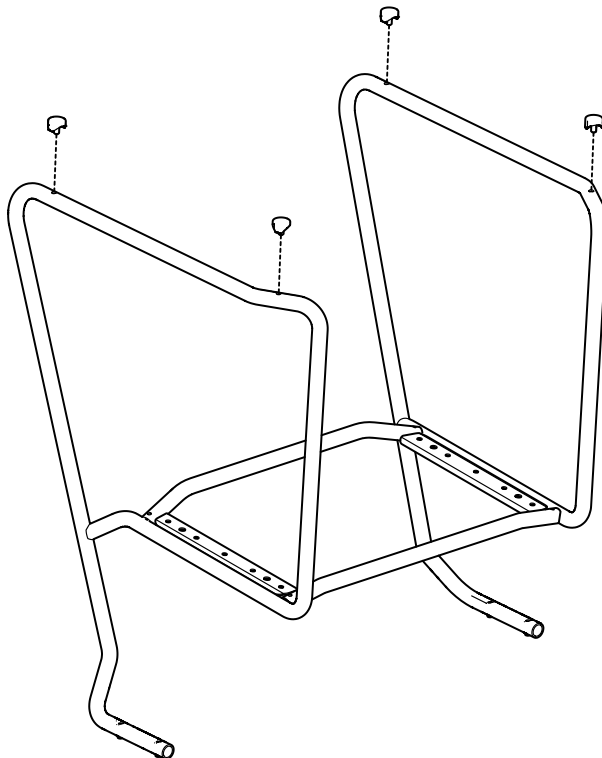

END

## DISASSEMBLY – PLASTIC SEAT

### EXPLODED VIEW

BOM ID	Description	Qty	Material
1	Arm Screw #10-16x3/4" FLT PHIL	4	Stainless Steel
2	Seat Screw #12x1/2" PAN PHIL	10	Stainless Steel
3	Glide	4	Plastic
5	Frame	12	Steel
6	Seat Shell	1	Plastic
7	Arm Cap	6	Plastic
10	Shroud	1	Plastic

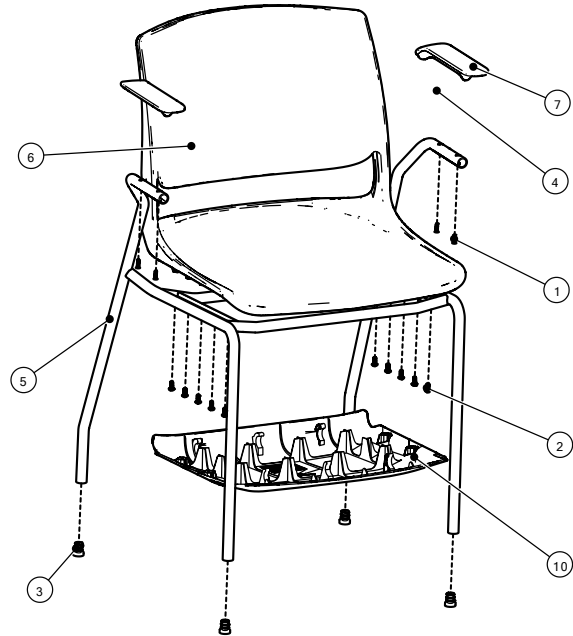

### 1- REMOVE SHROUD

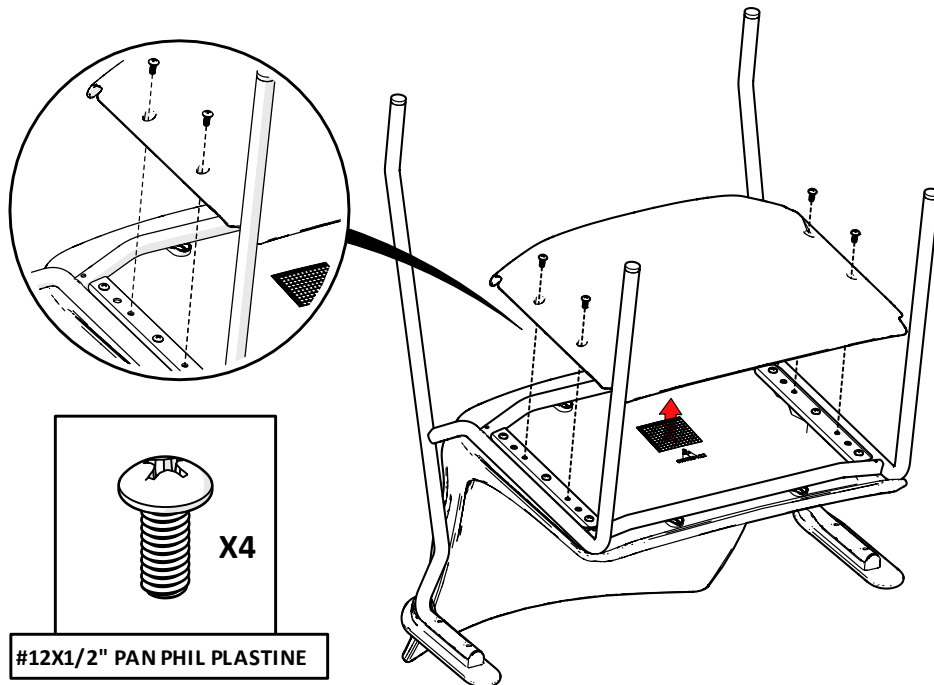

## 2- REMOVE FRAME FROM SEAT

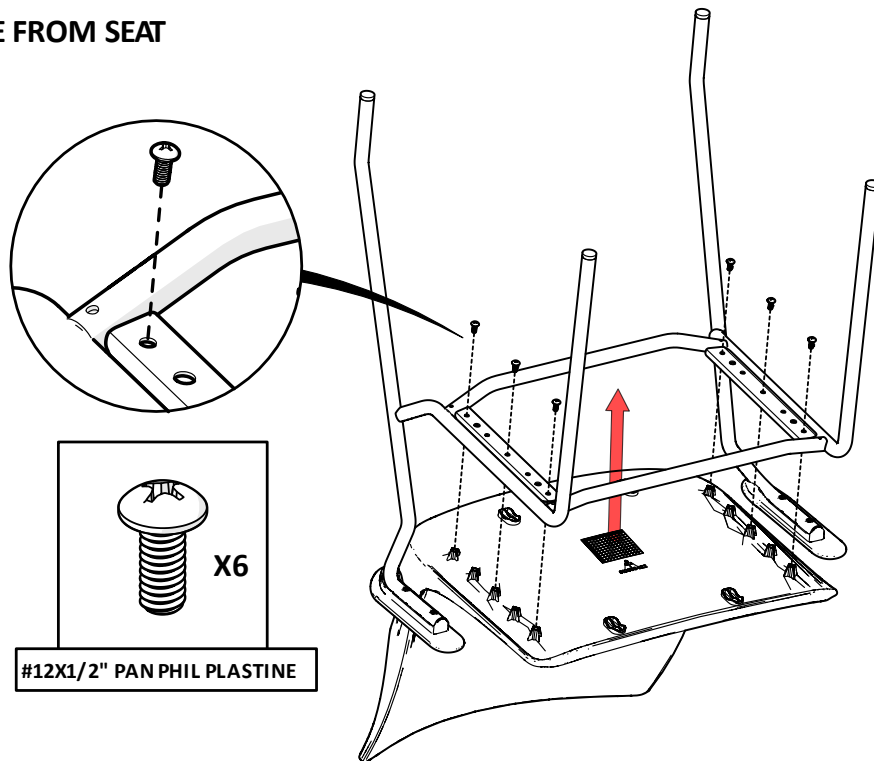

## 3- REMOVE ARM CAPS

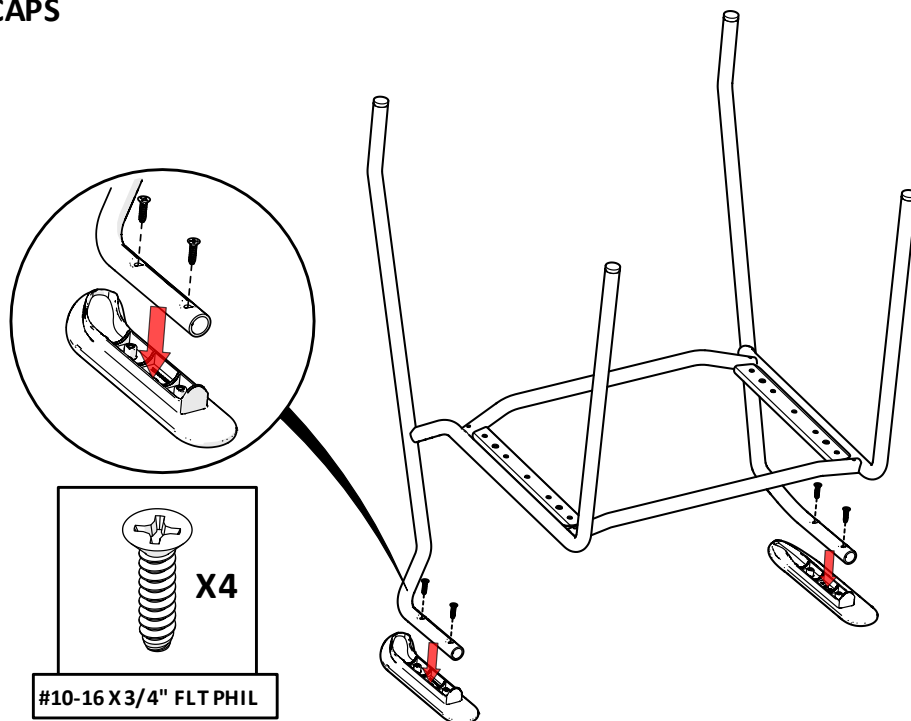

#### 4- REMOVE GLIDES

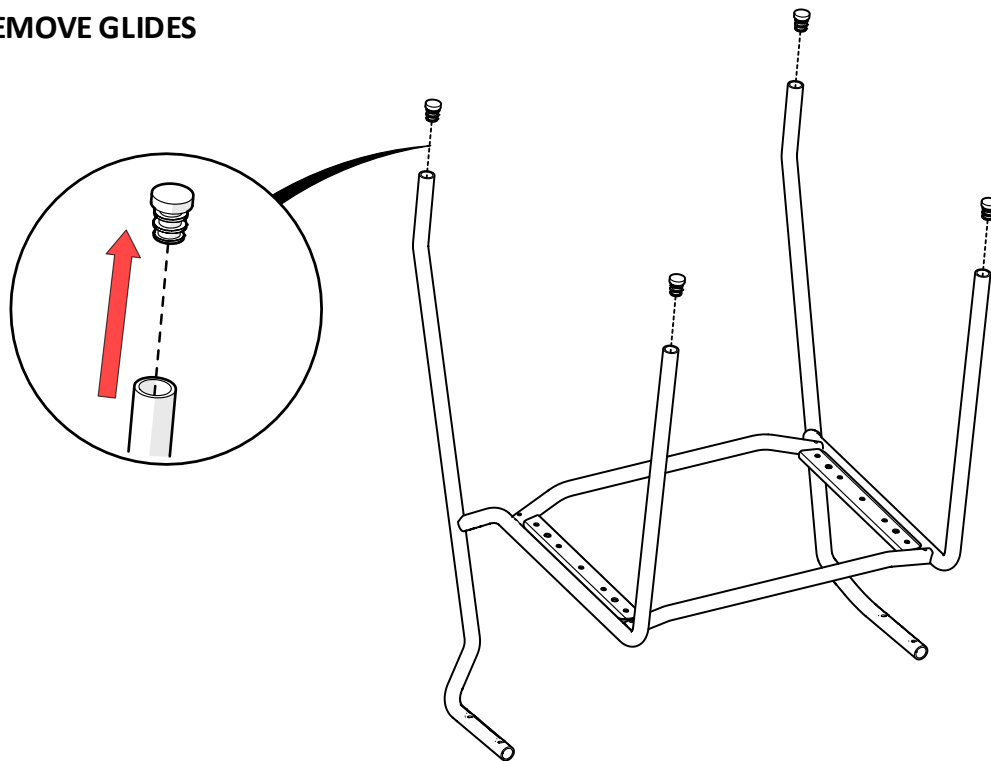

#### 4.1- REMOVE CASTERS (CASTER MODEL)

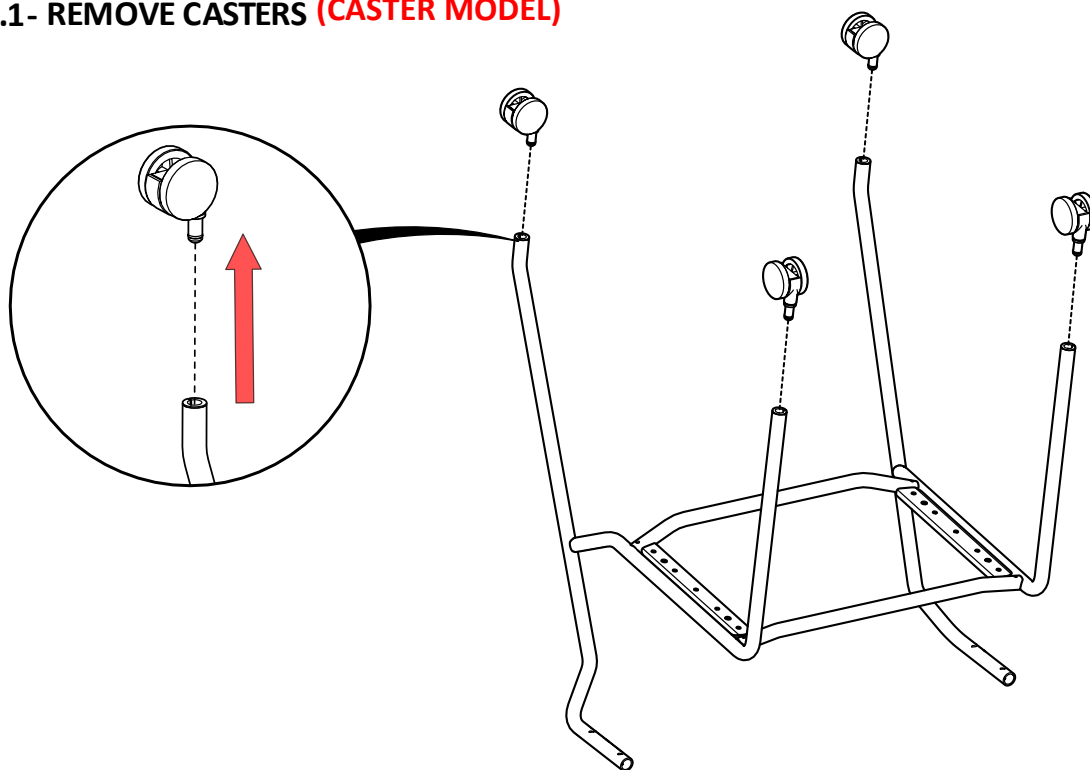

#### 4.2-REMOVE GLIDES (SLED BASE)

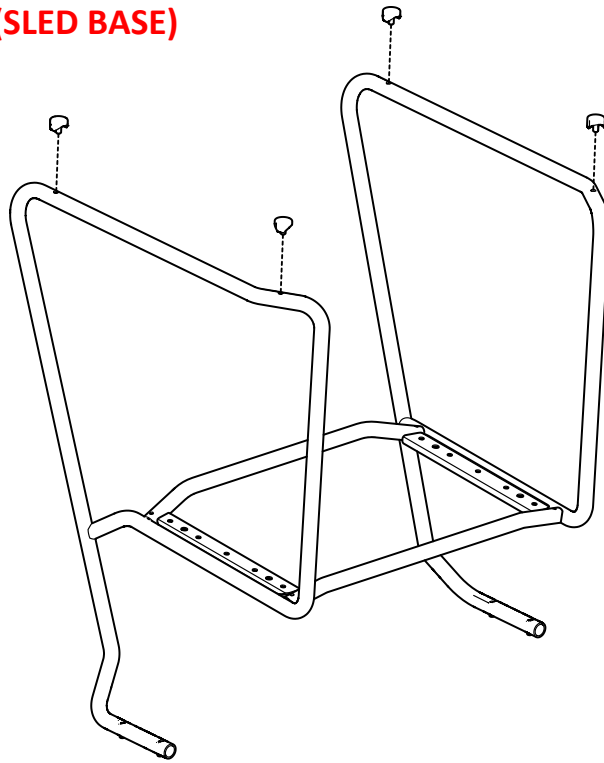

END