

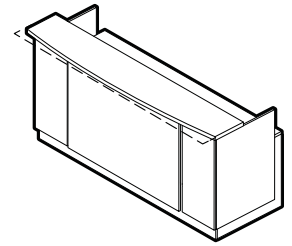

ZIRA

Reception Desk
Bow/Straight

Z2460RDB	Z3060RDB	Z2460RDS	Z3060RDS
Z2466RDB	Z3066RDB	Z2466RDS	Z3066RDS
Z2472RDB	Z3072RDB	Z2472RDS	Z3072RDS
Z2484RDB	Z3084RDB	Z2484RDS	Z3084RDS
Z2496RDB	Z3096RDB	Z2496RDS	Z3096RDS



Disassembly Instructions

TOOLS REQUIRED



WRENCH
Size #16 or 5/8"

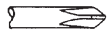

PHILLIPS
Screwdriver size #2

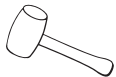

Rubber Mallet



Safety Glasses



ALLEN KEY
Size #5

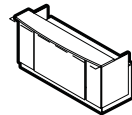
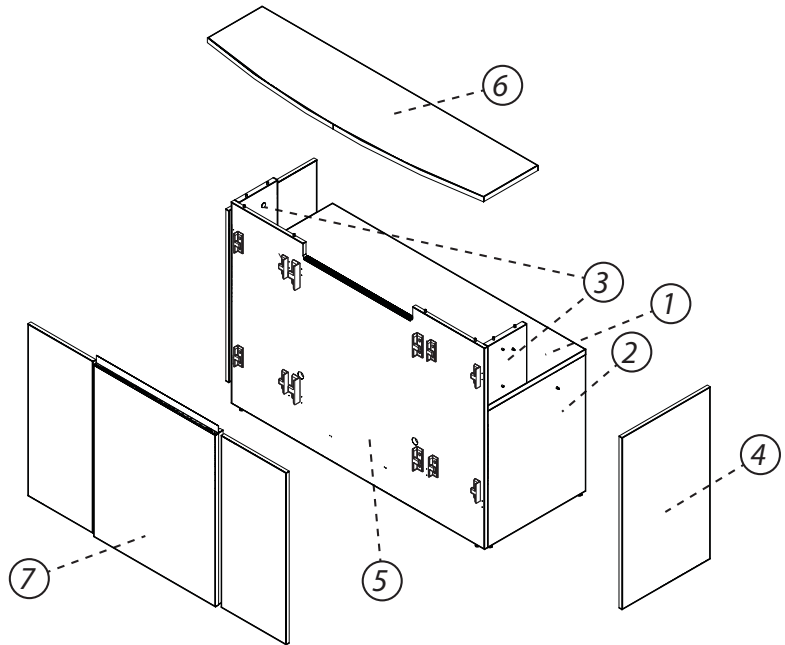

ITEM	DESCRIPTION	QUANTITIES					MATERIAL
1	TOP	1					PARTICLEBOARD
2	GABLE	2					PARTICLEBOARD
3	TT SUPPORT	2					PARTICLEBOARD
4	SIDE CLADDING	2					PARTICLEBOARD
5	BACK	1					PARTICLEBOARD
6	TRANSITIONAL TOP	1					PARTICLEBOARD
7	CLADDING	3					ALUMINIUM
8	GROMMET	1					PLASTIC
9	LEVELER	6					STEEL/PLASTIC
10	SCREWS/BOLTS	85					STEEL

Please contact Global Customer Care at 905-660-5101 for any questions or concerns.

STEPS

- Untighten Blum Connectors and released Transitional top.
- Pull up Cladding Panels
- Unscrew and remove bolts and plastic connectors.

D Unscrew and remove bolts and plastic connectors from back panel.

E Untighten Blum Connectors, unscrew bolt using Allen Key and release Side Cladding and TT Support panel.

E Turn unit. Untighten Blum Connectors and release Top and Gables. Remove Blum Bolts and Levelers.

NOTE: Any alterations to listed components will void the manufacturer's warranty. The manufacturer will not be responsible for any damage or bodily harm caused by alterations in accordance with national or local electrical codes and manufacturer's specifications. In accordance with the manufacturer's policy of continual product improvement, the product presented in this document is subject to change without notice or obligation.

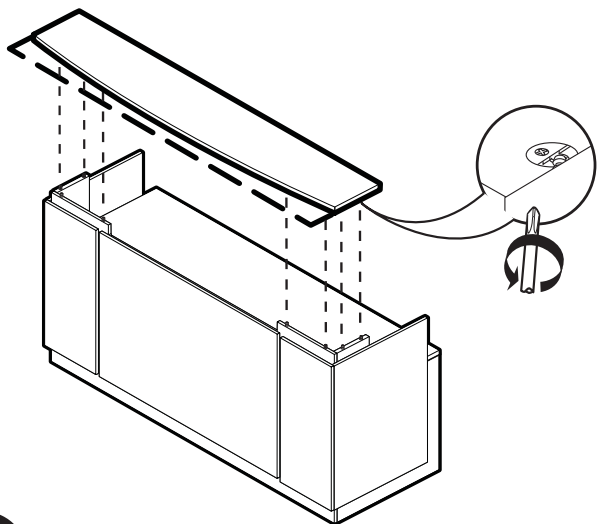
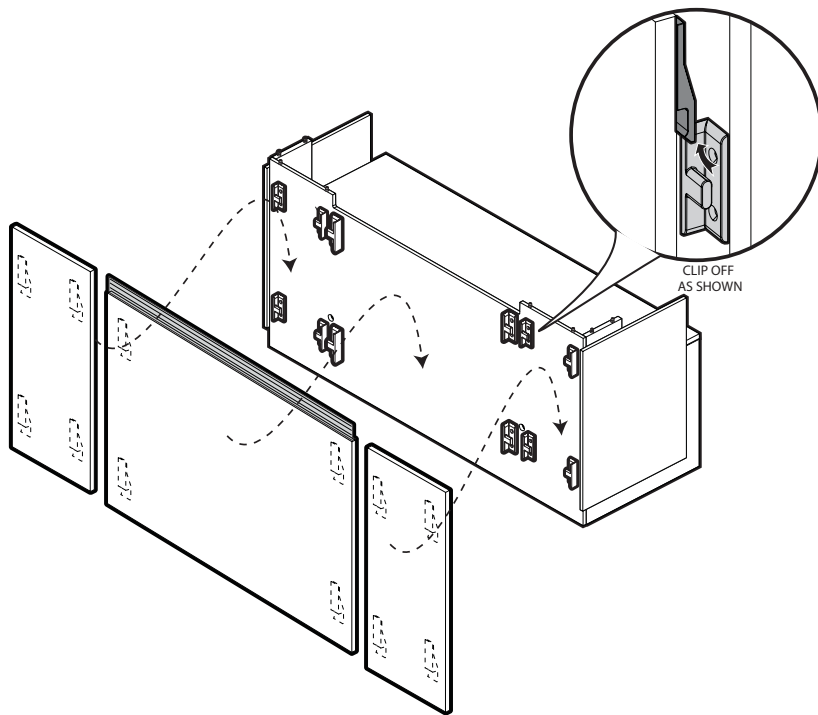
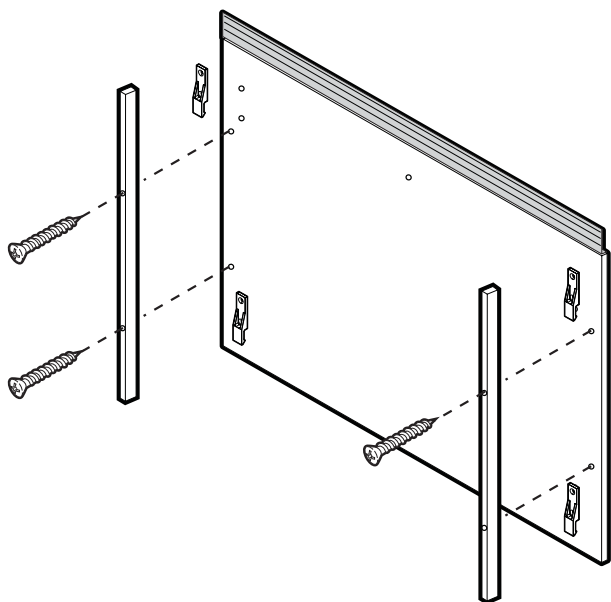
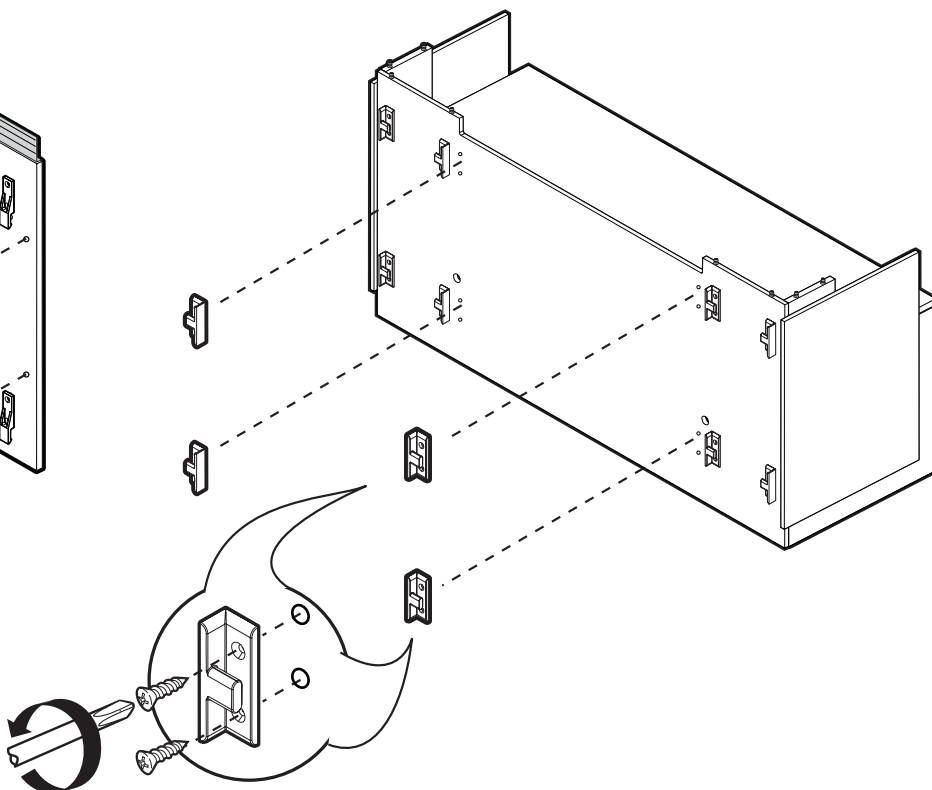
A**B****C****D**

E

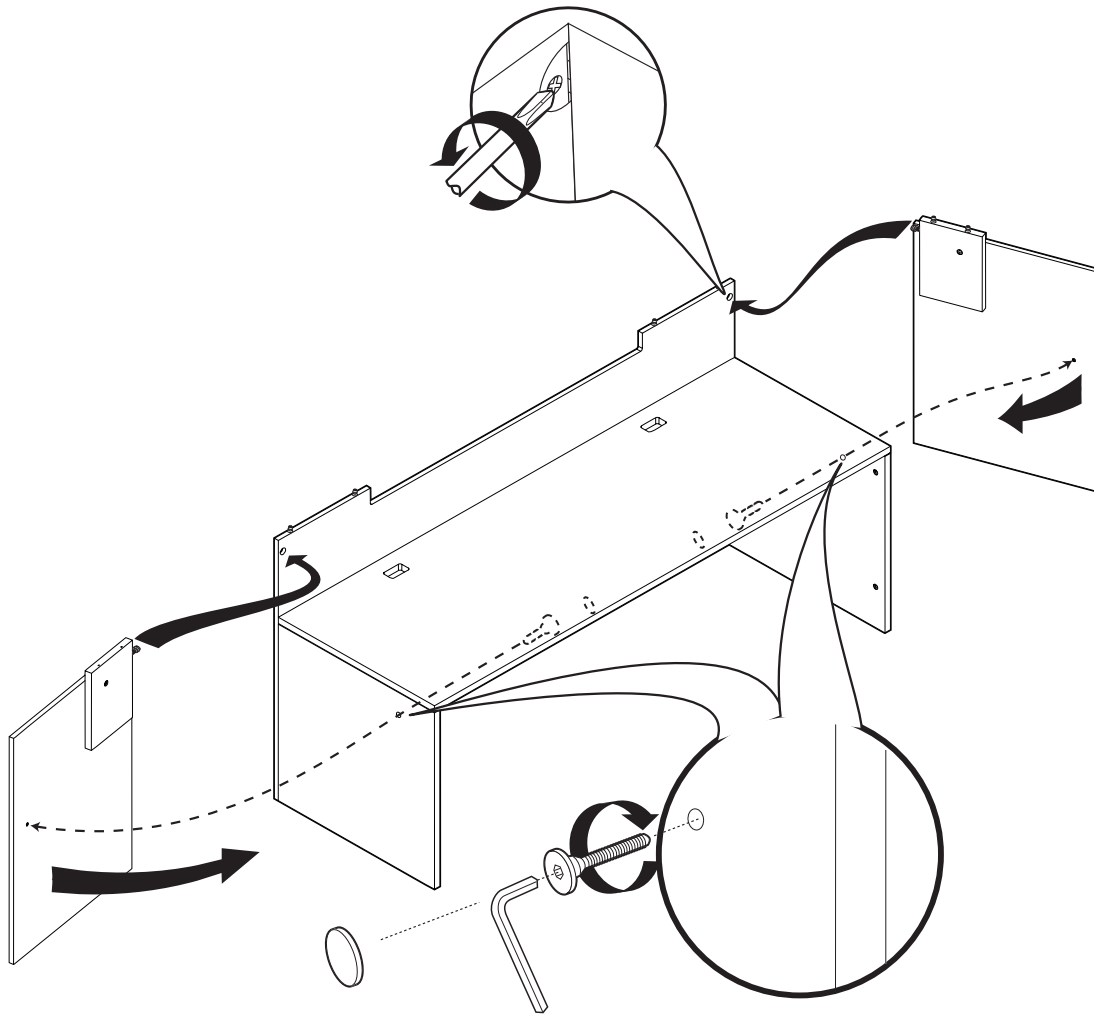

F

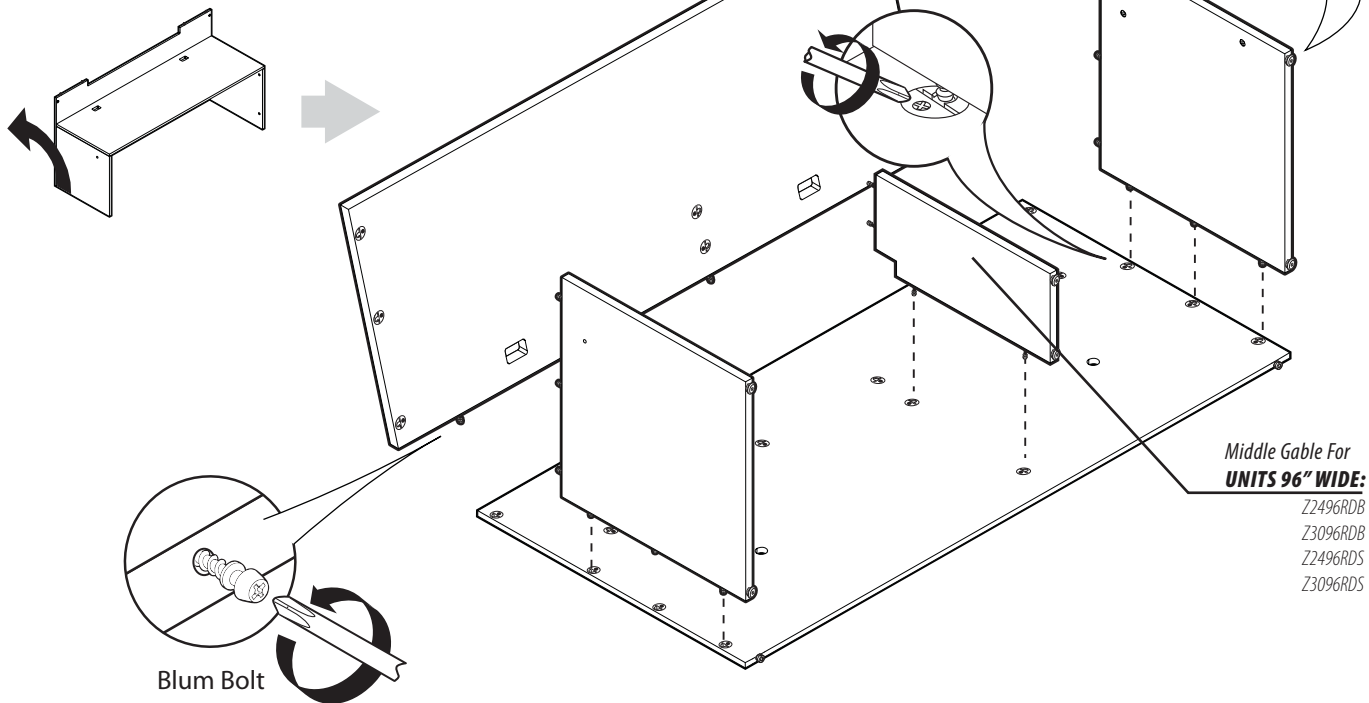



ZIRA
Low Reception Return
High Reception Return
Transactional Bow R. R.
Transactional Straight R. R.

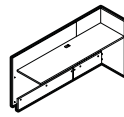

Z2060HRR L/R
Z2072HRR L/R
Z2460HRR L/R
Z2472HRR L/R

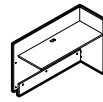

Z2036HRR L/R
Z2042HRR L/R
Z2048HRR L/R
Z2054HRR L/R
Z2436HRR L/R
Z2442HRR L/R
Z2448HRR L/R
Z2454HRR L/R

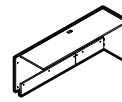

Z2060LRR L/R
Z2072LRR L/R
Z2460LRR L/R
Z2472LRR L/R

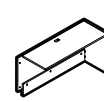

Z2036LRR L/R
Z2042LRR L/R
Z2048LRR L/R
Z2054LRR L/R
Z2436LRR L/R
Z2442LRR L/R
Z2448LRR L/R
Z2454LRR L/R

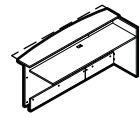

Z2460...72TSR L/R
Z2060...72TSR L/R
Z2460...72TBR L/R
Z2060...72TBR L/R

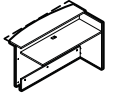

Z2436...54TSR L/R
Z2036...54TSR L/R
Z2436...54TBR L/R
Z2036...54TBR L/R

Disassembly Instructions

TOOLS REQUIRED



WRENCH
Size #16 or 5/8"



PHILLIPS
Screwdriver size #2

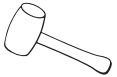

Rubber Mallet



Safety Glasses



ALLEN KEY
Size #5

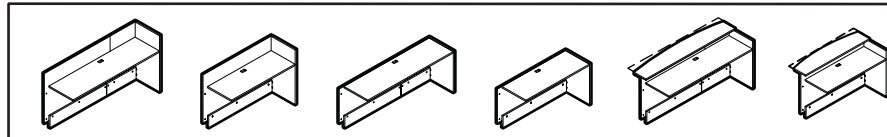
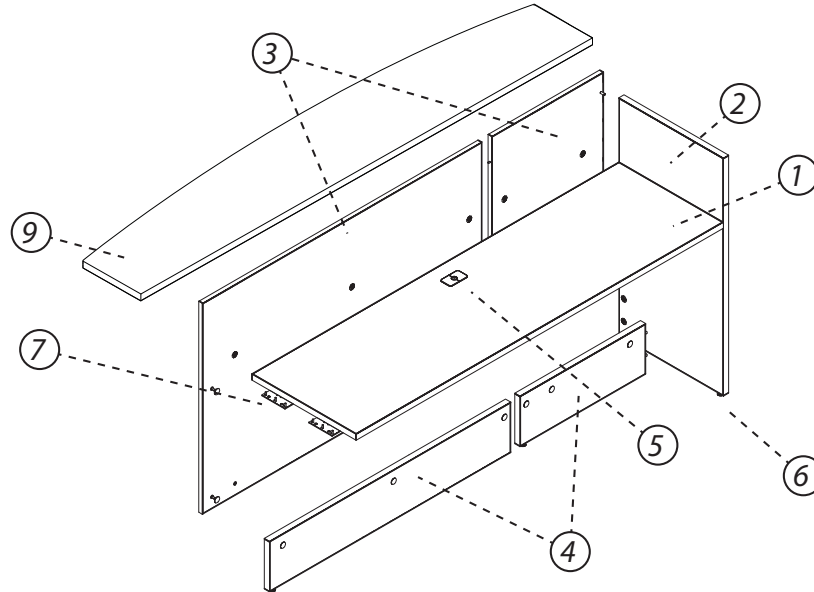

ITEM	DESCRIPTION	QUANTITIES								MATERIAL
		1	2	3	4	5	6	7	8	
1	TOP	1	1	1	1	1	1	1	1	PARTICLEBOARD
2	GABLE	1	1	1	1	1	1	1	1	PARTICLEBOARD
3	MODESTY PANEL	2	1	2	1	2	1			PARTICLEBOARD
4	KICKBASE	2	1	2	1	2	1			PARTICLEBOARD
5	GROMMET	1	1	1	1	1	1			PLASTIC
6	LEVELER	6	4	4	4	4	4			STEEL/PLASTIC
7	BRACKETS	2	2	2	2	2	2			STEEL
8	SCREWS/BOLTS	31	26	31	26	38	32			STEEL
9	TRANSACTIONAL TOP					1	1			PARTICLEBOARD

Please contact Global Customer Care at 905-660-5101 for any questions or concerns.

STEPS

- A** Unscrew and remove brackets and bolts, De-attach unit from Reception desk.
- B** For Transactional Bow or Straight Return: Untighten Blum Connectors and release Transactional Top.

- C** Turn unit. Untighten Blum Connectors. Unscrew and remove kickbase.

- D** Untighten Blum Connectors and release Top and Gables. Remove Blum Bolts and Levelers.

NOTE: Any alterations to listed components will void the manufacturer's warranty. The manufacturer will not be responsible for any damage or bodily harm caused by alterations in accordance with national or local electrical codes and manufacturer's specifications. In accordance with the manufacturer's policy of continual product improvement, the product presented in this document is subject to change without notice or obligation.

D

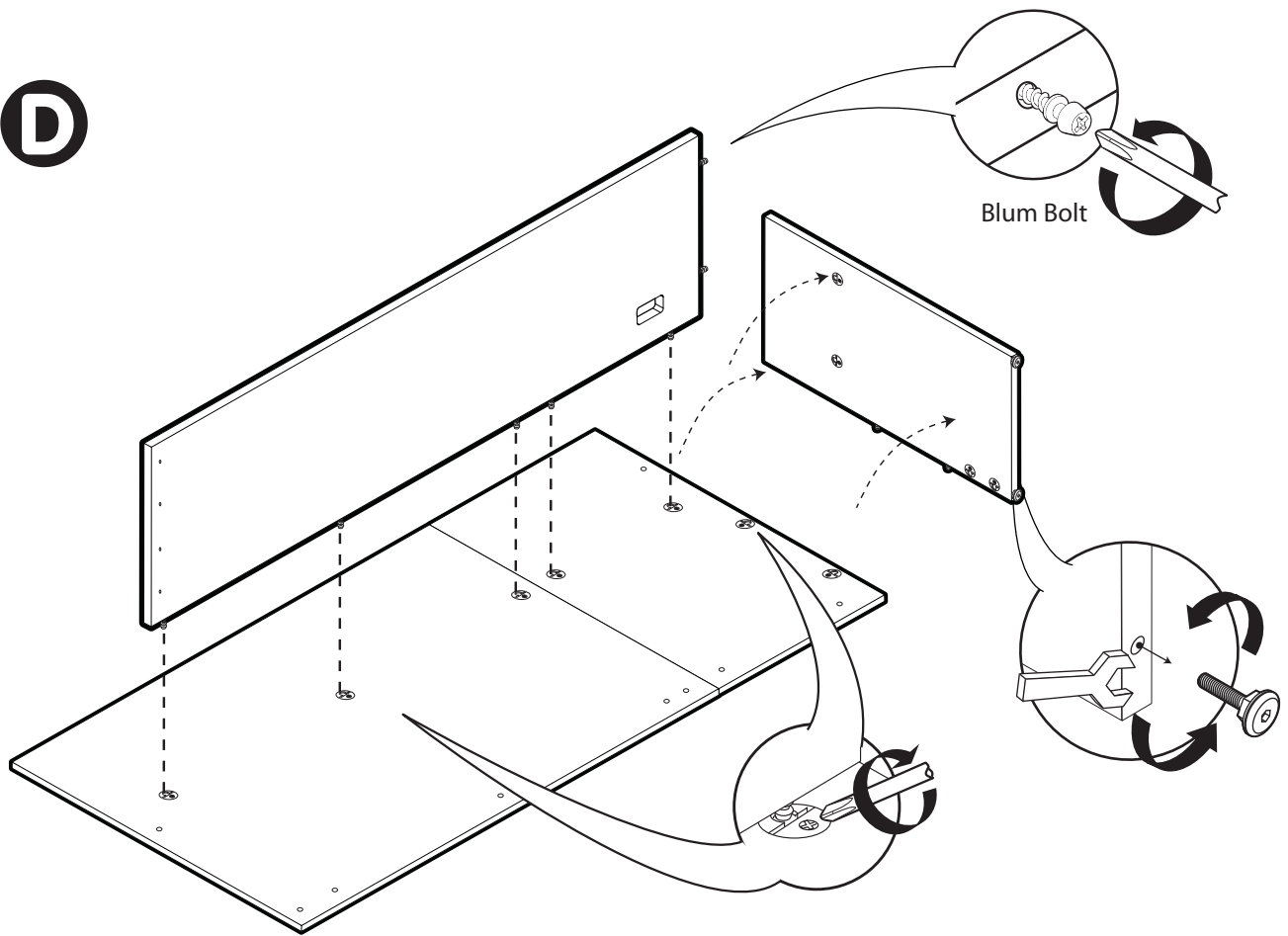

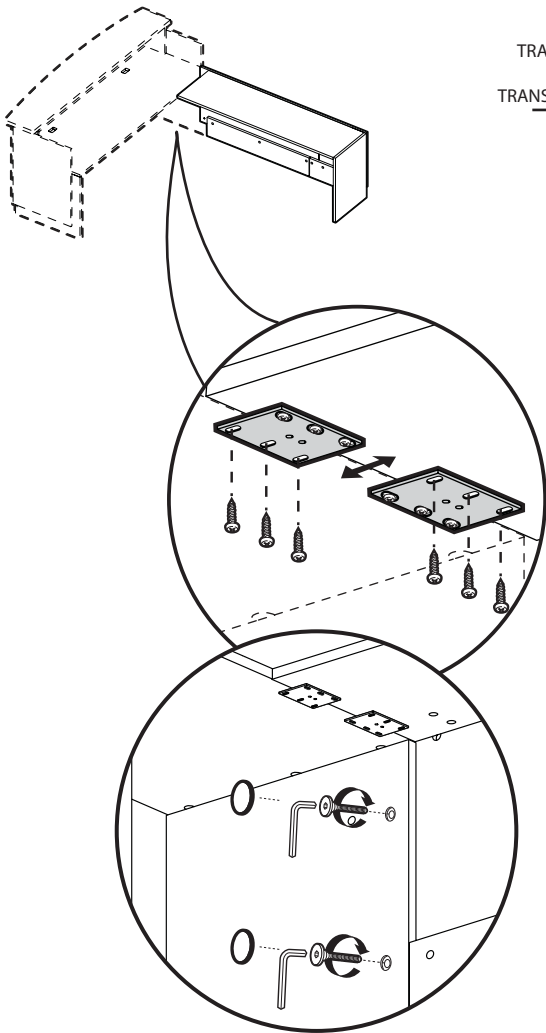
A**B**

TRANSACTION BOW TOP
OR
TRANSACTION STRAIGHT TOP

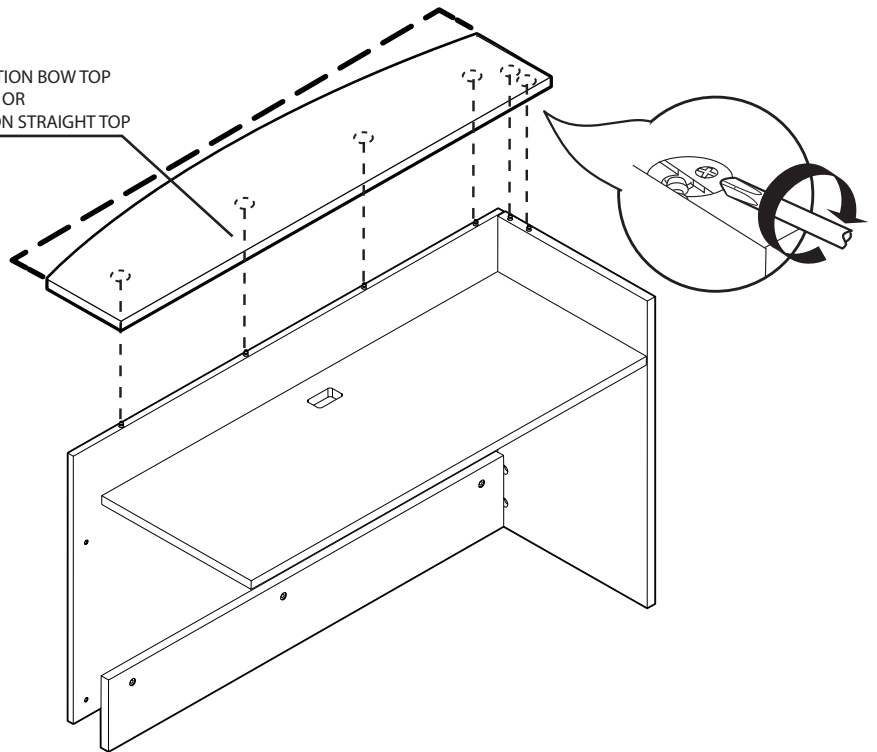
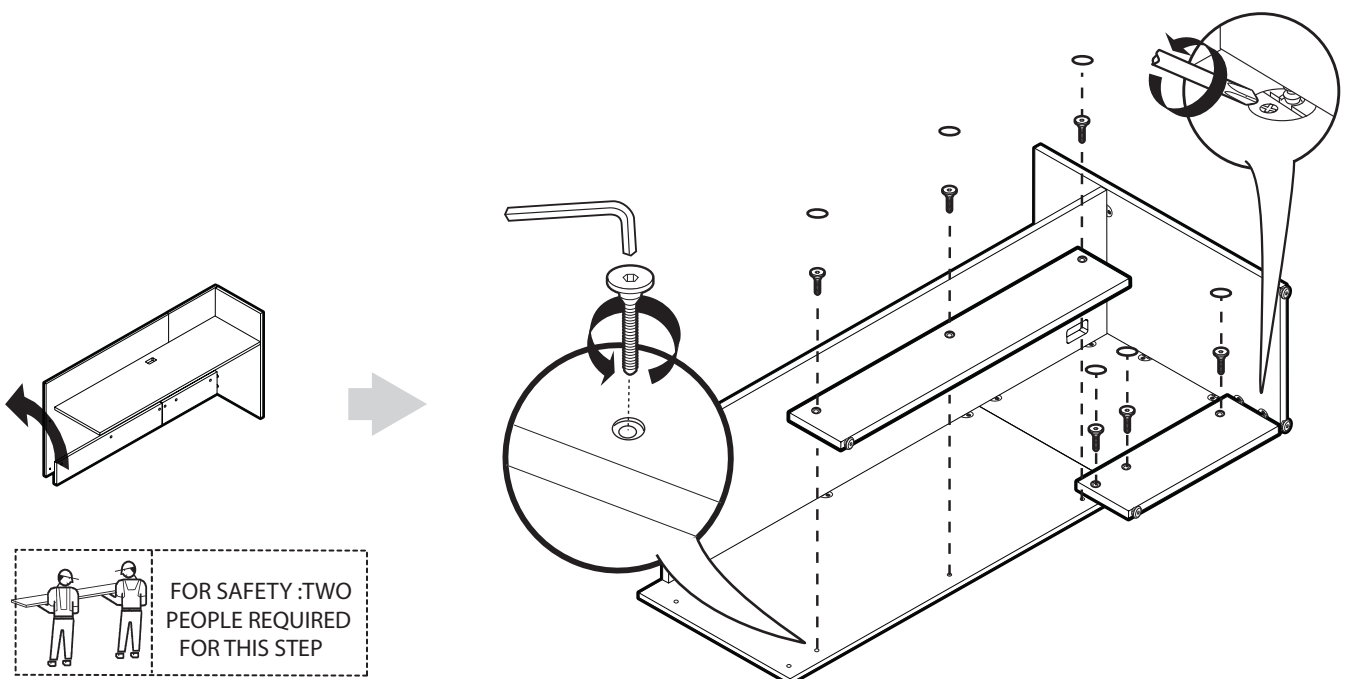
**C**



ZIRA

Pigeon Hole Reception Return

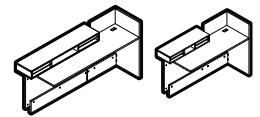

Z2072PRR L/R
Z2472PRR L/R

Z2054PRR L/R
Z2060PRR L/R
Z2454PRR L/R
Z2460PRR L/R

Disassembly Instructions

TOOLS REQUIRED



WRENCH
Size #16 or 5/8"

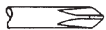

PHILLIPS
Screwdriver size #2

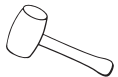

Rubber Mallet



Safety Glasses



ALLEN KEY
Size #5

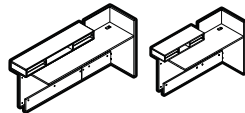
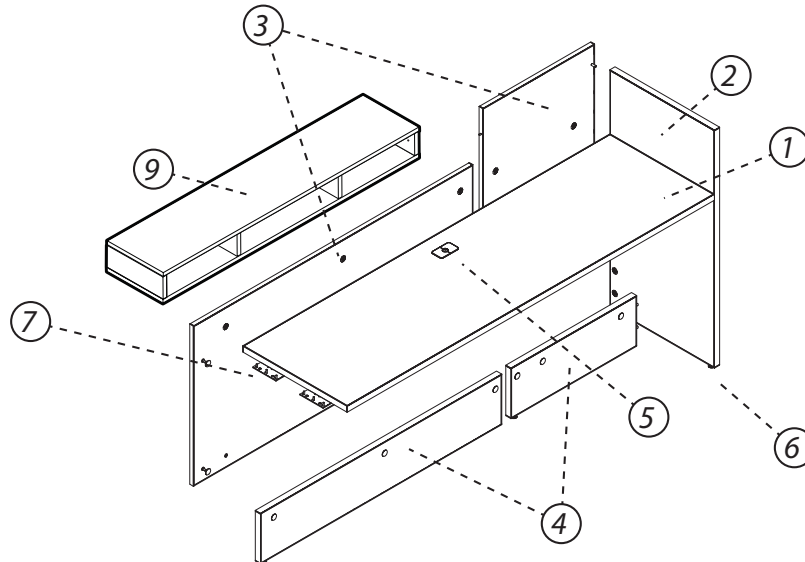

ITEM	DESCRIPTION	QUANTITIES						MATERIAL
1	TOP	1	1					PARTICLEBOARD
2	GABLE	1	1					PARTICLEBOARD
3	MODESTY PANEL	2	1					PARTICLEBOARD
4	KICKBASE	2	1					PARTICLEBOARD
5	GROMMET	1	1					PLASTIC
6	LEVELER	6	4					STEEL/PLASTIC
7	BRACKETS	2	2					STEEL
8	SCREWS/BOLTS	49	47					STEEL
9	PINGEON HOLE	1	1					PARTICLEBOARD

Please contact Global Customer Care at 905-660-5101 for any questions or concerns.

STEPS

A Unscrew and remove brackets and bolts, De-attach unit from Reception desk.

B Unscrew and de-attach Pigeon Hole from unit.

C On Pigeon Hole, Untighten MiniFix Connectors and release Pigeon's Top. Untighten Blum Connectors and release Pigeon Hole Divider. Unscrew MiniFix and Blum Bolts.

D Turn unit. Untighten Blum Connectors. Unscrew and remove kickbase.

E Untighten Blum Connectors and release Top and Gables. Remove Blum Bolts and Levelers.

NOTE: Any alterations to listed components will void the manufacturer's warranty. The manufacturer will not be responsible for any damage or bodily harm caused by alterations in accordance with national or local electrical codes and manufacturer's specifications. In accordance with the manufacturer's policy of continual product improvement, the product presented in this document is subject to change without notice or obligation.

D

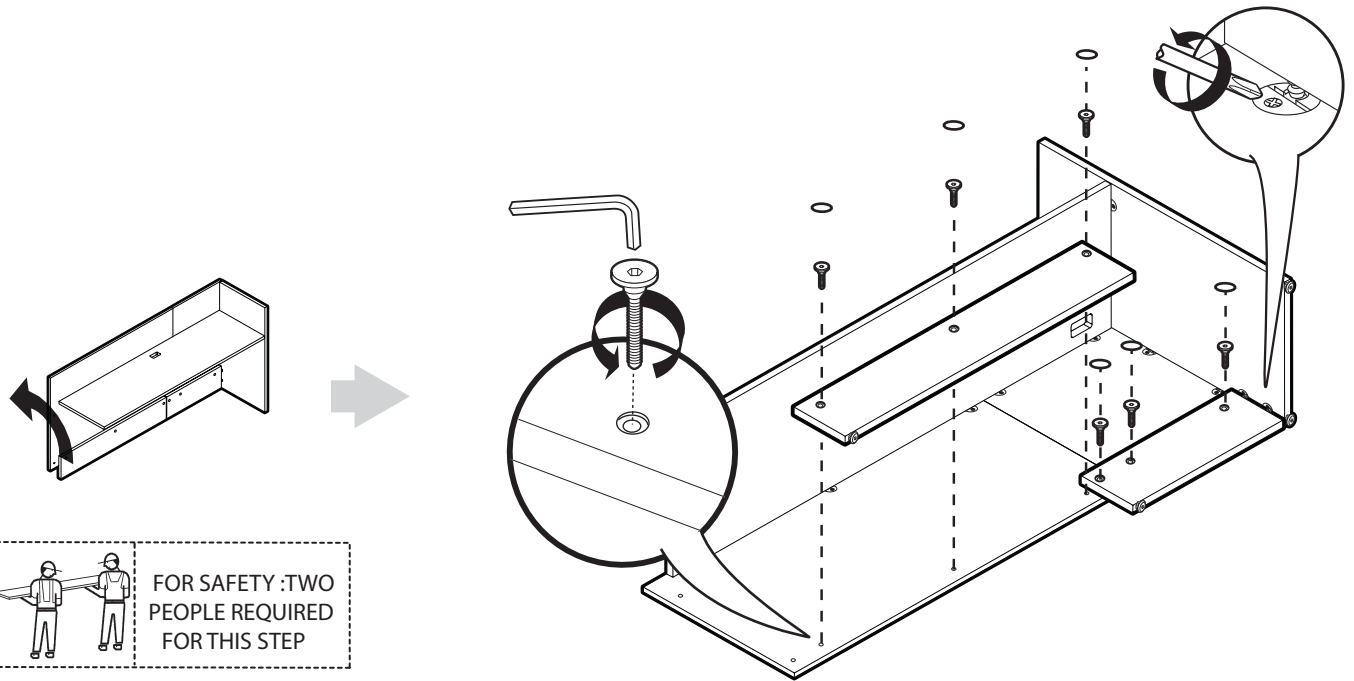

E

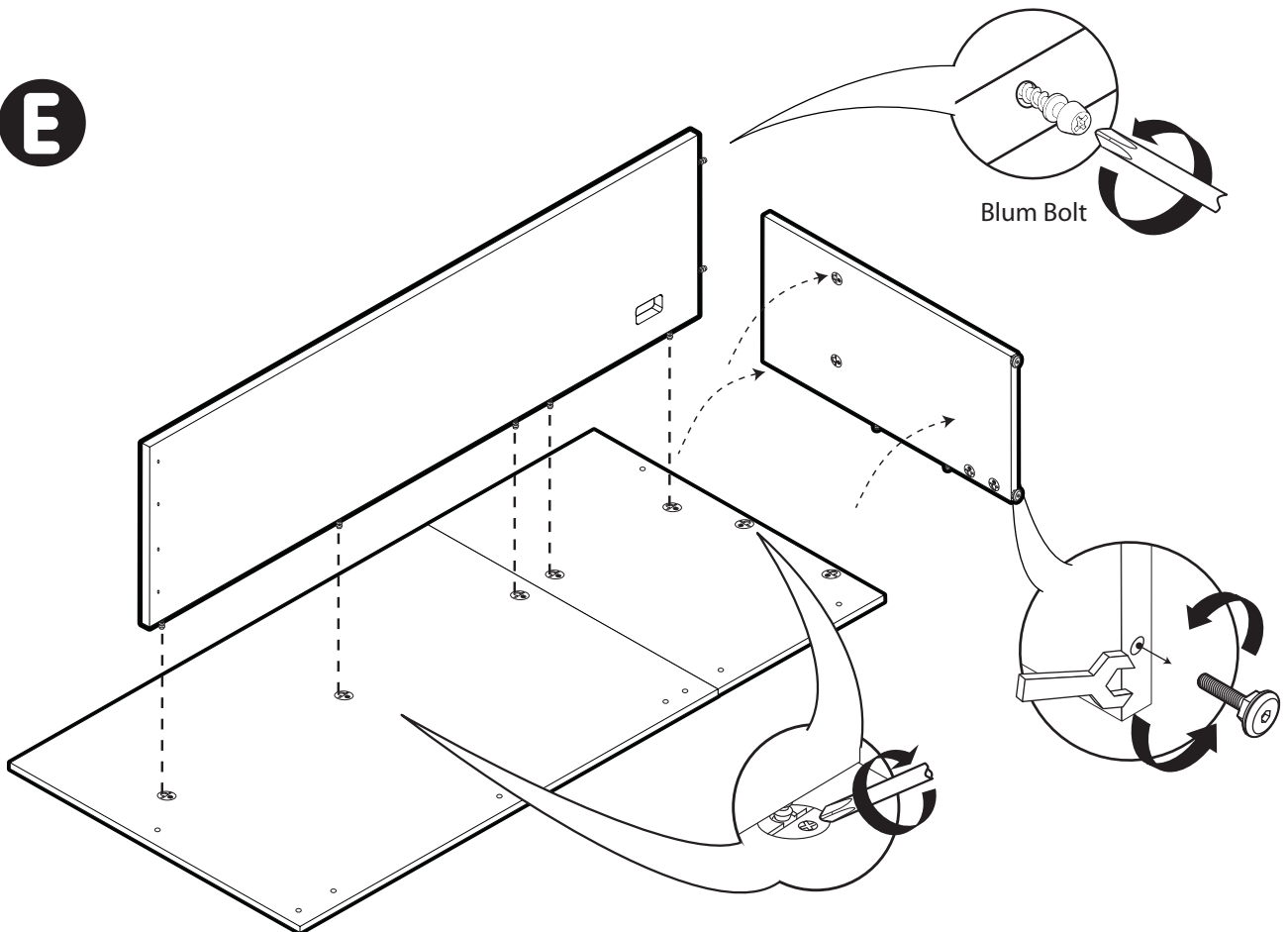

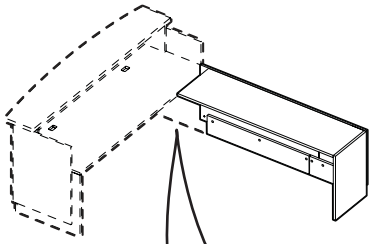
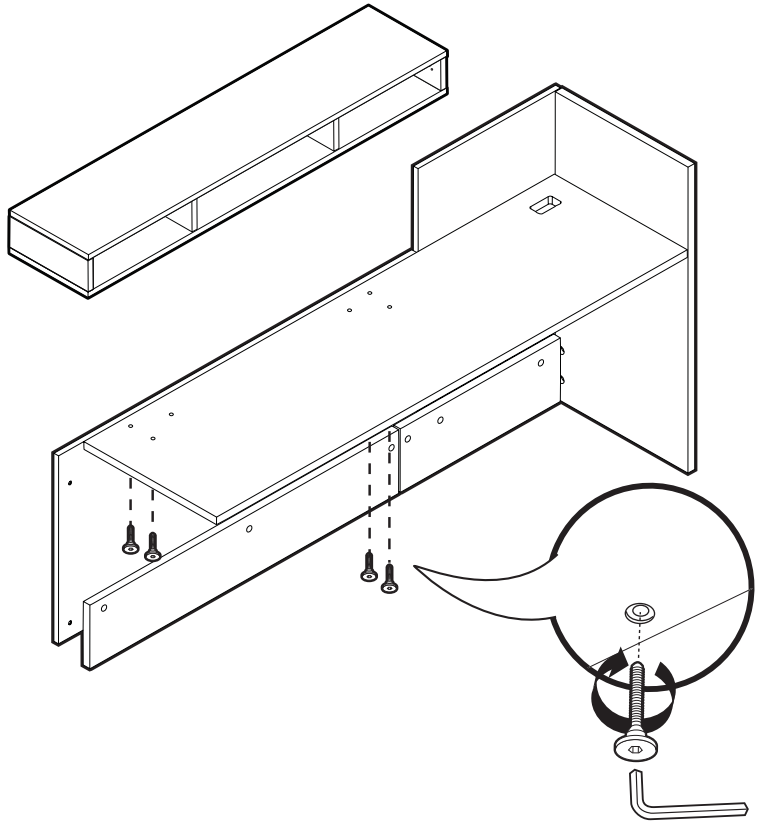
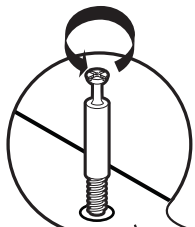
A**B****C**

MiniFi Bolt

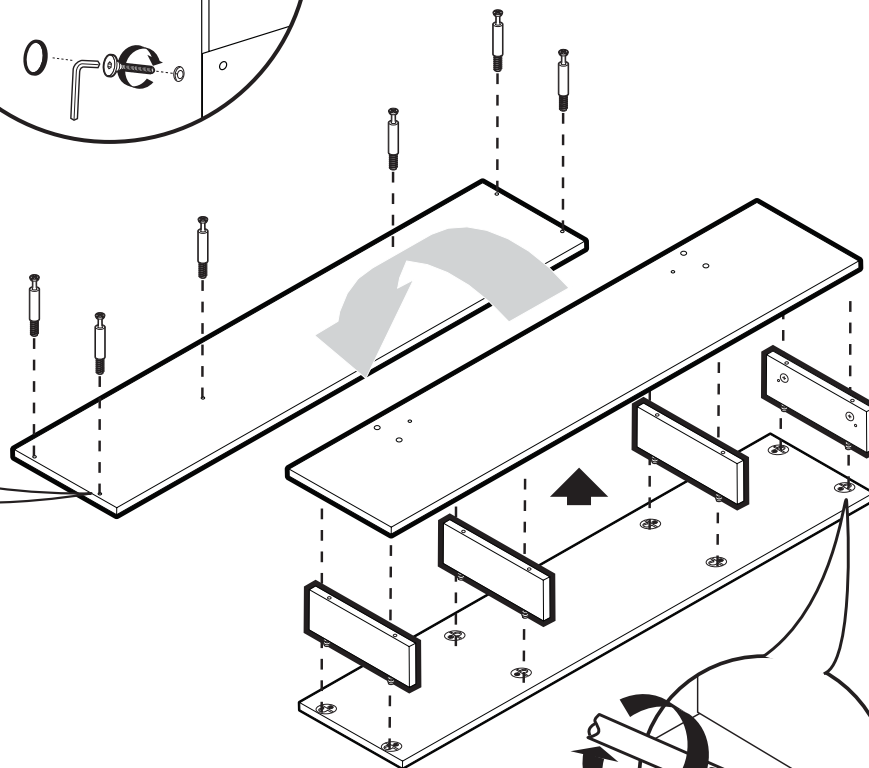

MiniFix

Blum Connector



ZIRA

Bookcase Reception Return

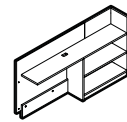

Z1260BRR L/R
Z1272BRR L/R

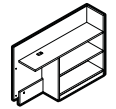

Z1236BRR L/R
Z1242BRR L/R
Z1248BRR L/R
Z1254BRR L/R

Disassembly Instructions

TOOLS REQUIRED



WRENCH
Size #16 or 5/8"

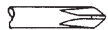

PHILLIPS
Screwdriver size #2

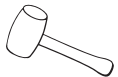

Rubber Mallet



Safety Glasses



ALLEN KEY
Size #5

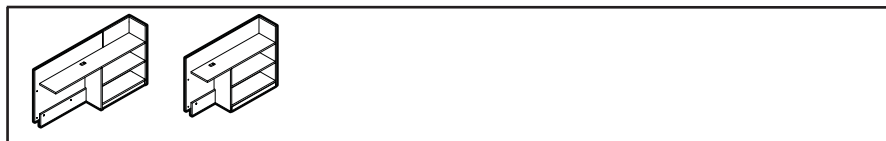
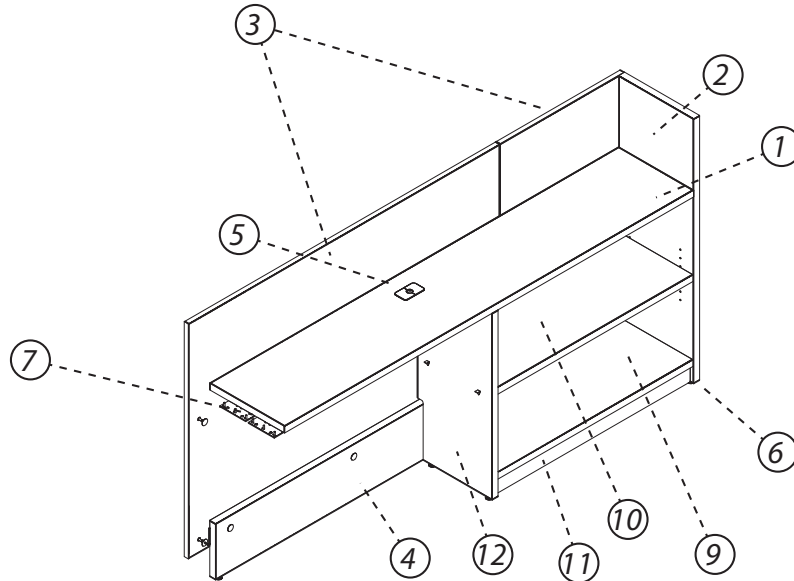

ITEM	DESCRIPTION	QUANTITIES						MATERIAL
1	TOP	1	1					PARTICLEBOARD
2	GABLE	1	1					PARTICLEBOARD
3	MODESTY PANEL	2	1					PARTICLEBOARD
4	KICKBASE	2	1					PARTICLEBOARD
5	GROMMET	1	1					PLASTIC
6	LEVELER	6	6					STEEL/PLASTIC
7	BRACKETS	2	2					STEEL
8	SCREWS/BOLTS	47	42					STEEL
9	BOTTOM	1	1					PARTICLEBOARD
10	SHELF	1	1					PARTICLEBOARD
11	SIDE	1	1					PARTICLEBOARD
12	KICKBASE BOOKCASE	1	1					PARTICLEBOARD

Please contact Global Customer Care at 905-660-5101 for any questions or concerns.

STEPS

A Unscrew and remove brackets and bolts, De-attach unit from Reception desk.

B Turn unit. Unscrew and remove Kickbase Bookcase.

C Untighten Rafx Connectors and release Shelf. Untighten Blum Connectors and release Side Panel.

D Untighten Blum Connectors. Unscrew and remove kickbase.

E Untighten Blum Connectors and release Top and Gables. Remove Blum Bolts and Levelers.

NOTE: Any alterations to listed components will void the manufacturer's warranty. The manufacturer will not be responsible for any damage or bodily harm caused by alterations in accordance with national or local electrical codes and manufacturer's specifications. In accordance with the manufacturer's policy of continual product improvement, the product presented in this document is subject to change without notice or obligation.

D

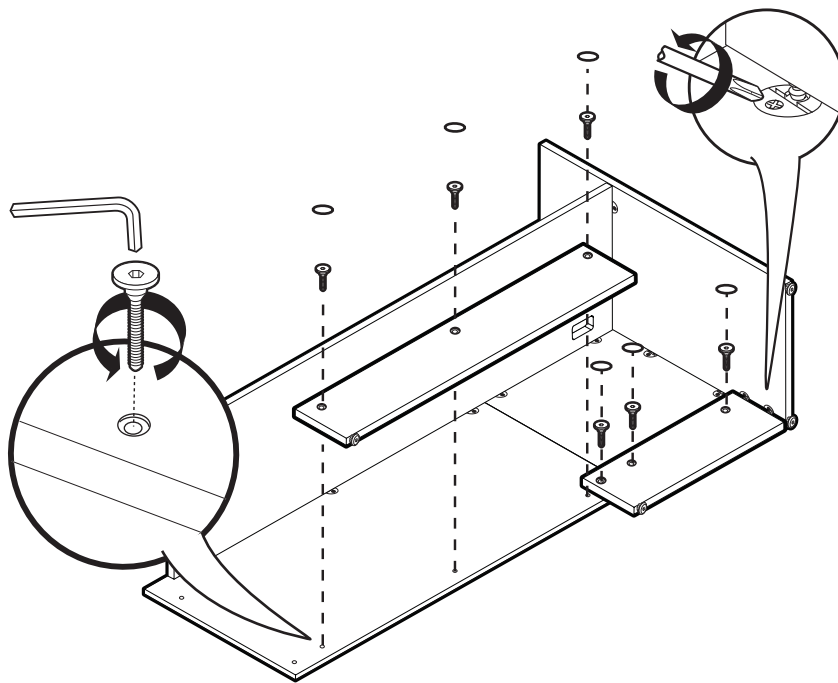

E

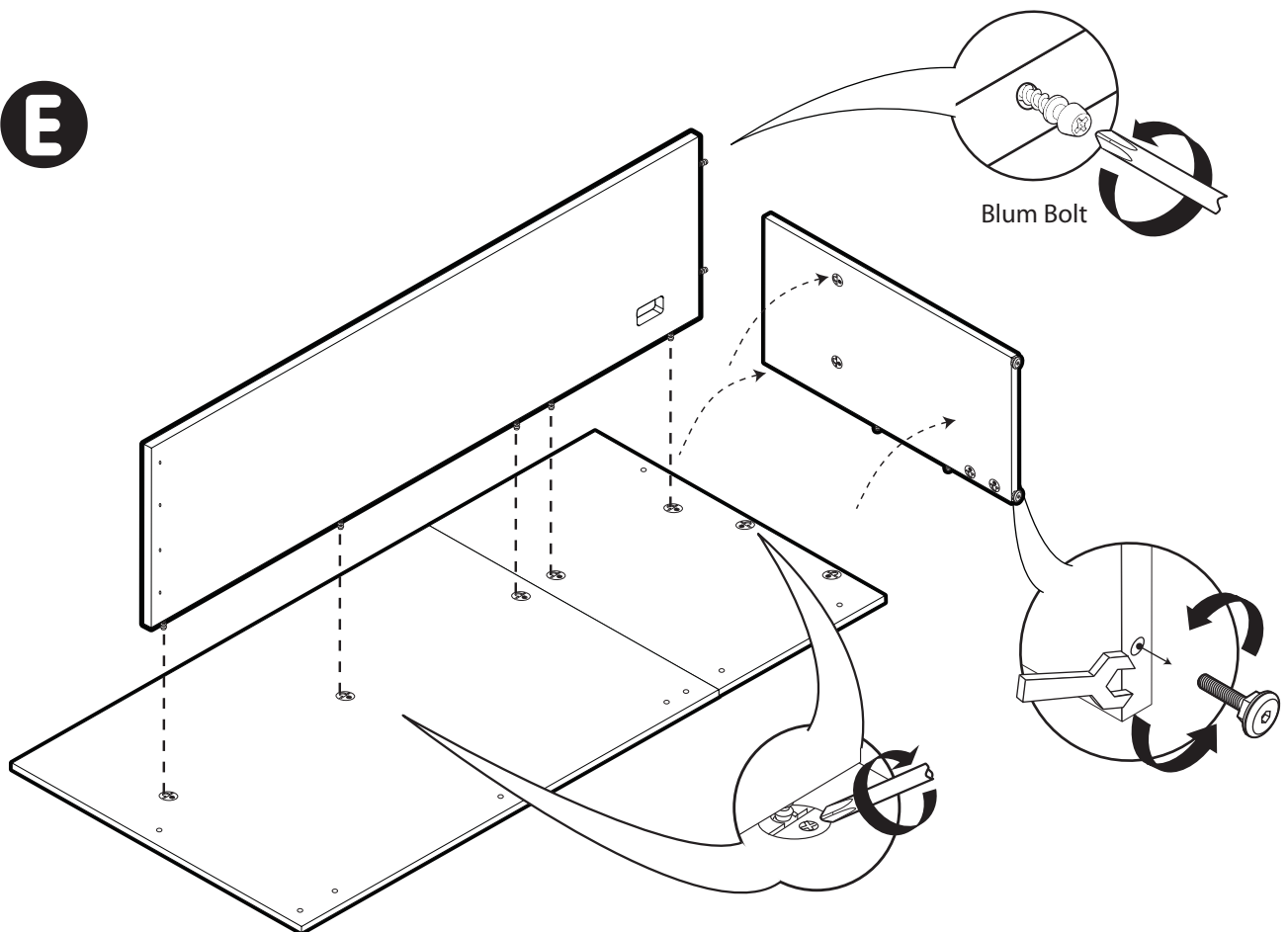

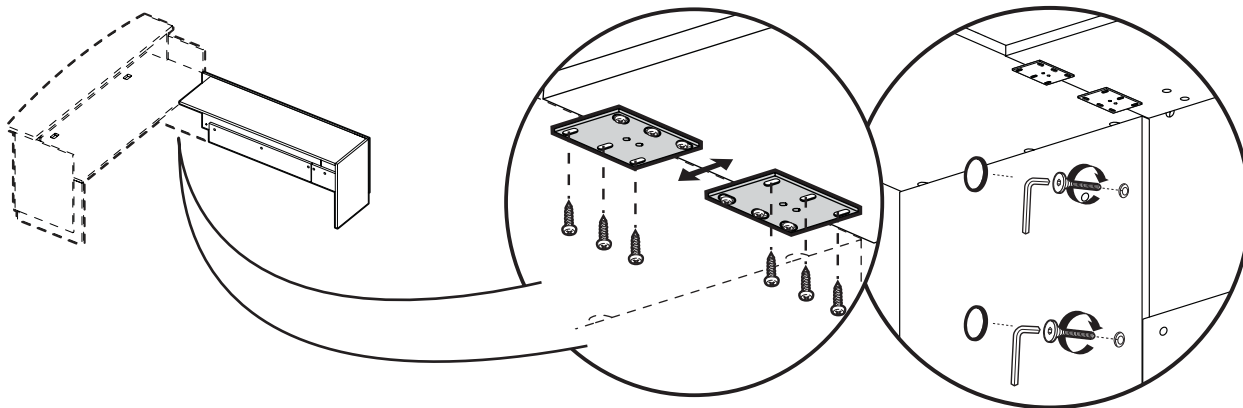
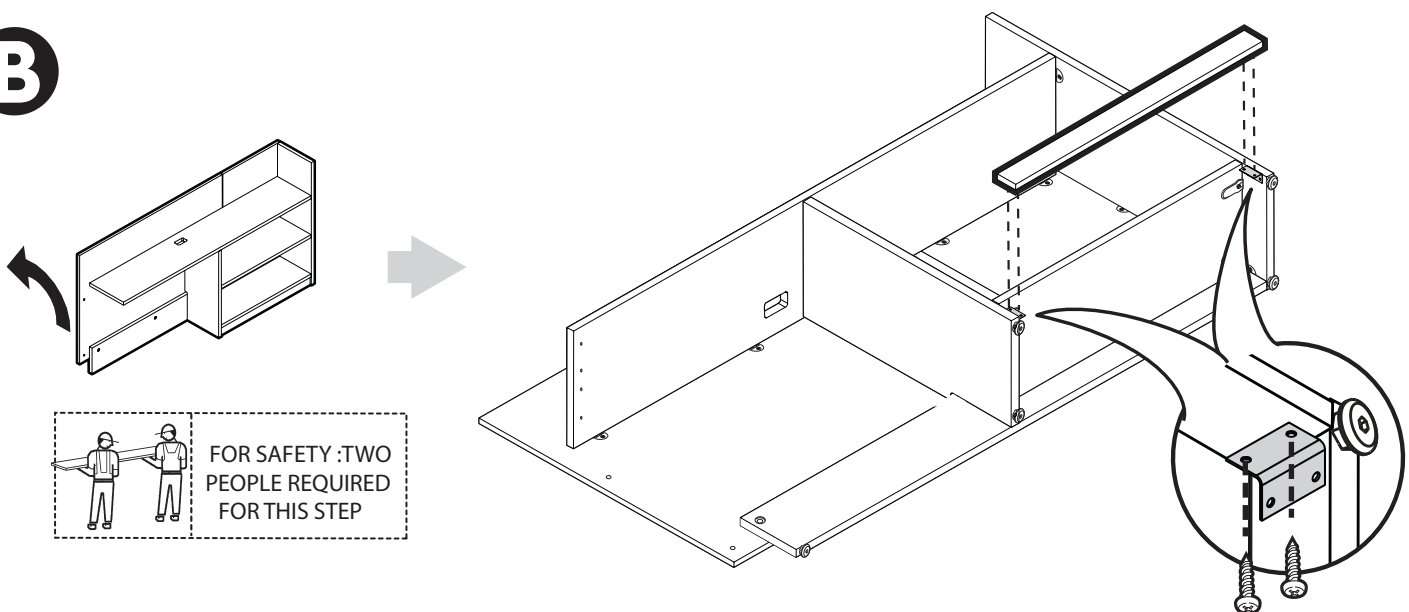
A**B****C**