

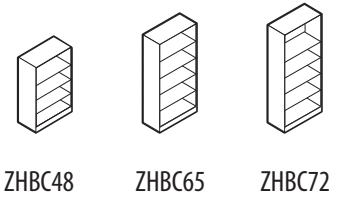

ZIRA  
Bookcases



# Disassembly Instructions

## TOOLS REQUIRED



WRENCH  
Size #16 or 5/8"

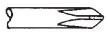

PHILLIPS  
Screwdriver size #2

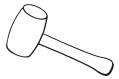

Rubber Mallet



Safety Glasses

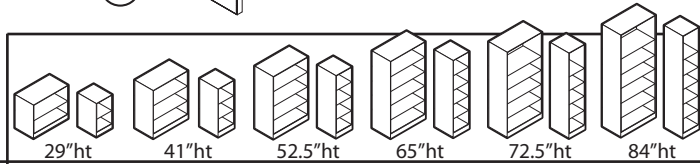
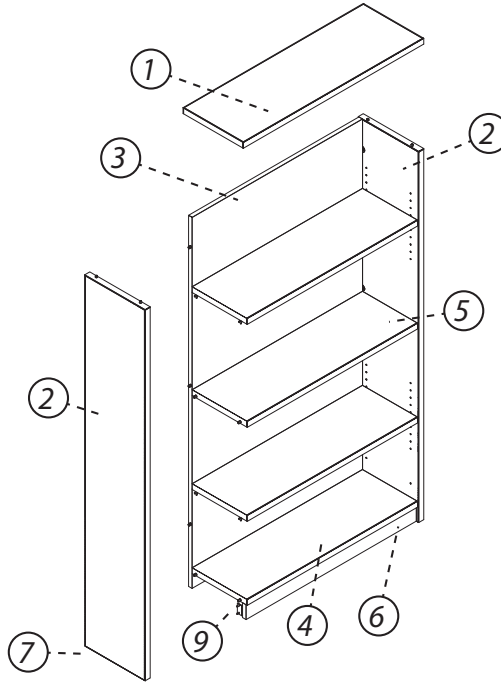

ITEM	DESCRIPTION	QUANTITIES						MATERIAL
		29"ht	41"ht	52.5"ht	65"ht	72.5"ht	84"ht	
1	TOP	1	1	1	1	1	1	PARTICLEBOARD
2	SIDE	2	2	2	2	2	2	PARTICLEBOARD
3	BACK	1	1	1	1	1	1	PARTICLEBOARD
4	BOTTOM	1	1	1	1	1	1	PARTICLEBOARD
5	SHELF	1	2	3	4	4	5	PARTICLEBOARD
6	KICKBASE	1	1	1	1	1	1	PARTICLEBOARD
7	CORNER BRACKET W/LEVELER	4	4	4	4	4	4	STEEL
8	SCREWS/BOLTS	68	73	78	81	83	94	STEEL
9	BRACKET	2	2	2	2	2	2	STEEL

## STEPS

Please contact Global Customer Care at 905-660-5101 for any questions or concerns.

- A** Remove shelves.
- B** Turn unit. Unscrew and remove kickbase. Unscrew and remove levelers.
- D** Untighten Blum connectors.
- E** Unscrew Blum Bolts.

Z<sub>DIS</sub>42 rev: 00

NOTE: Any alterations to listed components will void the manufacturer's warranty. The manufacturer will not be responsible for any damage or bodily harm caused by alterations in accordance with national or local electrical codes and manufacturer's specifications. In accordance with the manufacturer's policy of continual product improvement, the product presented in this document is subject to change without notice or obligation.

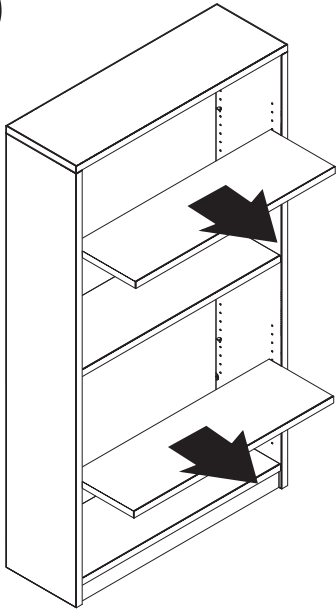
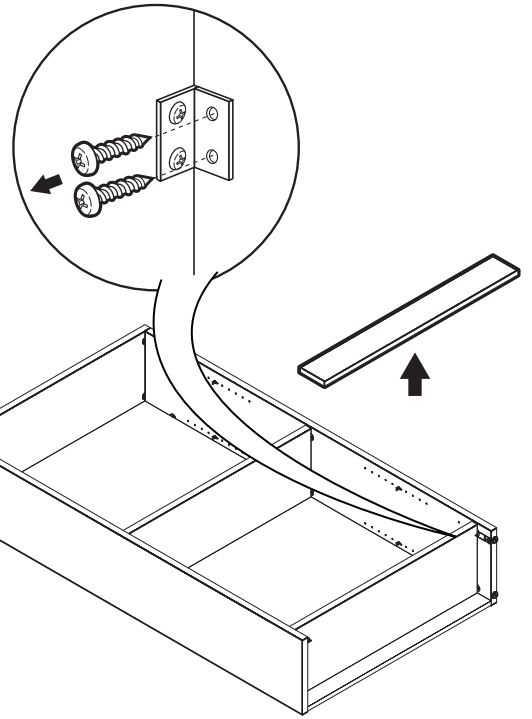
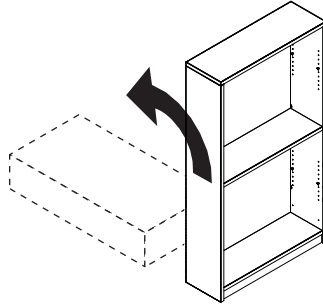
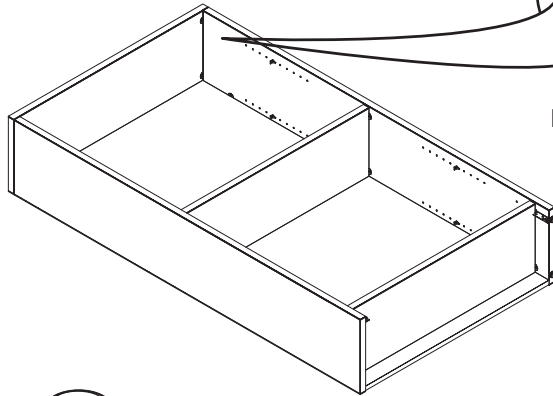
**A****B****C**

Blum Connector

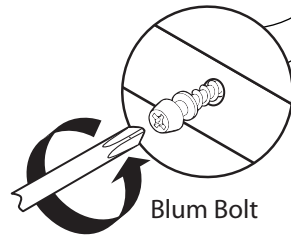
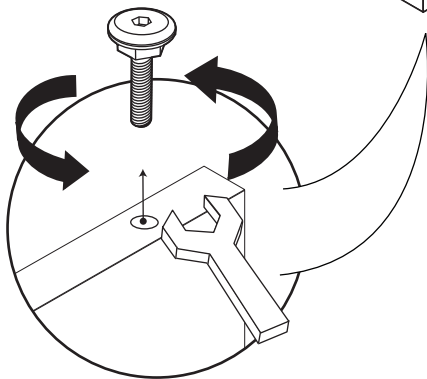
**C**

Blum Bolt



ZIRA

Table Top Book Case

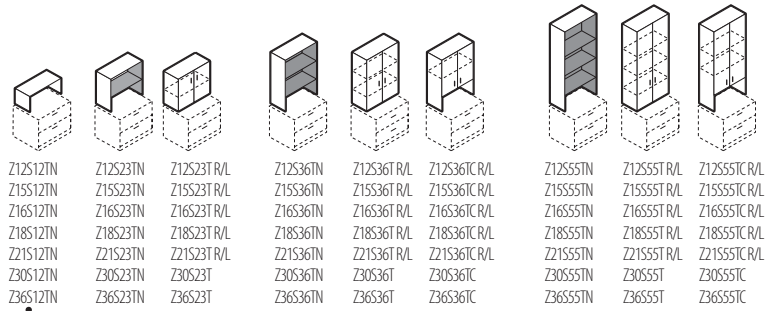

# Disassembly Instructions

## TOOLS REQUIRED



ALLEN KEY  
Size #5



PHILLIPS  
Screwdriver size #2

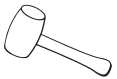

Rubber Mallet



Safety Glasses

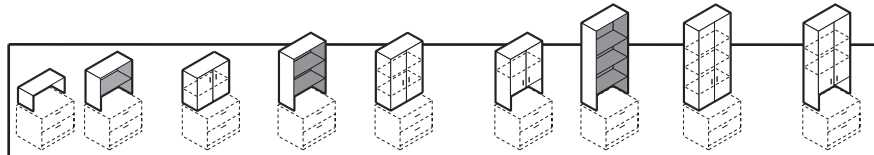
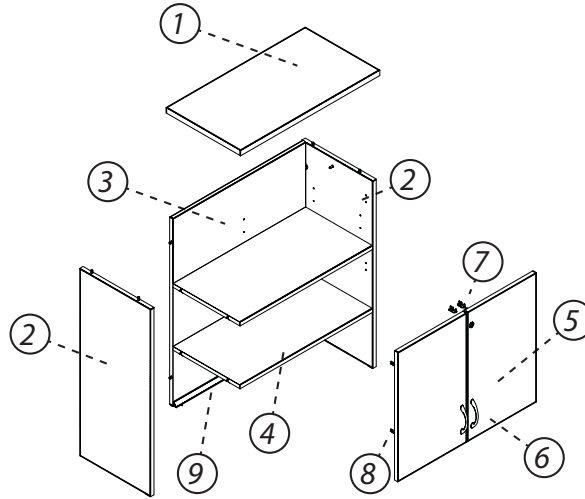

ITEM	DESCRIPTION	QUANTITIES									MATERIAL
		12"to36"w	12"to36"w	12"to21"w-30'36"w	12"to36"w	12"to21"w-30'36"w	12"to21"w-30'36"w	12"to36"w	12"to21"w-30'36"w	12"to21"w-30'36"w	
1	TOP	1	1	1	1	1	1	1	1	1	PARTICLEBOARD
2	SIDE	2	2	2	2	2	2	2	2	2	PARTICLEBOARD
3	BACK	1	1	1	1	1	1	1	1	1	PARTICLEBOARD
4	SHELF		1	1	2	2	2	3	3	3	PARTICLEBOARD
5	DOOR			1 - 2		1 - 2		1 - 2		1 - 2	PARTICLEBOARD
6	HANDLES			1 - 2		1 - 2		1 - 2		1 - 2	ALUMIUM
7	DOOR LOCK MECHANISM			1		1		1		1	STEEL
8	HINGES			2 - 4		2 - 4		3 - 6		3 - 6	STEEL
9	CORNER EXTRUSION/COVER	1	1	1	1	1	1	1	1	1	PLASTIC
10	SCREWS/BOLTS	17	22	27 - 37	28	32 - 43	32 - 43	35	50	50	STEEL

Please contact Global Customer Care at 905-660-5101 for any questions or concerns.

## STEPS

- A** Pull over Corner Extrusion cover. Unscrew screws and remove Corner Extrusion.
- B** Carefully pull up table top bookcase.
- C** For units w/door: Remove door by pressing on back of hinges and pulling doors forward.

- D** For units w/door: Unscrew and remove hinges, handles and door lock mechanism from doors.
- E** Turn unit. Unscrew door stopper.
- F** Untighten Blum and Rafx Connectors.
- G** Unscrew Blum and Rafx bolts

NOTE: Any alterations to listed components will void the manufacturer's warranty. The manufacturer will not be responsible for any damage or bodily harm caused by alterations in accordance with national or local electrical codes and manufacturer's specifications. In accordance with the manufacturer's policy of continual product improvement, the product presented in this document is subject to change without notice or obligation.

Z-Dis 43 rev: 00

**A**

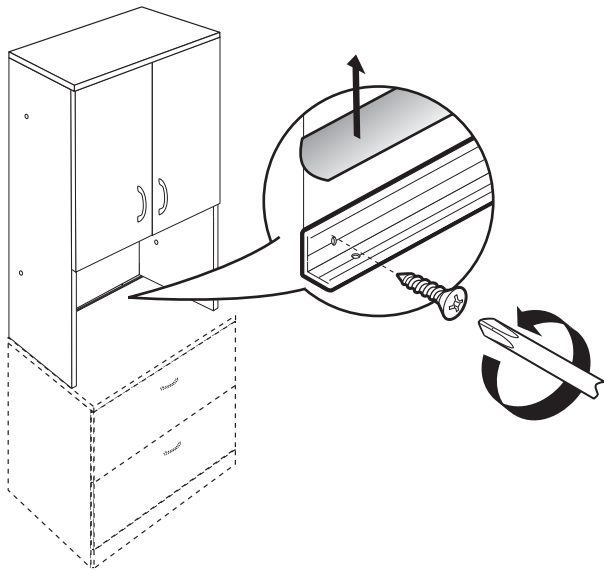

**B**

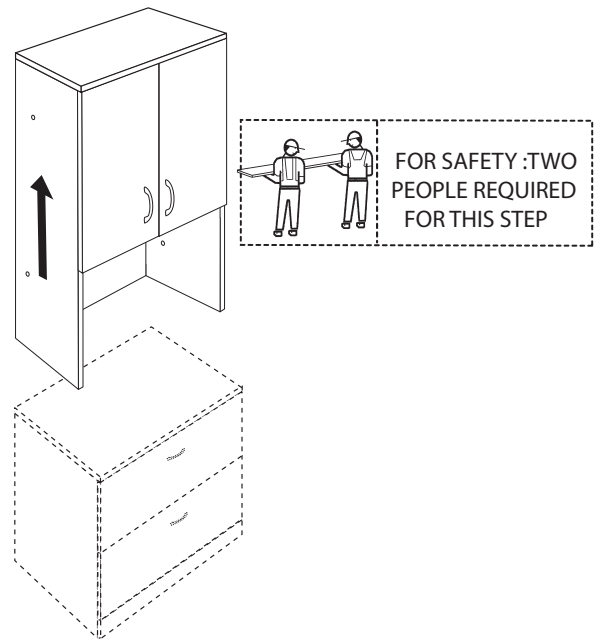

**C**

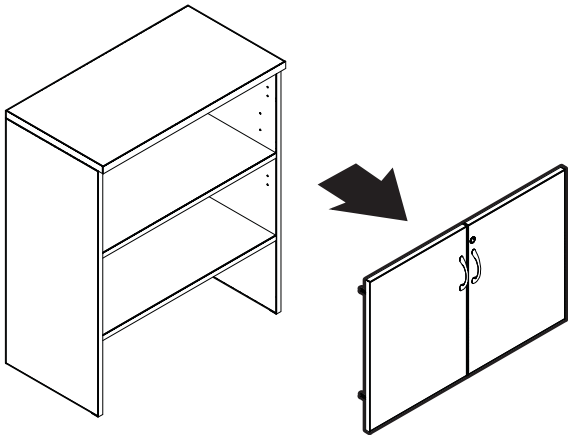

**D**

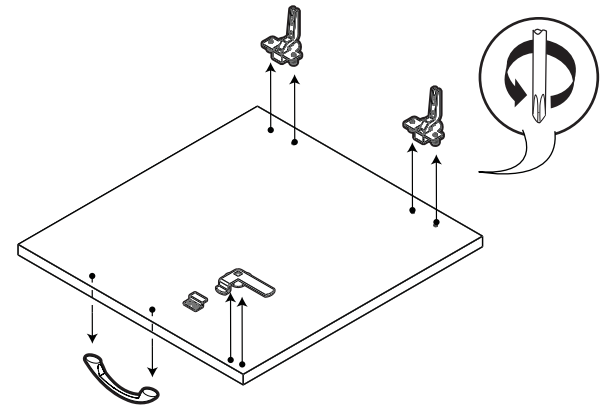

**E**

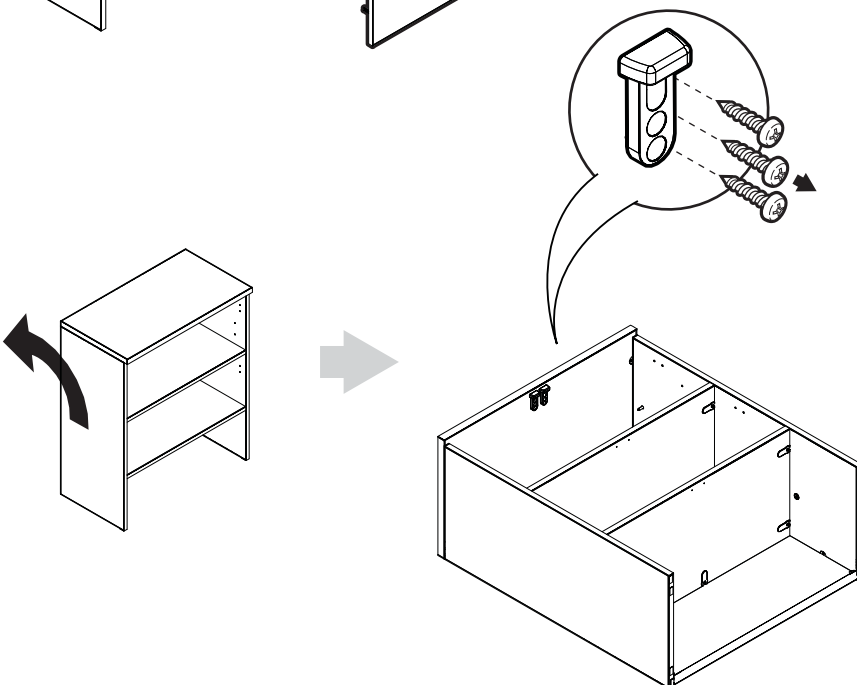

**F**

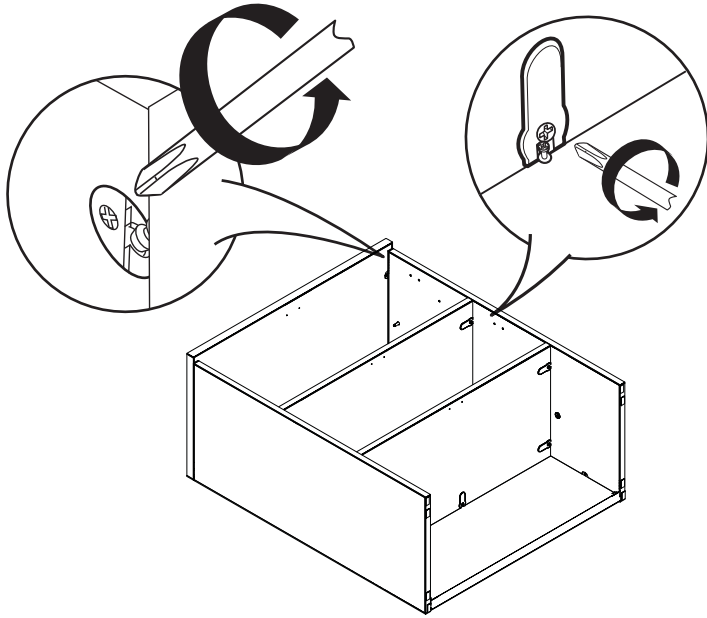

**G**

