

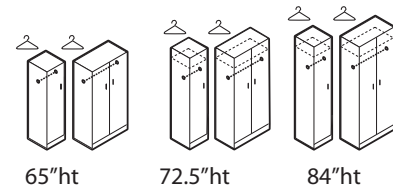

ZIRA

Wardrobe Cabinet



Z12...36L6WA L/R Z12...36L7WA L/R Z12...36L8WA L/R
Z12...36M6WA L/R Z12...36M7WA L/R Z12...36M8WA L/R

Disassembly Instructions

TOOLS REQUIRED



WRENCH
Size #16 or 5/8"



PHILLIPS
Screwdriver size #2

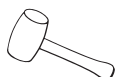

Rubber Mallet



Safety Glasses

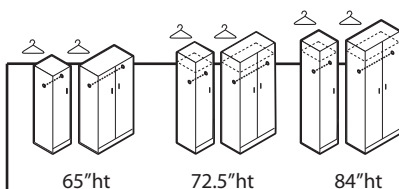
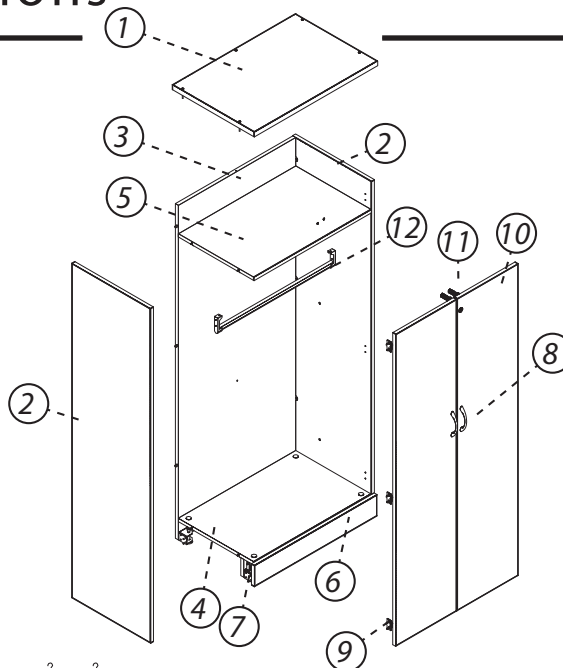

ITEM	DESCRIPTION	QUANTITIES			MATERIAL
		12"to21"w-30",36"w	12"to21"w-30",36"w	12"to21"w-30",36"w	
1	TOP	1	1	1	PARTICLEBOARD
2	SIDE	2	2	2	PARTICLEBOARD
3	BACK	1	1	1	PARTICLEBOARD
4	BOTTOM	1	1	1	PARTICLEBOARD
5	SHELF		1	1	PARTICLEBOARD
6	KICKBASE	1	1	1	PARTICLEBOARD
7	CORNER BRACKET W/LEVELER	4	4	4	STEEL
8	HANDLES	1 - 2	1 - 2	1 - 2	ALUMINIUM
9	HINGES	3 - 6	3 - 6	4 - 8	STEEL
10	DOOR	1 - 2	1 - 2	1 - 2	PARTICLEBOARD
11	DOOR LOCK MECHANISM	1	1	1	STEEL
12	HANGING ROD SYSTEM	1	1	1	STEEL/PLASTIC
13	SCREWS/BOLTS	57 - 65	61 - 70	64 - 71	STEEL

Please contact Global Customer Care at 905-660-5101 for any questions or concerns.

STEPS

- Remove door by pressing on back of hinges and pulling doors forward.
- Unscrew and remove hinges, handles and door lock mechanism from doors.
- Turn unit. Pull kickbase and unscrew kick base connector. Unscrew door stopper. Unscrew and

remove Hanging Rod System.

- Unscrew Blum and Rafx Connectors. Unscrew and remove corner brackets with leveler.
- Unscrew Blum and Rafx bolts. For units with drawers: Unscrew and remove glide channels and Drawer Lock Mechanism.

NOTE: Any alterations to listed components will void the manufacturer's warranty. The manufacturer will not be responsible for any damage or bodily harm caused by alterations in accordance with national or local electrical codes and manufacturer's specifications. In accordance with the manufacturer's policy of continual product improvement, the product presented in this document is subject to change without notice or obligation.

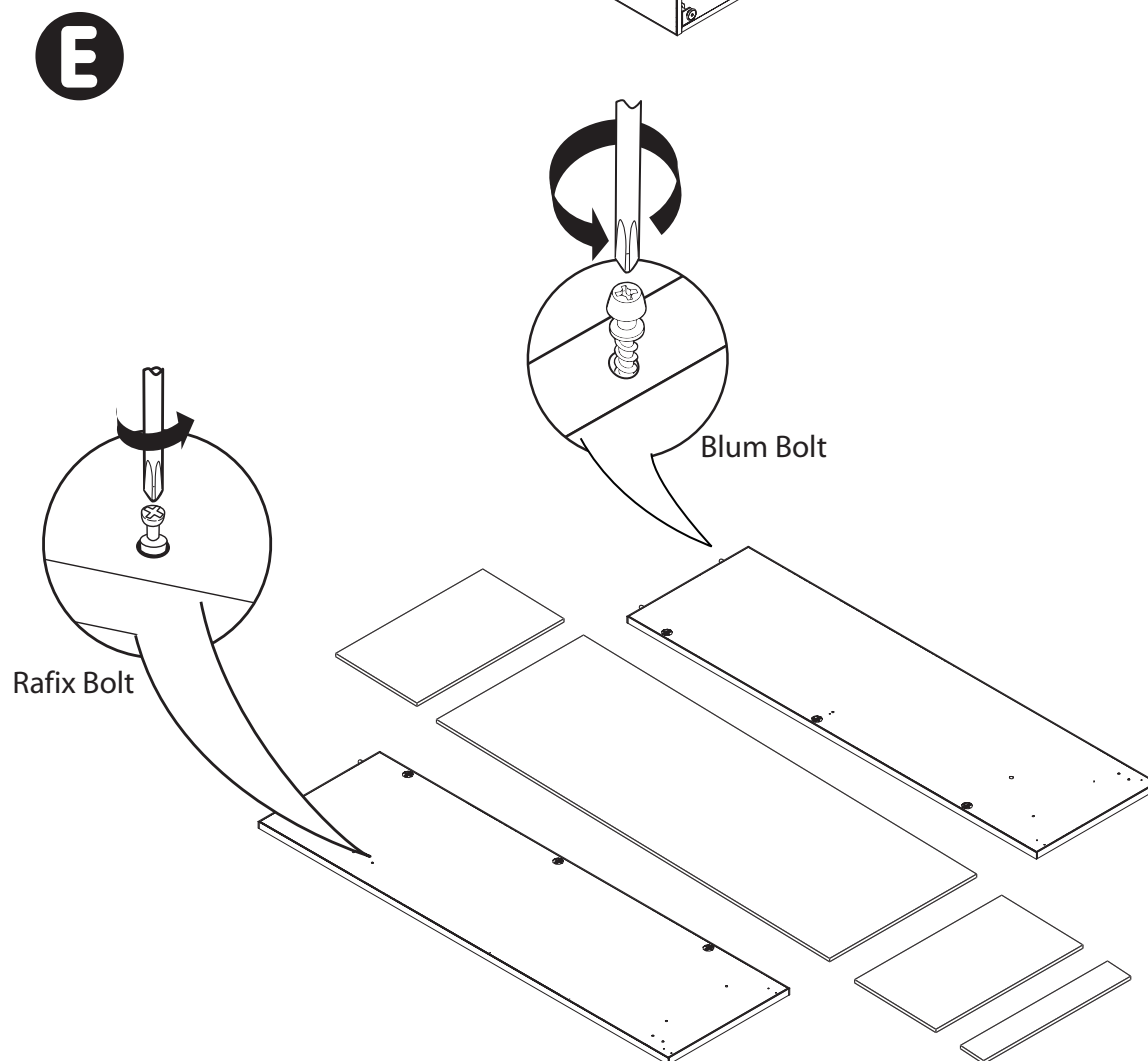
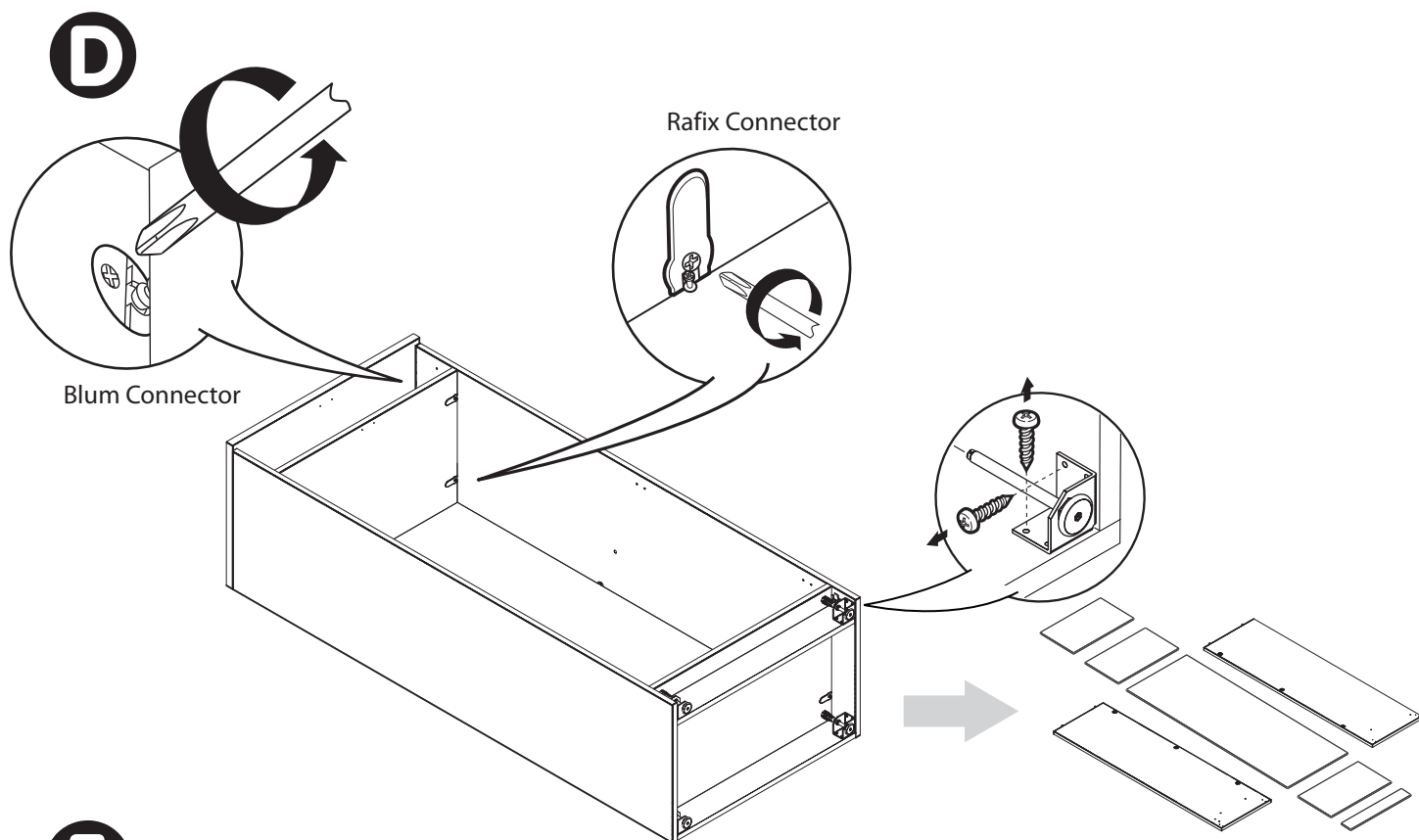

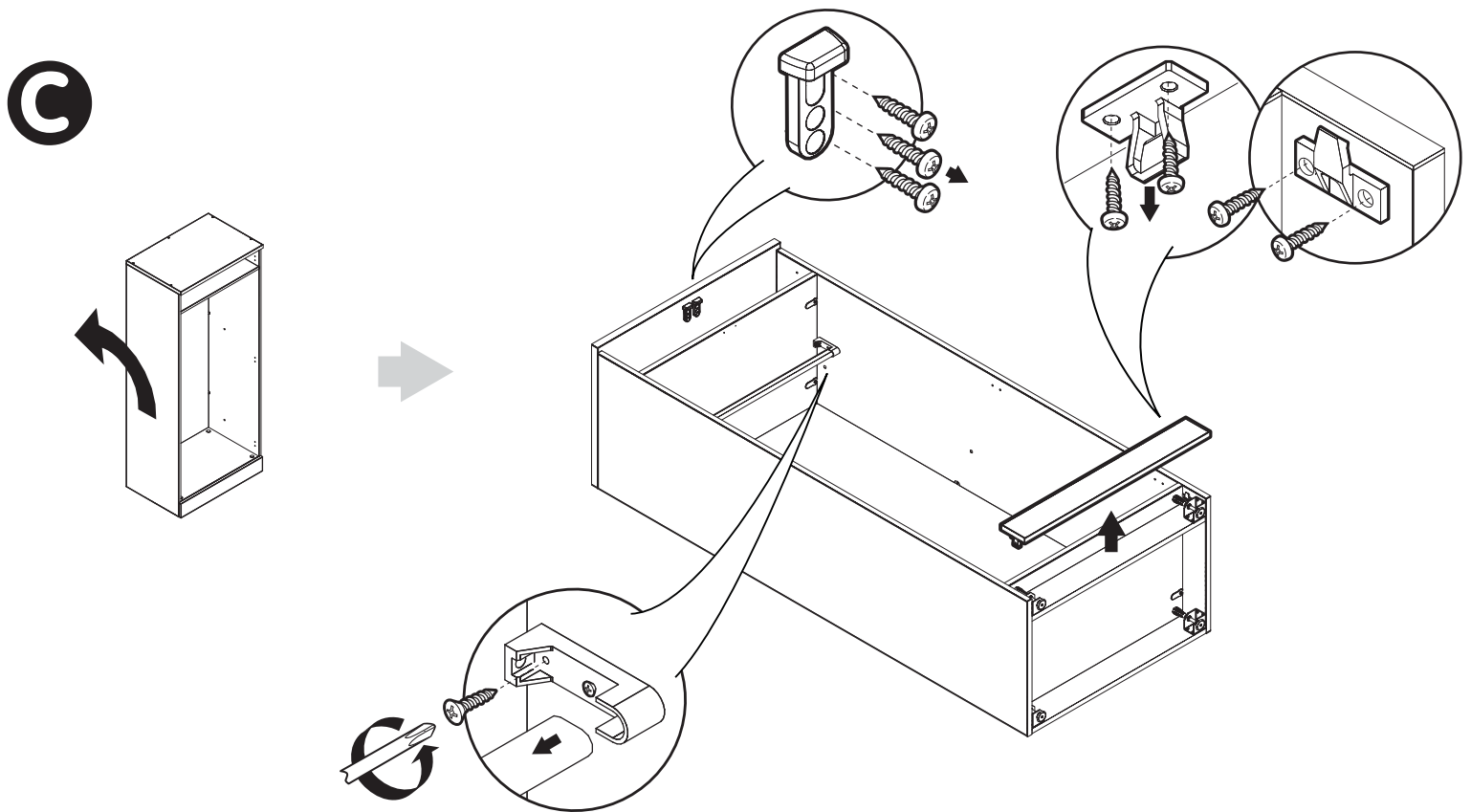
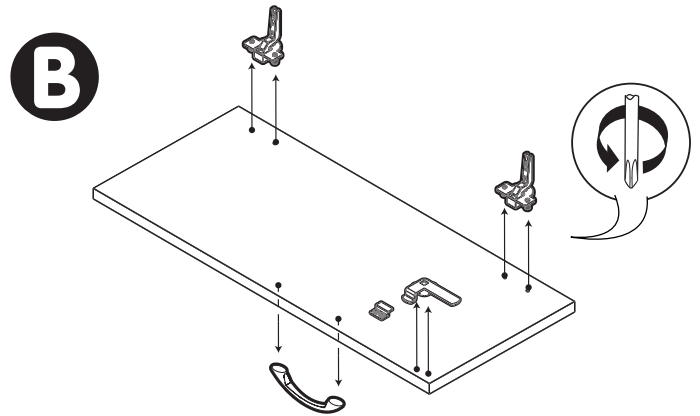
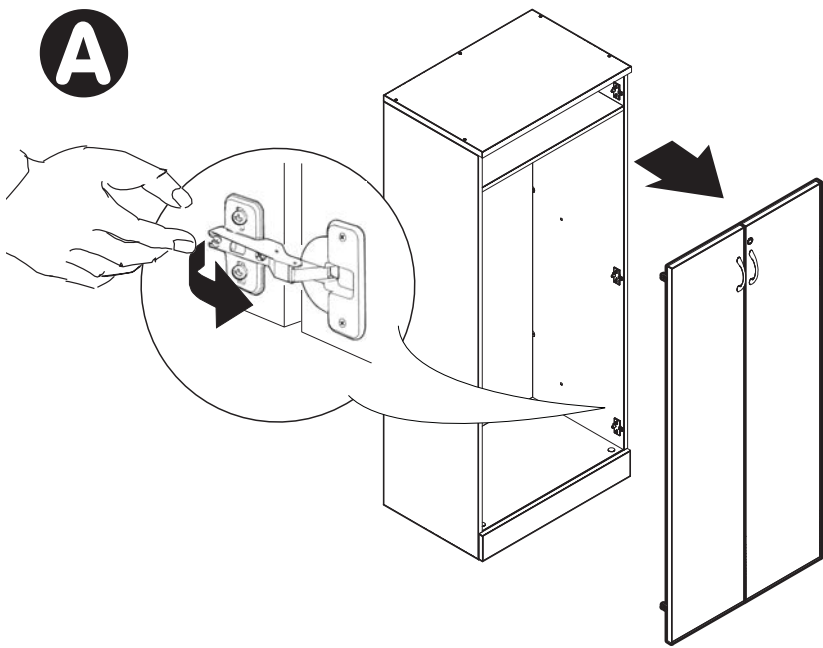



ZIRA

Wardrobe Cabinet/Open Shelving
Wardrobe Cabinet/Shelving with Doors

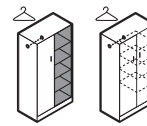

65"ht

Z21...36L6DIN L/R Z21...36L6DI L/R
Z21...36M6DIN L/R Z21...36M6DI L/R

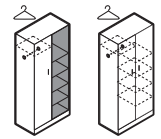

72.5"ht

Z21...36L7DIN L/R Z21...36L7DI L/R
Z21...36M7DIN L/R Z21...36M7DI L/R

Disassembly Instructions

TOOLS REQUIRED



WRENCH

Size #16 or 5/8"

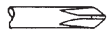

PHILLIPS

Screwdriver size #2

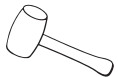

Rubber Mallet



Safety Glasses

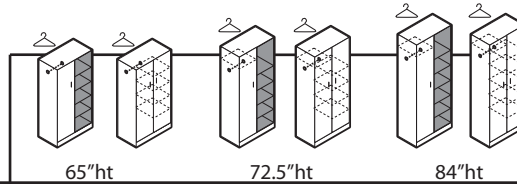
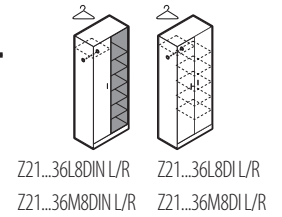
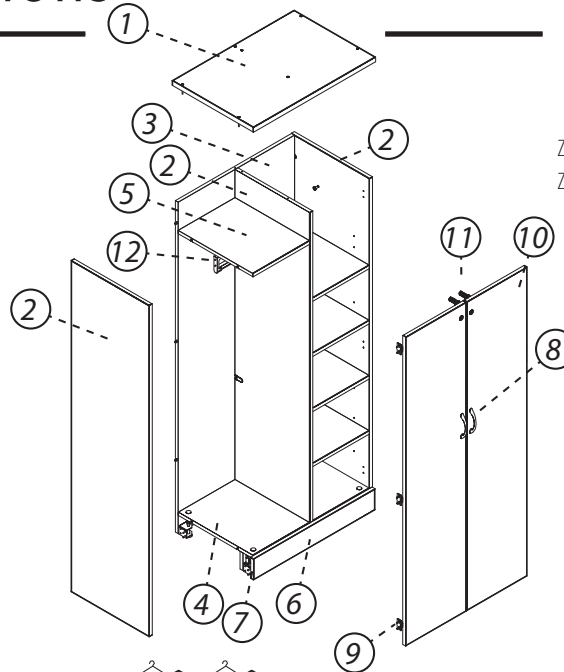

ITEM	DESCRIPTION	QUANTITIES							MATERIAL
		65" ht		72.5" ht		84" ht			
1	TOP	1	1	1	1	1	1		PARTICLEBOARD
2	SIDE AND MIDDLE	4	3	3	3	3	3		PARTICLEBOARD
3	BACK	1	1	1	1	1	1		PARTICLEBOARD
4	BOTTOM	1	1	1	1	1	1		PARTICLEBOARD
5	SHELF	4	4	5	5	6	6		PARTICLEBOARD
6	KICKBASE	1	1	1	1	1	1		PARTICLEBOARD
7	CORNER BRACKET W/LEVELER	4	4	4	4	4	4		STEEL
8	HANDLES	1	2	1	2	1	2		ALUMINIUM
9	HINGES	3	6	3	6	3	6		STEEL
10	DOOR	1	2	1	2	1	2		PARTICLEBOARD
11	DOOR LOCK MECHANISM	1	1	1	1	1	1		STEEL
12	HANGING ROD SYSTEM	1	1	1	1	1	1		STEEL/PLASTIC
13	SCREWS/BOLTS	80	1	84		92			STEEL

Please contact Global Customer Care at 905-660-5101 for any questions or concerns.

STEPS

- Remove door by pressing on back of hinges and pulling doors forward.
- Unscrew and remove hinges, handles and door lock mechanism from doors.
- Turn unit. Pull kickbase and unscrew kick base connector. Unscrew door stopper. Unscrew and

remove Hanging Rod System.

D Untighten Blum and Rafx Connectors. Unscrew and remove corner brackets with leveler.

E Unscrew Blum and Rafx bolts. For units with drawers: Unscrew and remove glide channels and Drawer Lock Mechanism.

NOTE: Any alterations to listed components will void the manufacturer's warranty. The manufacturer will not be responsible for any damage or bodily harm caused by alterations in accordance with national or local electrical codes and manufacturer's specifications. In accordance with the manufacturer's policy of continual product improvement, the product presented in this document is subject to change without notice or obligation.

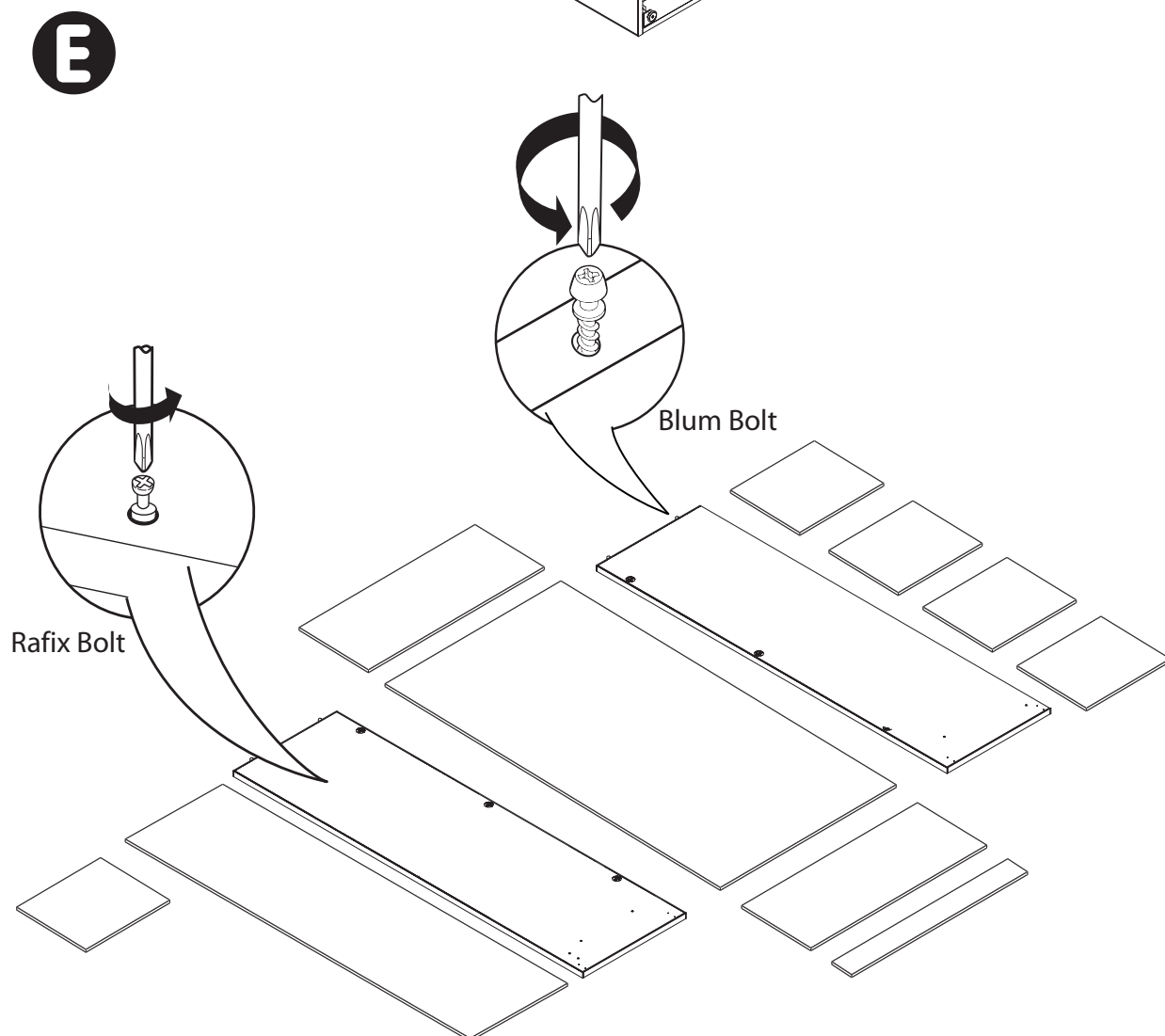
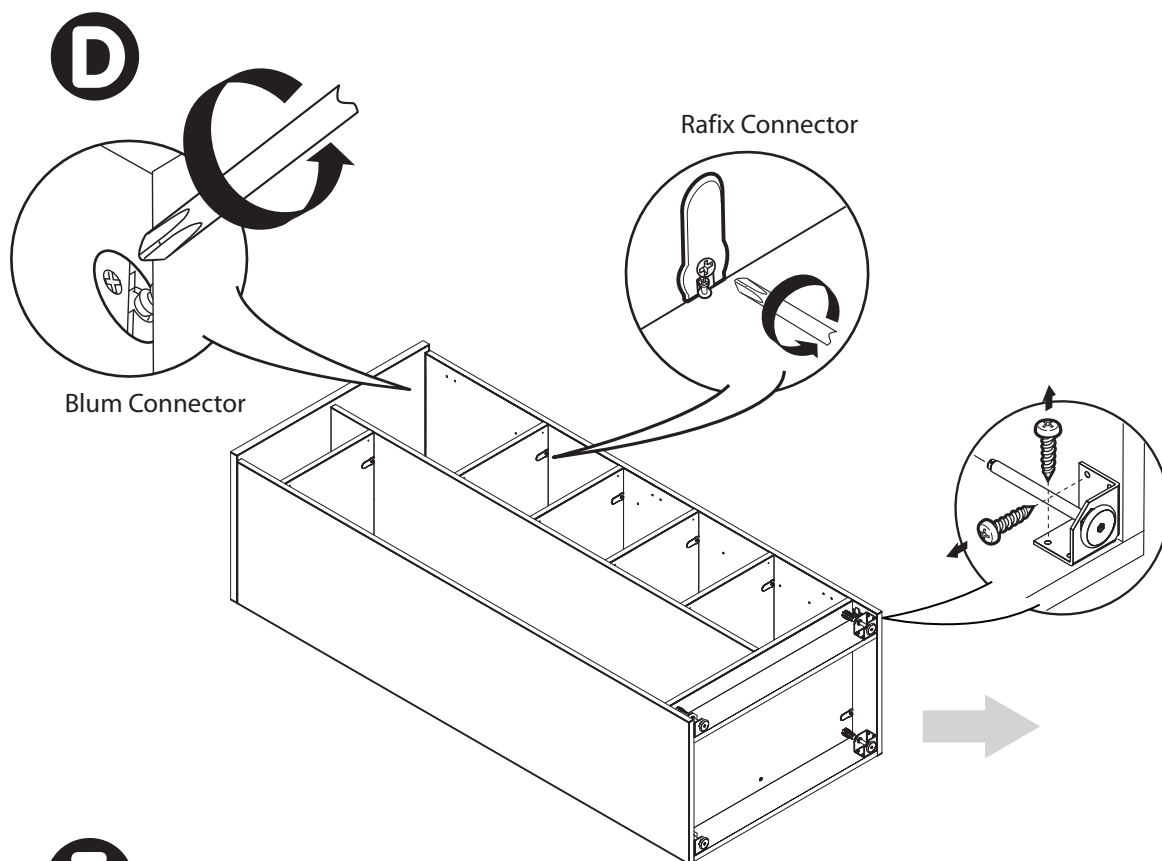

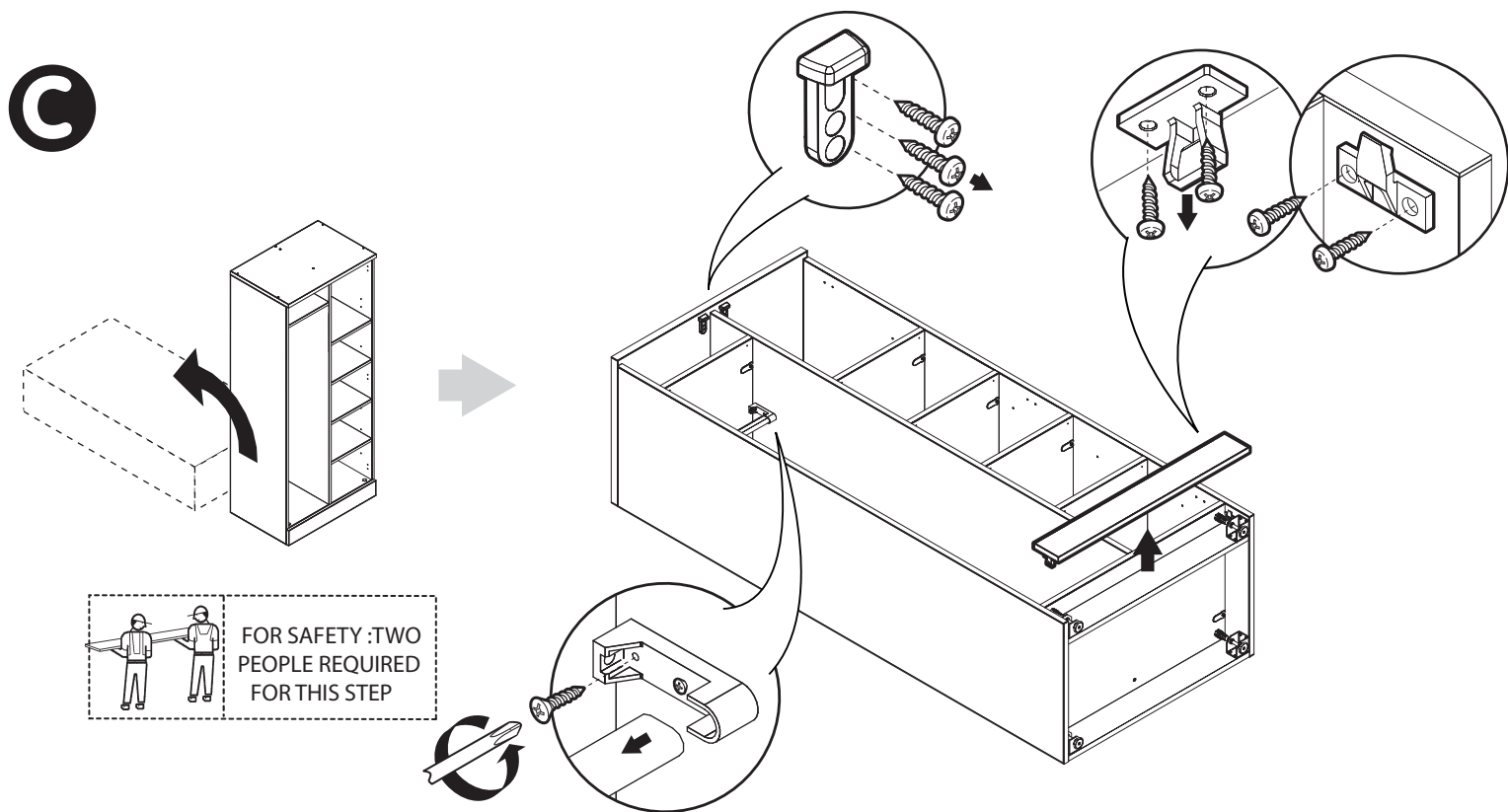
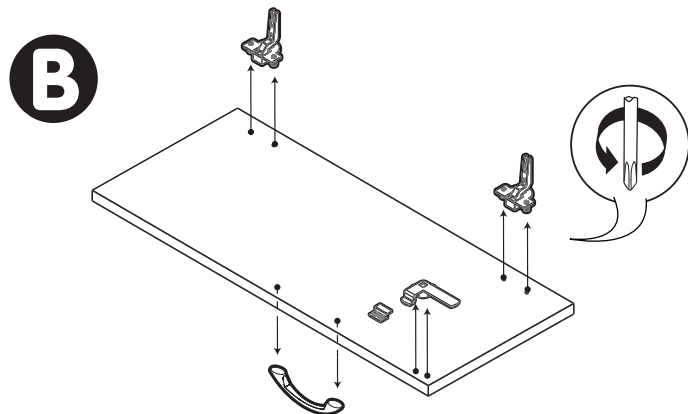
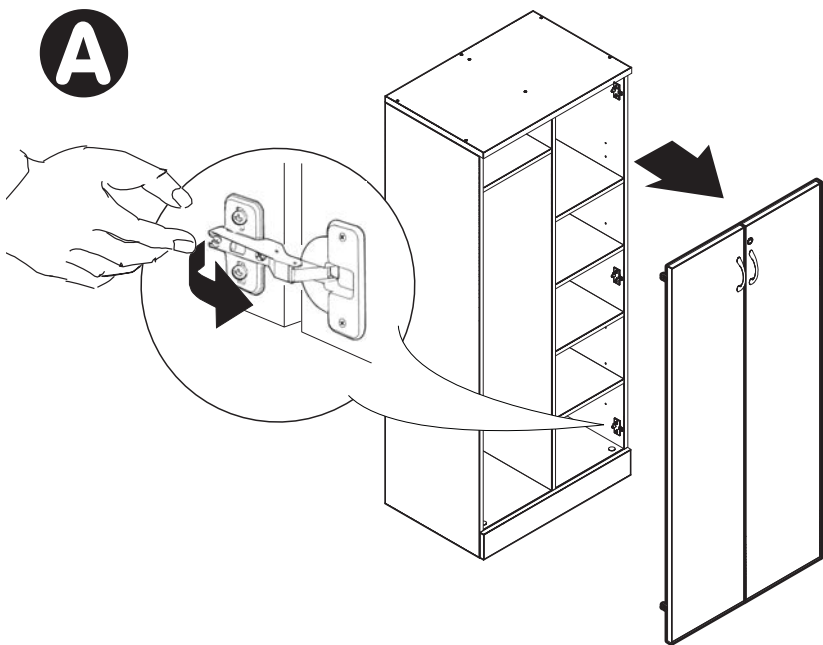



ZIRA

Personal Towers - Closed

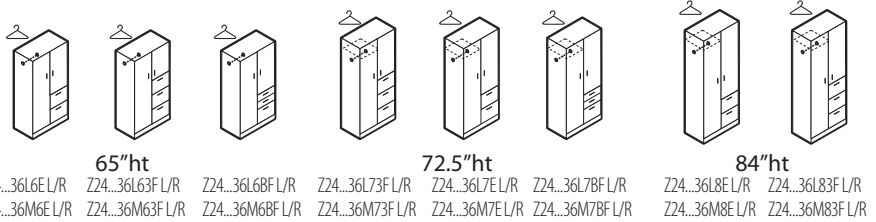

Disassembly Instructions

TOOLS REQUIRED



WRENCH
Size #16 or 5/8"

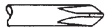

PHILLIPS
Screwdriver size #2

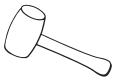

Rubber Mallet



Safety Glasses

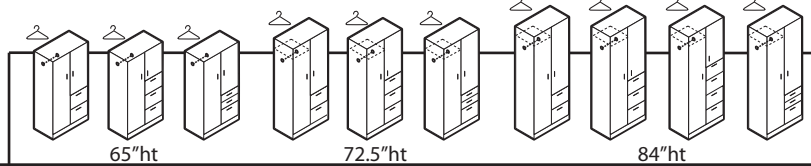
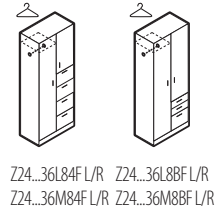
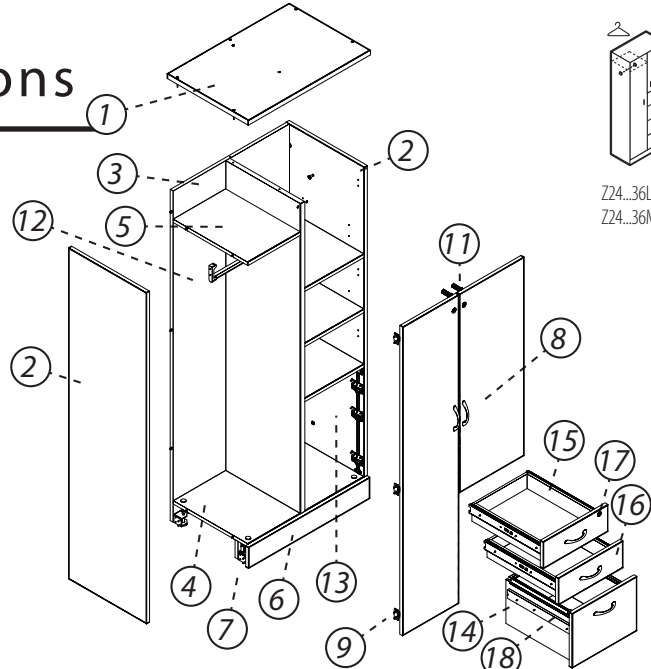

ITEM	DESCRIPTION	QUANTITIES										MATERIAL
		65"ht	65"ht	65"ht	65"ht	72.5"ht	72.5"ht	72.5"ht	72.5"ht	84"ht	84"ht	
1	TOP	1	1	1	1	1	1	1	1	1	1	PARTICLEBOARD
2	SIDE AND MIDDLE	3	3	3	3	3	3	3	3	3	3	PARTICLEBOARD
3	BACK	1	1	1	1	1	1	1	1	1	1	PARTICLEBOARD
4	BOTTOM	1	1	1	1	1	1	1	1	1	1	PARTICLEBOARD
5	SHELF	3	2	3	4	3	4	5	4	3	5	PARTICLEBOARD
6	KICKBASE	1	1	1	1	1	1	1	1	1	1	PARTICLEBOARD
7	CORNER BRACKET W/LEVELER	4	4	4	4	4	4	4	4	4	4	STEEL
8	HANDLES	4	5	5	4	5	5	4	5	6	5	ALUMINIUM
9	HINGES	6	5	6	5	5	5	6	6	6	7	STEEL
10	DOOR	2	2	2	2	2	2	2	2	2	2	PARTICLEBOARD
11	DOOR LOCK MECHANISM	2	2	2	2	2	2	2	2	2	2	STEEL
12	HANGING ROD SYSTEM	1	1	1	1	1	1	1	1	1	1	STEEL/PLASTIC
13	SLIDES (BASE PLATE)	4	6	6	4	6	6	4	6	8	6	STEEL
14	SLIDES (INNER)	4	6	6	4	6	6	4	6	8	6	STEEL
15	DRAWER	2	3	3	2	3	3	2	3	4	3	MDF
16	DRAWER FRONT	2	3	3	2	3	3	2	3	4	3	PARTICLEBOARD
17	DRAWER LOCK MECHANISM	1	1	1	1	1	1	1	1	1	1	STEEL
18	HANGING FILE SYSTEM	1	1	1	1	1	1	1	1	1	1	STEEL/PLASTIC
19	SCREWS/BOLTS	138	157	161	120	161	165	142	169	188	170	STEEL

Please contact Global Customer Care at 905-660-5101 for any questions or concerns.

STEPS

- Remove door by pressing on back of hinges and pulling doors forward.
- Unscrew and remove hinges, handles and door lock mechanism from doors.
- Remove Drawers by Fully Extending and Disengaging latch on each slide while pulling drawer out. Remove door by pressing on back of hinges and pulling doors forward.
- On Drawer boxes, unscrew and remove slide channels, handles and door lock mechanism. Remove hanging file

system.

- Turn unit. Pull kickbase and unscrew kick base connector. Unscrew door stopper. Unscrew and remove Hanging rod system.
- Untighten Blum and Rafx Connectors. Unscrew and remove corner brackets with leveler.
- Unscrew Blum and Rafx bolts. Unscrew and remove glide channels and Drawer Lock Mechanism.

NOTE: Any alterations to listed components will void the manufacturer's warranty. The manufacturer will not be responsible for any damage or bodily harm caused by alterations in accordance with national or local electrical codes and manufacturer's specifications. In accordance with the manufacturer's policy of continual product improvement, the product presented in this document is subject to change without notice or obligation.

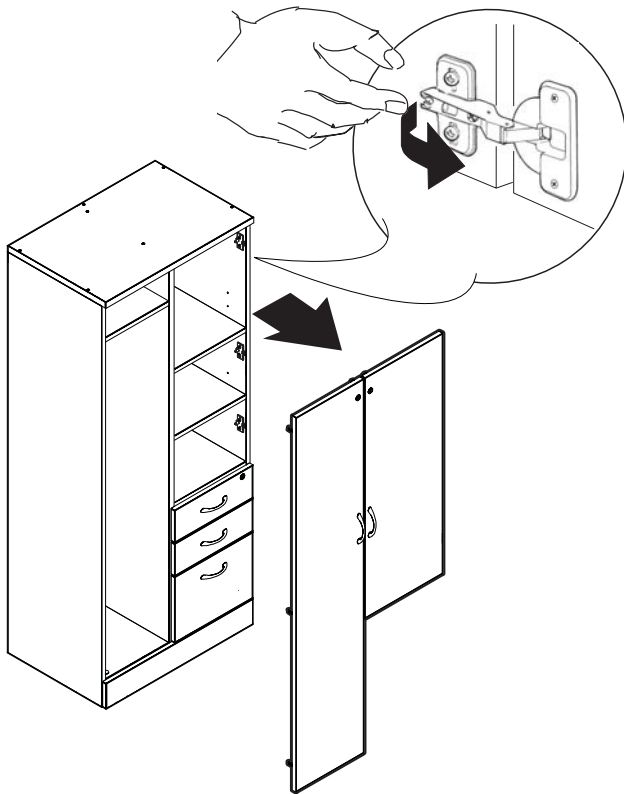
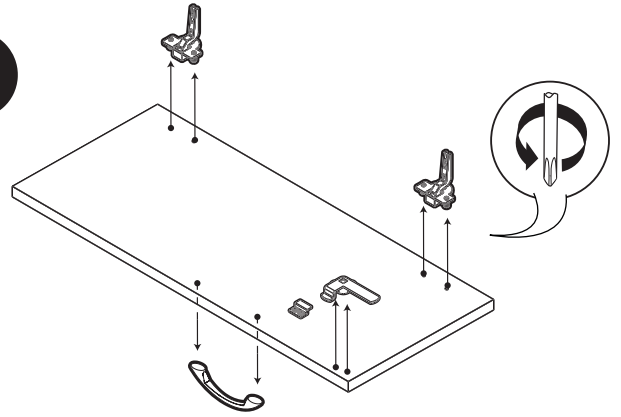
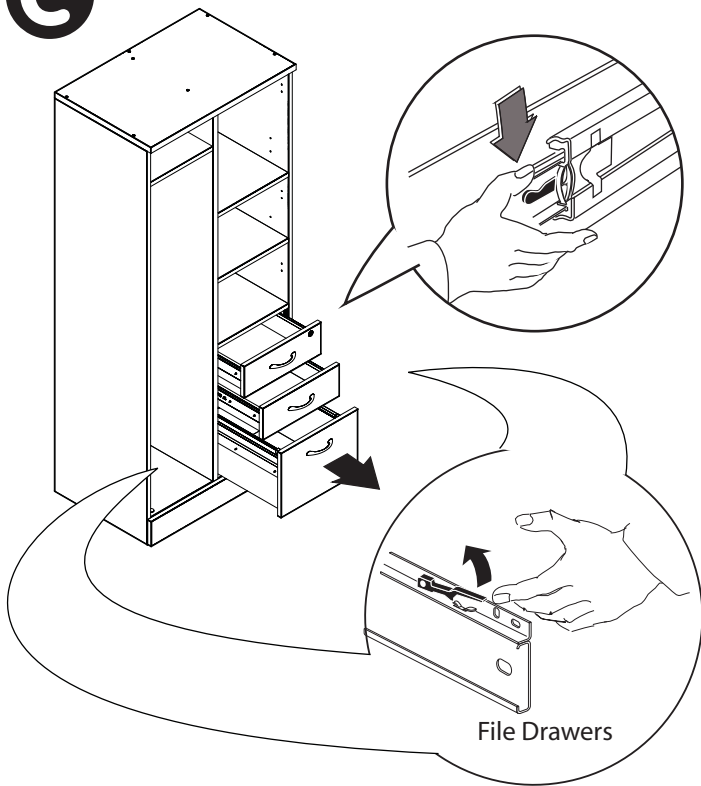
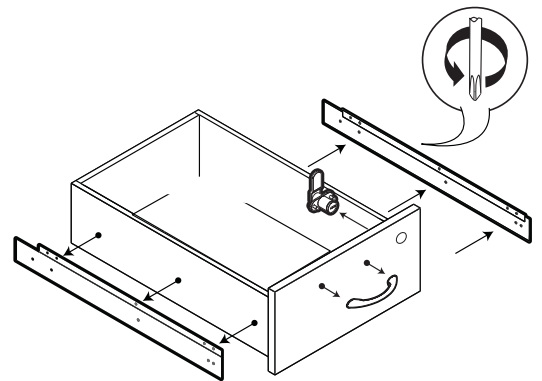
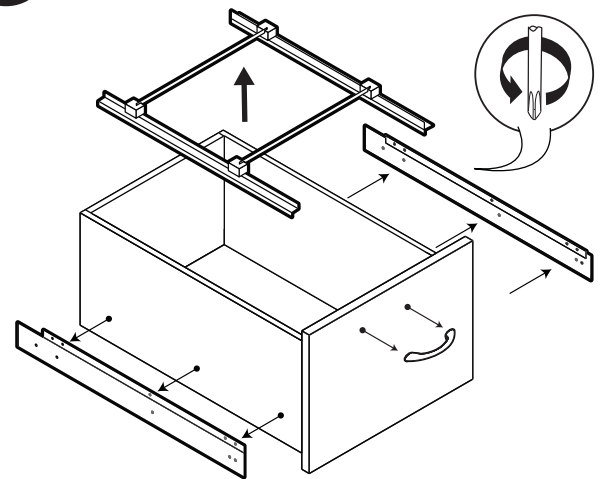
A**B****C****D****B**

E

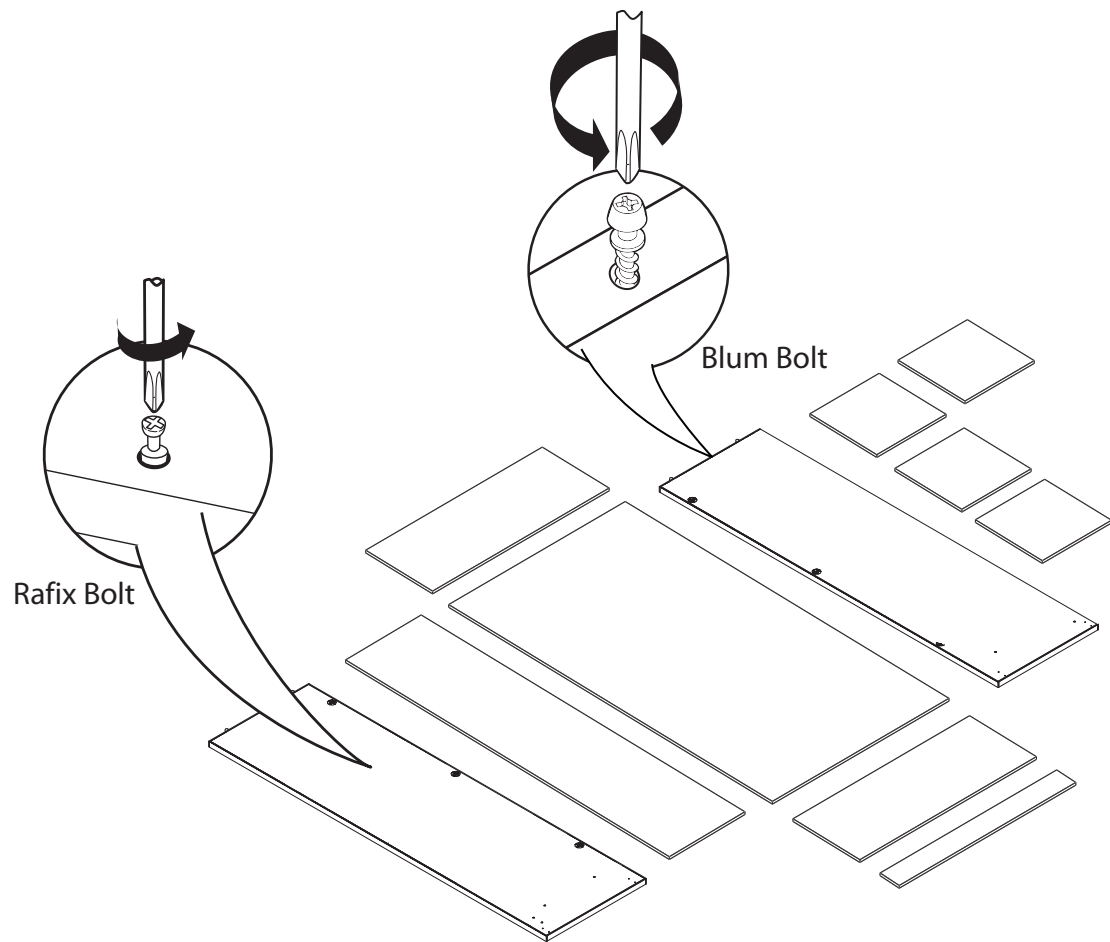

E

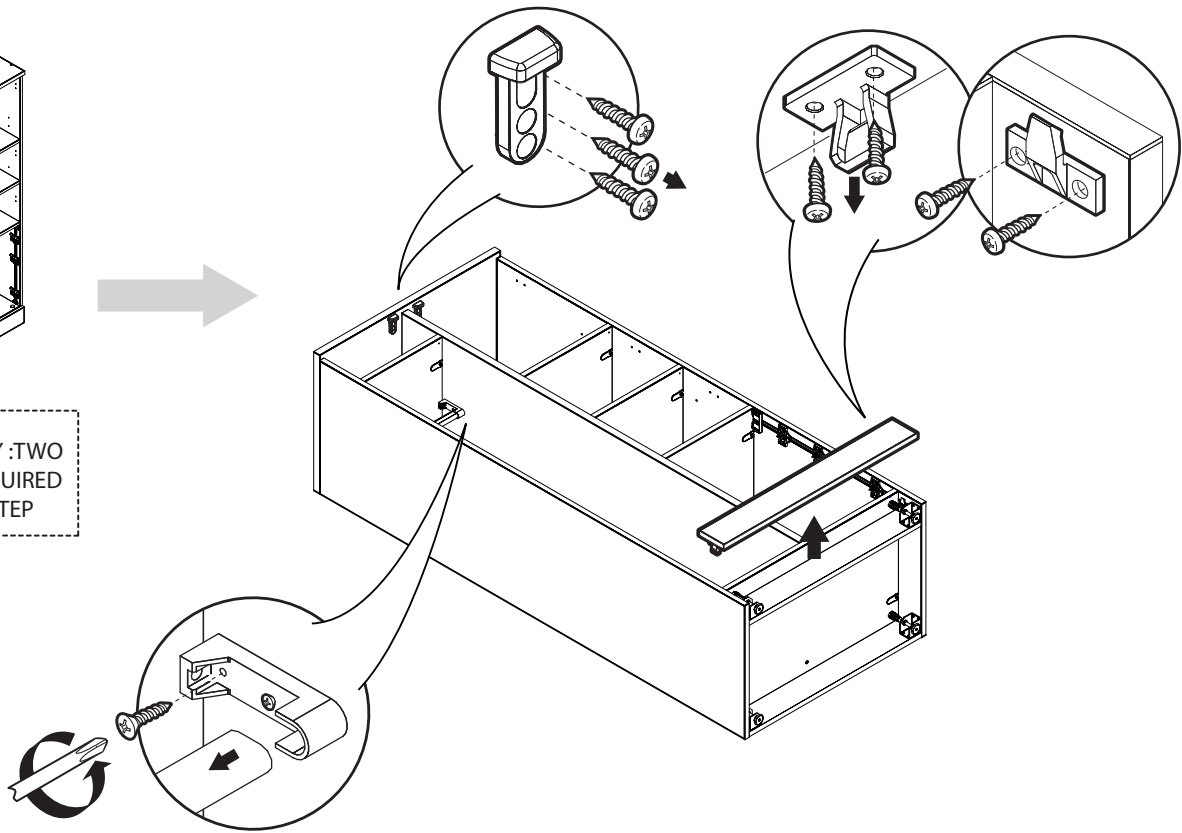
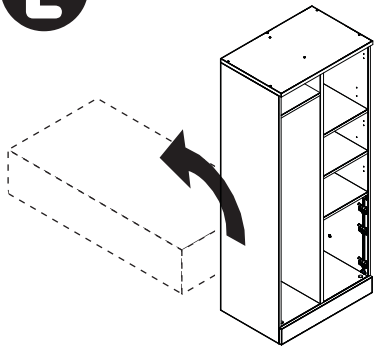

F

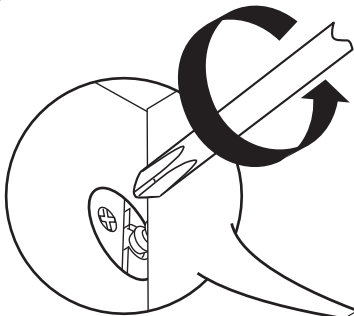

Blum Connector

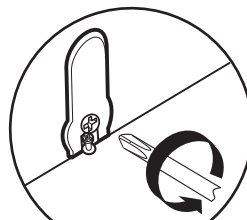

Rafix Connector

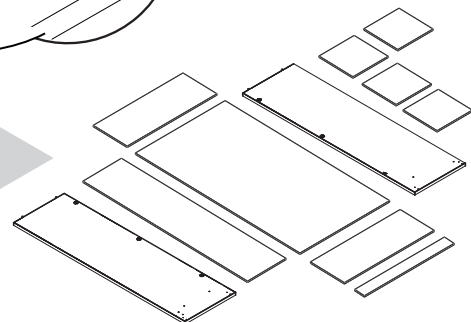
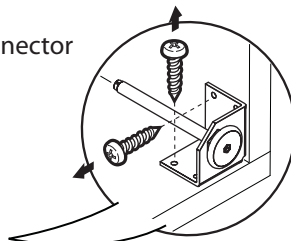
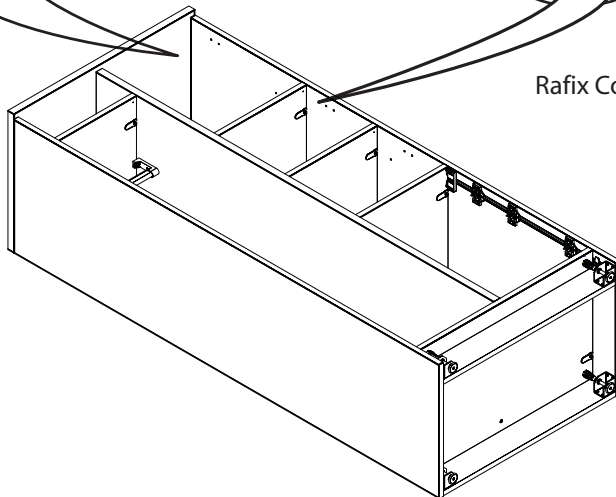

global

ZIRA

Personal Towers with Open Shelves

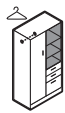
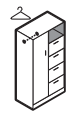
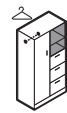
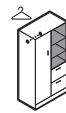

65"ht
Z24...36L6EN L/R Z24...36L6FN L/R Z24...36L6FN L/R Z24...36L6FN L/R
Z24...36M6EN L/R Z24...36M6FN L/R Z24...36M6FN L/R Z24...36M6FN L/R

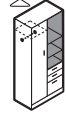
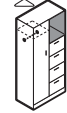
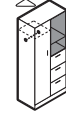
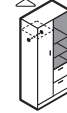

72.5"ht
Z24...36L7EN L/R Z24...36L7FN L/R Z24...36L7FN L/R Z24...36L7FN L/R
Z24...36M7EN L/R Z24...36M7FN L/R Z24...36M7FN L/R Z24...36M7FN L/R

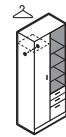
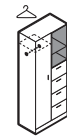
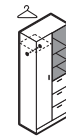
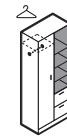

84"ht
Z24...36L8EN L/R Z24...36L8FN L/R Z24...36L8FN L/R Z24...36L8FN L/R
Z24...36M8EN L/R Z24...36M8FN L/R Z24...36M8FN L/R Z24...36M8FN L/R

Disassembly Instructions

TOOLS REQUIRED



WRENCH

Size #16 or 5/8"

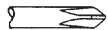

PHILLIPS

Screwdriver size #2

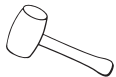

Rubber Mallet



Safety Glasses

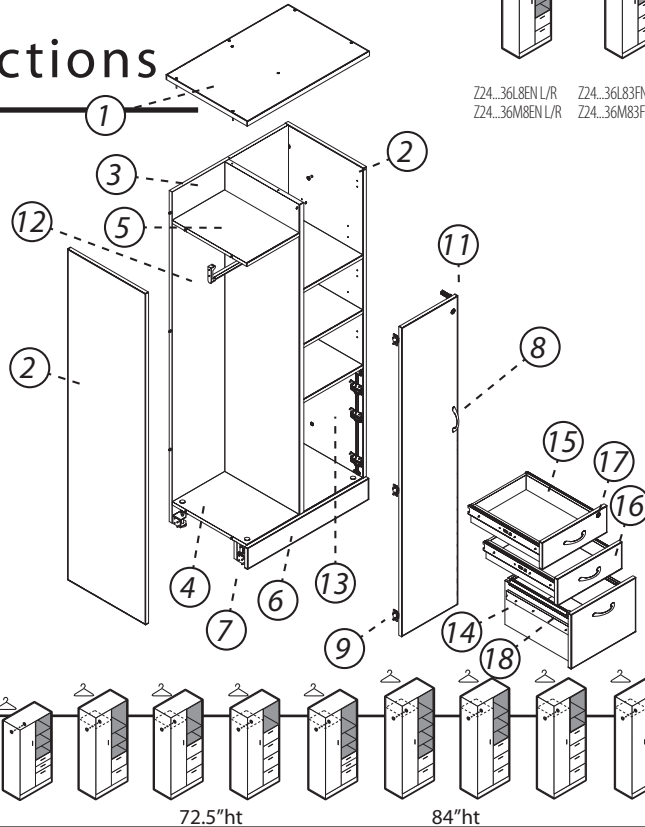

ITEM	DESCRIPTION	QUANTITIES												MATERIAL
		z1	1	1	1	1	1	1	1	1	1	1	1	
1	TOP	z1	1	1	1	1	1	1	1	1	1	1	1	PARTICLEBOARD
2	SIDE AND MIDDLE	3	3	3	3	3	3	3	3	3	3	3	3	PARTICLEBOARD
3	BACK	1	1	1	1	1	1	1	1	1	1	1	1	PARTICLEBOARD
4	BOTTOM	1	1	1	1	1	1	1	1	1	1	1	1	PARTICLEBOARD
5	SHELF	3	2	1	3	3	2	1	3	4	3	2	4	PARTICLEBOARD
6	KICKBASE	1	1	1	1	1	1	1	1	1	1	1	1	PARTICLEBOARD
7	CORNER BRACKET W/LEVELER	4	4	4	4	4	4	4	4	4	4	4	4	STEEL
8	HANDLES	3	4	5	4	3	4	5	4	3	4	5	4	ALUMINIUM
9	HINGES	3	3	3	3	3	3	3	3	4	4	4	4	STEEL
10	DOOR	1	1	1	1	1	1	1	1	1	1	1	1	PARTICLEBOARD
11	DOOR LOCK MECHANISM	1	1	1	1	1	1	1	1	1	1	1	1	STEEL
12	HANGING ROD SYSTEM	1	1	1	1	1	1	1	1	1	1	1	1	STEEL/PLASTIC
13	SLIDES (BASE PLATE)	4	6	8	6	4	6	8	6	4	6	8	6	STEEL
14	SLIDES (INNER)	4	6	8	6	4	6	8	6	4	6	8	6	STEEL
15	DRAWER	2	3	4	3	2	3	4	3	2	3	4	3	MDF
16	DRAWER FRONT	2	3	4	3	2	3	4	3	2	3	4	3	PARTICLEBOARD
17	DRAWER LOCK MECHANISM	1	1	1	1	1	1	1	1	1	1	1	1	STEEL
18	HANGING FILE SYSTEM	2	3	4	1	2	3	4	3	2	3	4	3	STEEL/PLASTIC
19	SCREWS/BOLTS	130	149	168	153	131	153	172	154	139	161	180	162	STEEL

STEPS

- ➊ Remove door by pressing on back of hinges and pulling doors forward.
- ➋ Unscrew and remove hinges, handles and door lock mechanism from doors.
- ➌ Remove Drawers by Fully Extending and Disengaging latch on each slide while pulling drawer out. Remove door by pressing on back of hinges and pulling doors forward.
- ➍ On Drawer boxes, unscrew and remove slide channels, handles and door lock mechanism. Remove hanging file

system.

- ➎ Turn unit. Pull kickbase and unscrew kick base connector. Unscrew door stopper. Unscrew and remove Hanging rod system.

- ➏ Untighten Blum and Rafx Connectors. Unscrew and remove corner brackets with leveler.

- ➐ Unscrew Blum and Rafx bolts. Unscrew and remove glide channels and Drawer Lock Mechanism.

NOTE: Any alterations to listed components will void the manufacturer's warranty. The manufacturer will not be responsible for any damage or bodily harm caused by alterations in accordance with national or local electrical codes and manufacturer's specifications. In accordance with the manufacturer's policy of continual product improvement, the product presented in this document is subject to change without notice or obligation.

Please contact Global Customer Care at 905-660-5101 for any questions or concerns.

ZDIS38 rev: 00

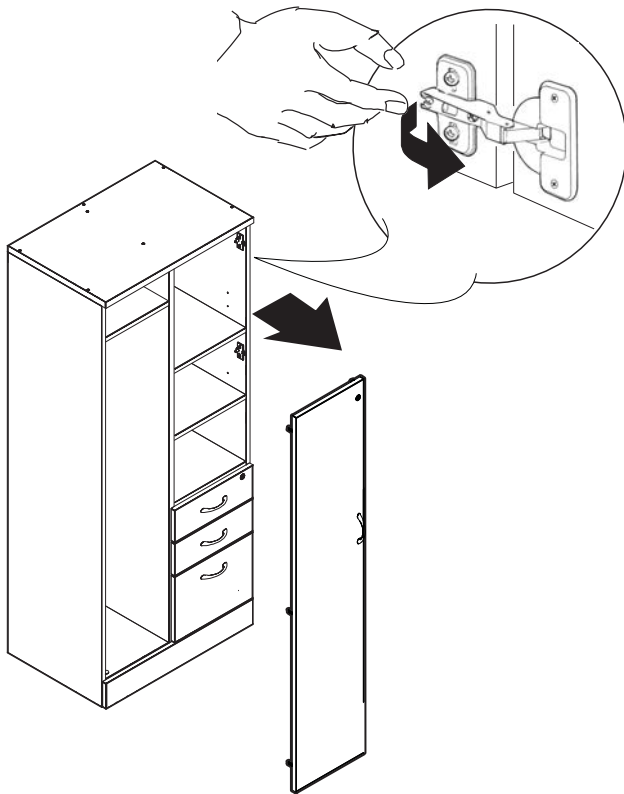
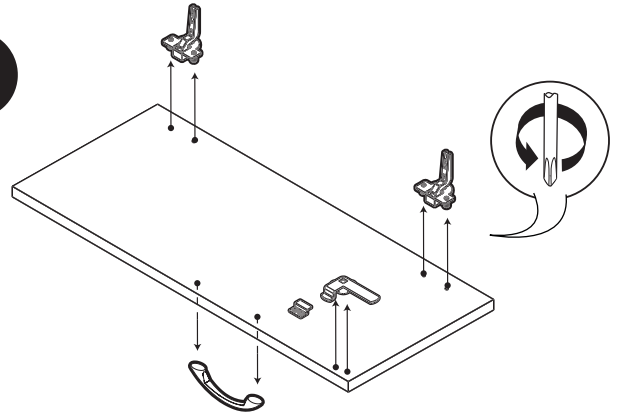
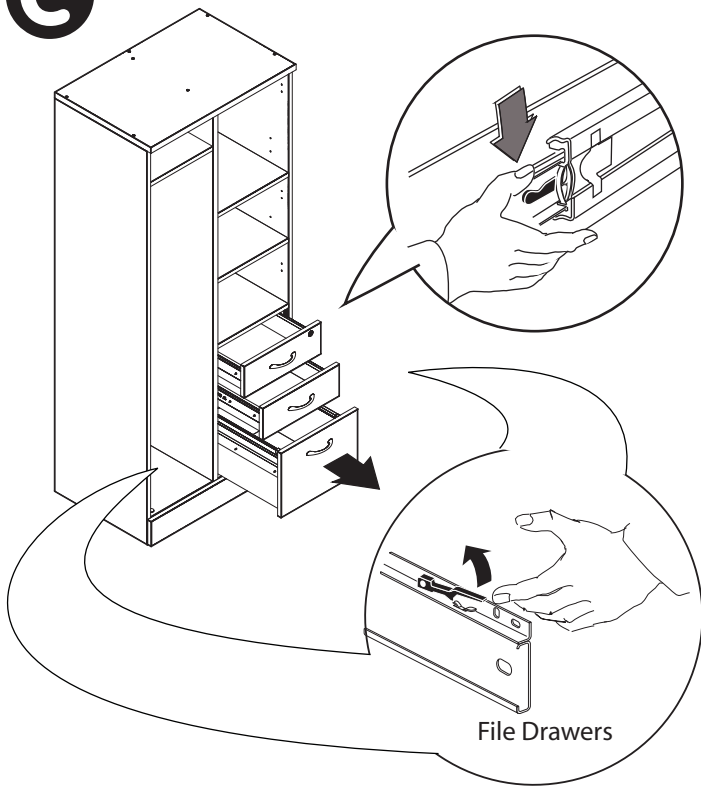
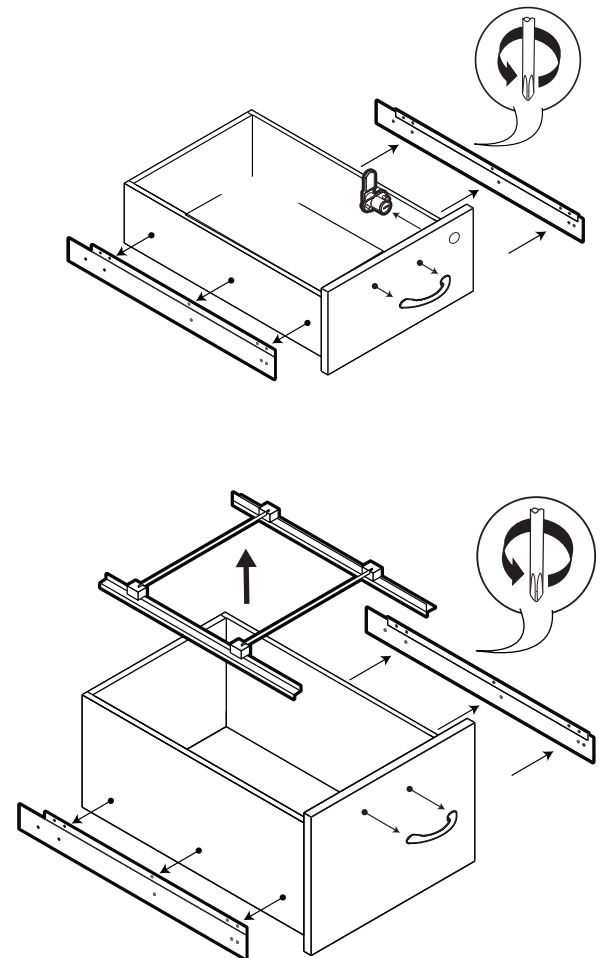
A**B****C****D**

E

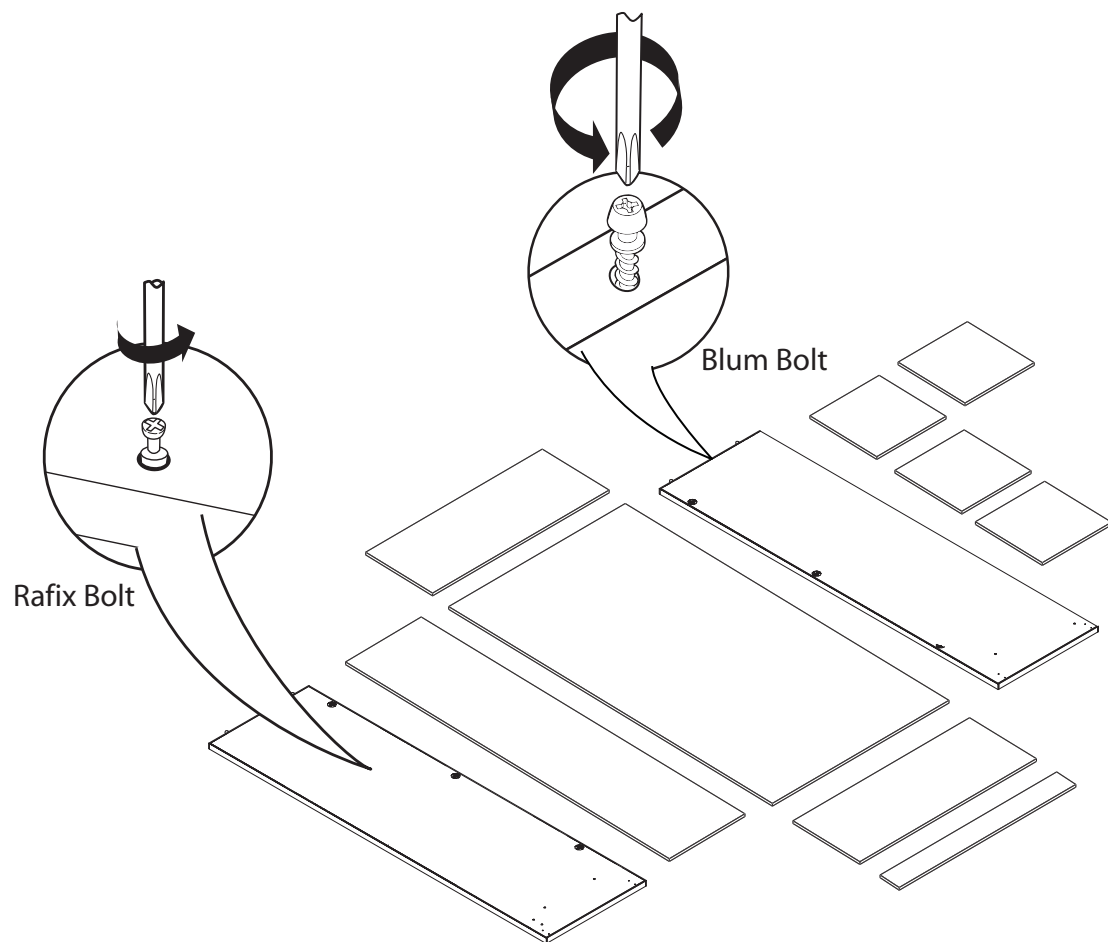

E

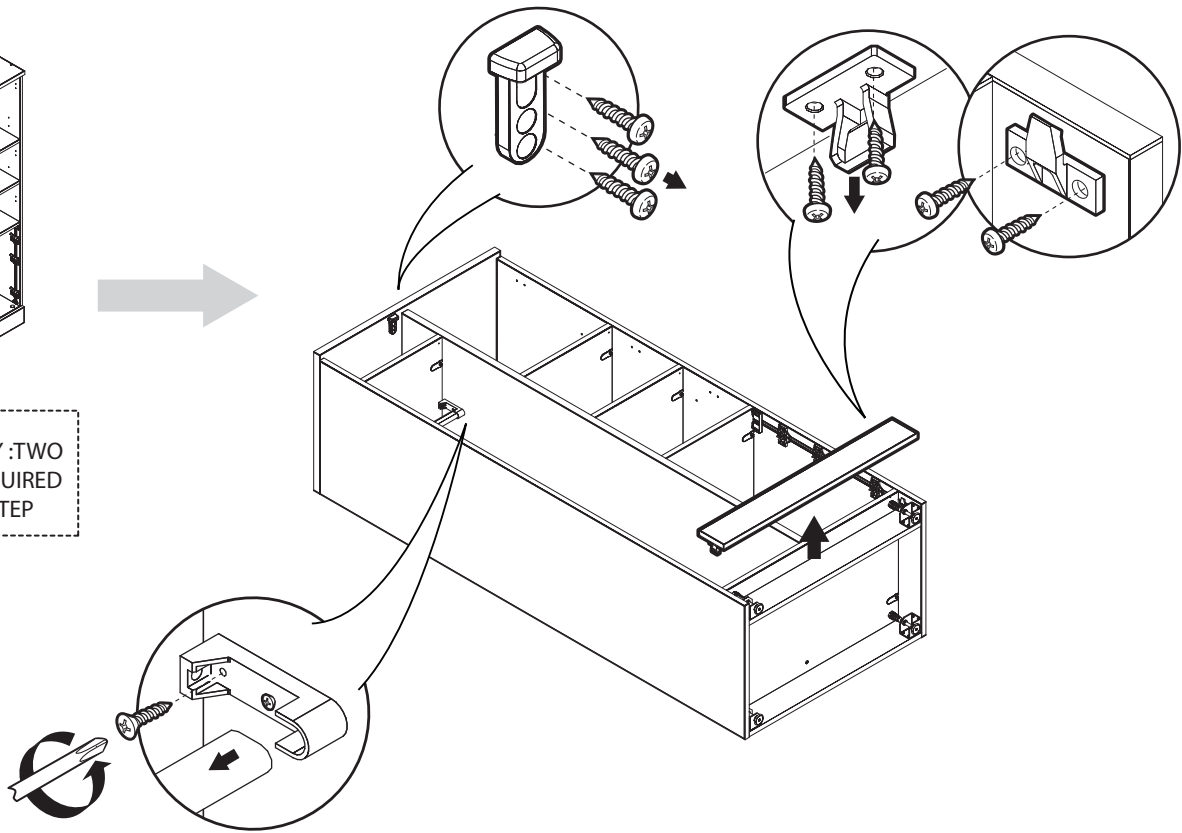
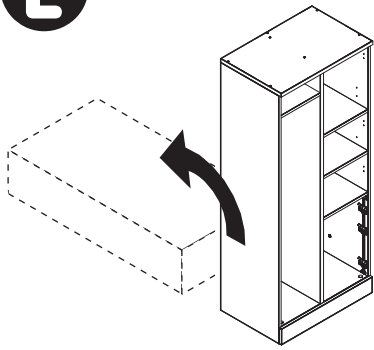

F

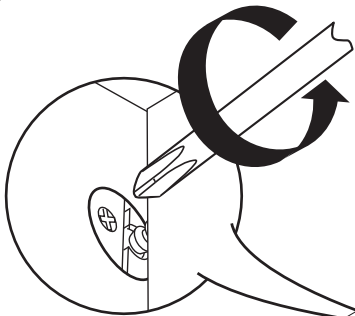

Blum Connector

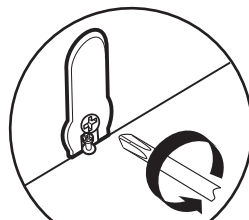

Rafix Connector

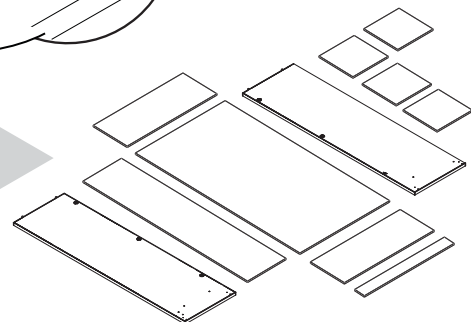
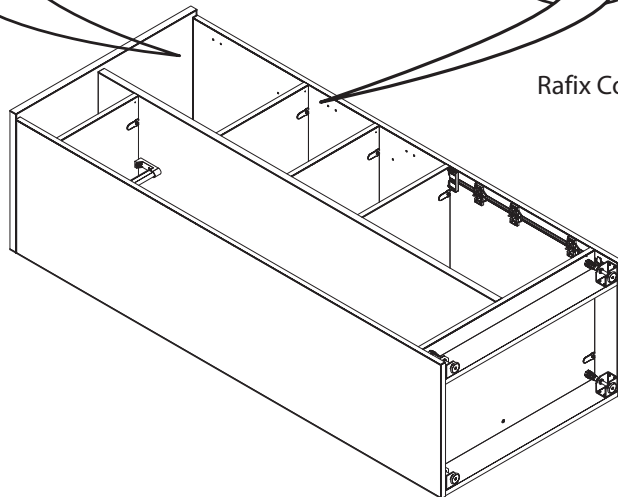
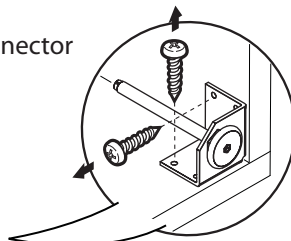



ZIRA

Personal Towers w/Cavity

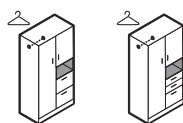

65"ht
Z24...36L6ECL/R Z24...36L6BFC L/R
Z24...36M6ECL/R Z24...36M6BFC L/R

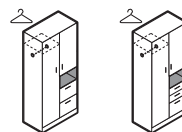

72.5"ht
Z24...36L7ECL/R Z24...36L7BFC L/R
Z24...36M7ECL/R Z24...36M7BFC L/R

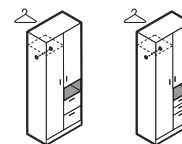

84"ht
Z24...36L8ECL/R Z24...36L8BFC L/R
Z24...36M8ECL/R Z24...36M8BFC L/R

Disassembly Instructions

TOOLS REQUIRED



WRENCH
Size #16 or 5/8"



PHILLIPS
Screwdriver size #2

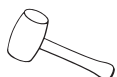

Rubber Mallet



Safety Glasses

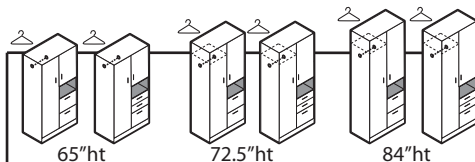
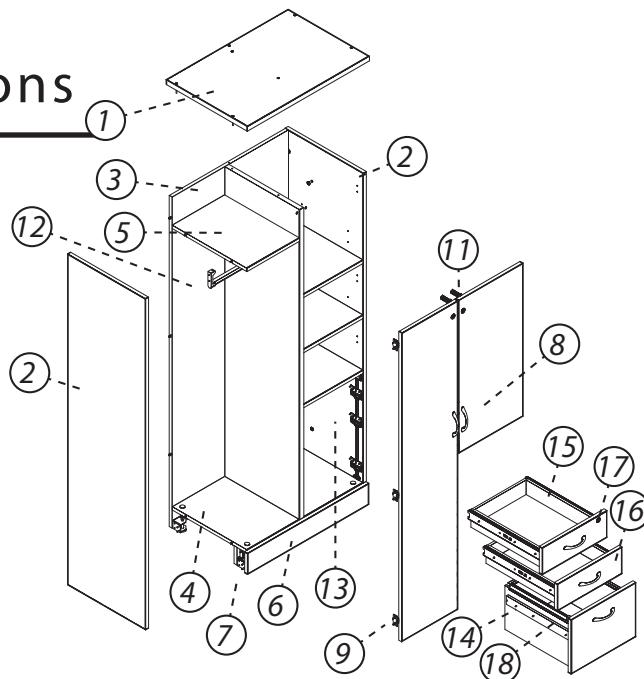

ITEM	DESCRIPTION	QUANTITIES												MATERIAL
		65"ht	65"ht	72.5"ht	72.5"ht	72.5"ht	72.5"ht	84"ht	84"ht	84"ht	84"ht	84"ht	84"ht	
1	TOP	1	1	1	1	1	1	1	1	1	1	1	1	PARTICLEBOARD
2	SIDE AND MIDDLE	3	3	3	3	3	3	3	3	3	3	3	3	PARTICLEBOARD
3	BACK	1	1	1	1	1	1	1	1	1	1	1	1	PARTICLEBOARD
4	BOTTOM	1	1	1	1	1	1	1	1	1	1	1	1	PARTICLEBOARD
5	SHELF	3	3	4	4	4	4	4	4	4	4	4	4	PARTICLEBOARD
6	KICKBASE	1	1	1	1	1	1	1	1	1	1	1	1	PARTICLEBOARD
7	CORNER BRACKET W/LEVELER	4	4	4	4	4	4	4	4	4	4	4	4	STEEL
8	HANDLES	4	5	4	5	4	5	4	5	4	5	4	5	ALUMINIUM
9	HINGES	5	5	5	5	6	6	6	6	6	6	6	6	STEEL
10	DOOR	2	2	2	2	2	2	2	2	2	2	2	2	PARTICLEBOARD
11	DOOR LOCK MECHANISM	2	2	2	2	2	2	2	2	2	2	2	2	STEEL
12	HANGING ROD SYSTEM	1	1	1	1	1	1	1	1	1	1	1	1	STEEL/PLASTIC
13	SLIDES (BASE PLATE)	4	6	4	6	4	6	4	6	4	6	4	6	STEEL
14	SLIDES (INNER)	4	6	4	6	4	6	4	6	4	6	4	6	STEEL
15	DRAWER	2	3	2	3	2	3	2	3	2	3	2	3	MDF
16	DRAWER FRONT	2	3	2	3	2	3	2	3	2	3	2	3	PARTICLEBOARD
17	DRAWER LOCK MECHANISM	1	1	1	1	1	1	1	1	1	1	1	1	STEEL
18	HANGING FILE SYSTEM	1	1	1	1	1	1	1	1	1	1	1	1	STEEL/PLASTIC
19	SCREWS/BOLTS	138	140	142	144	147	152							STEEL

Please contact Global Customer Care at 905-660-5101 for any questions or concerns.

STEPS

- Remove door by pressing on back of hinges and pulling doors forward.
- Unscrew and remove hinges, handles and door lock mechanism from doors.
- Remove Drawers by Fully Extending and Disengaging latch on each slide while pulling drawer out. Remove door by pressing on back of hinges and pulling doors forward.
- On Drawer boxes, unscrew and remove slide channels, handles and door lock mechanism. Remove hanging file

system.

- Turn unit. Pull kickbase and unscrew kick base connector. Unscrew door stopper. Unscrew and remove Hanging rod system.
- Untighten Blum and Rafx Connectors. Unscrew and remove corner brackets with leveler.
- Unscrew Blum and Rafx bolts. Unscrew and remove glide channels and Drawer Lock Mechanism.

NOTE: Any alterations to listed components will void the manufacturer's warranty. The manufacturer will not be responsible for any damage or bodily harm caused by alterations in accordance with national or local electrical codes and manufacturer's specifications. In accordance with the manufacturer's policy of continual product improvement, the product presented in this document is subject to change without notice or obligation.

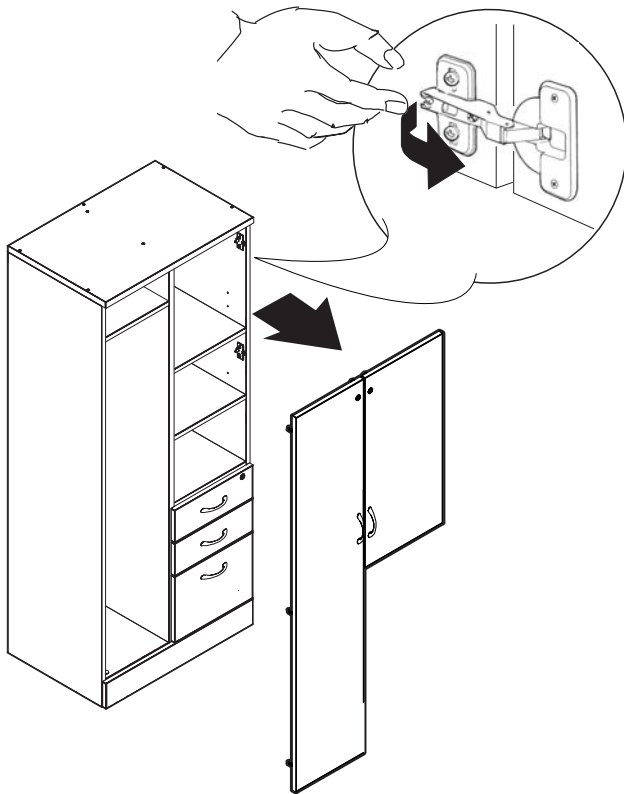
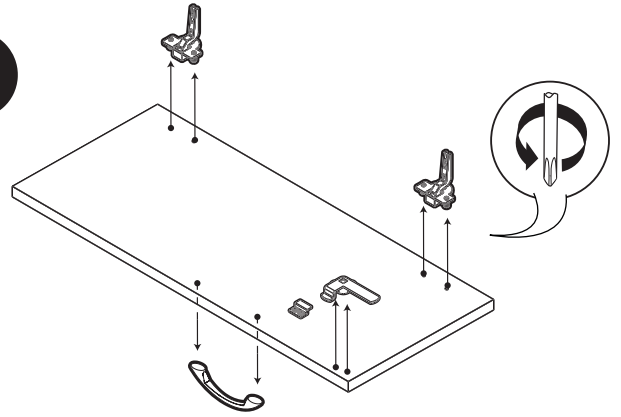
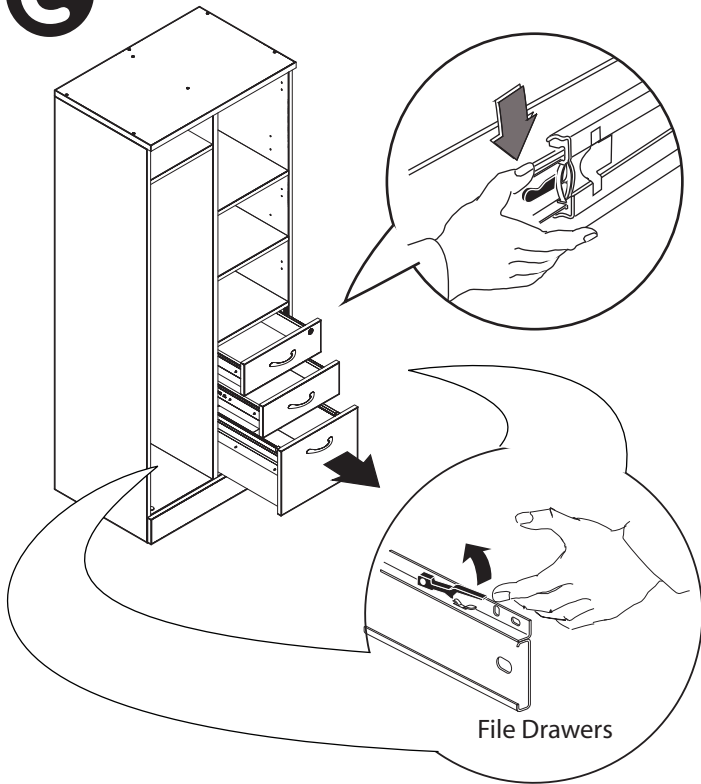
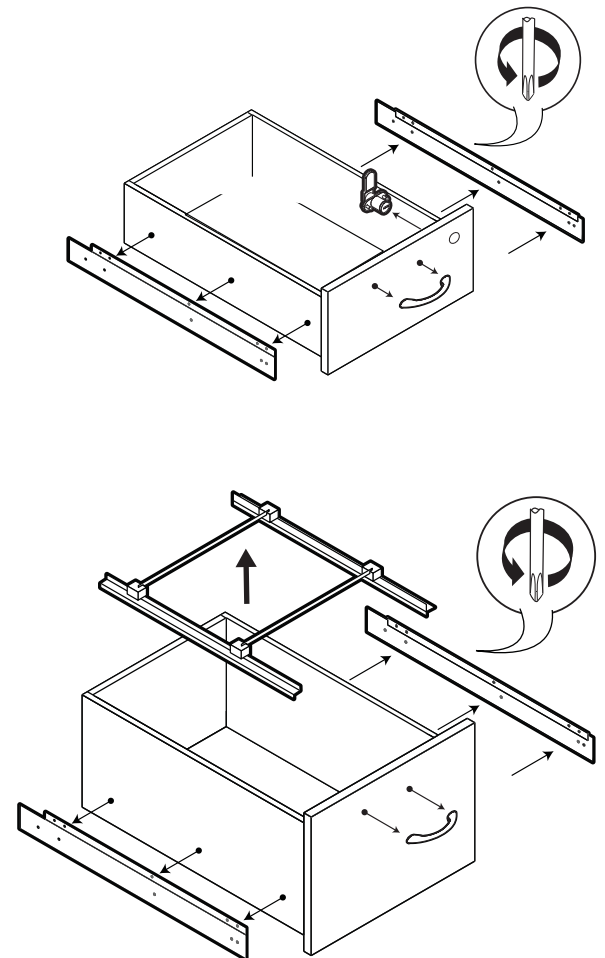
A**B****C****D**

E

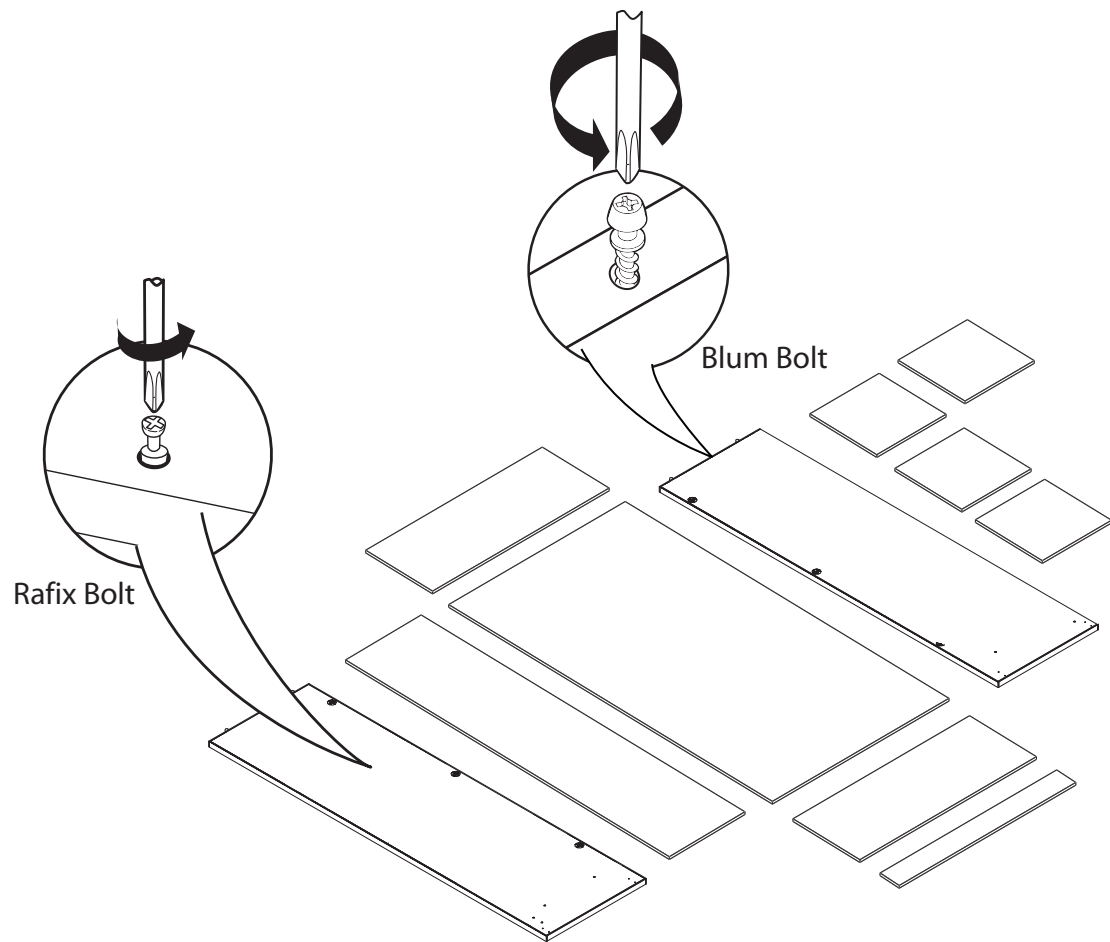

E

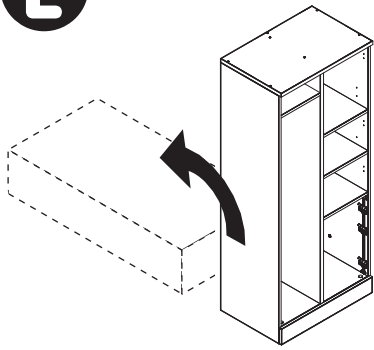

FOR SAFETY :TWO
PEOPLE REQUIRED
FOR THIS STEP

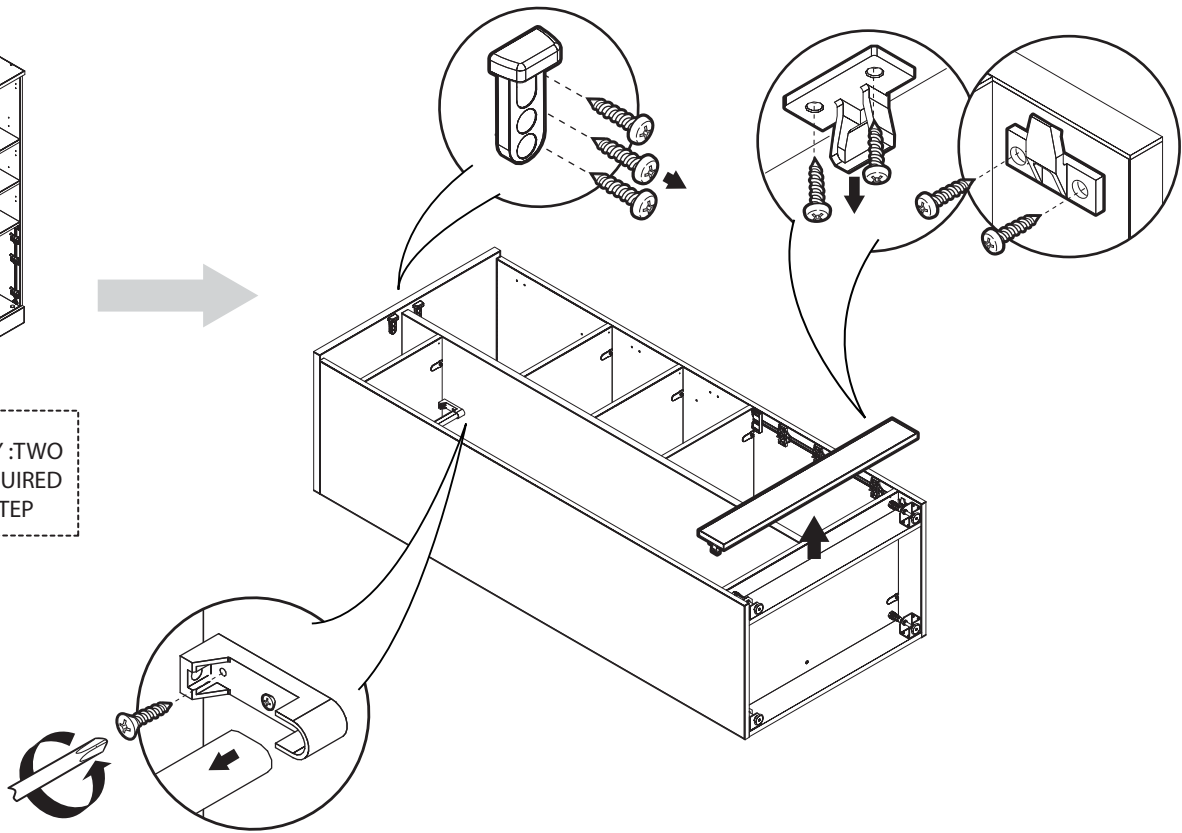

F

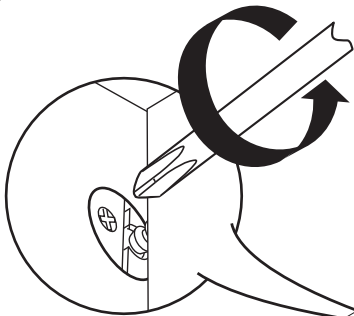

Blum Connector

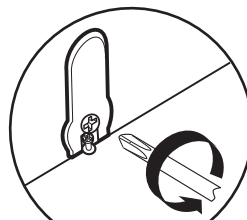

Rafix Connector

