

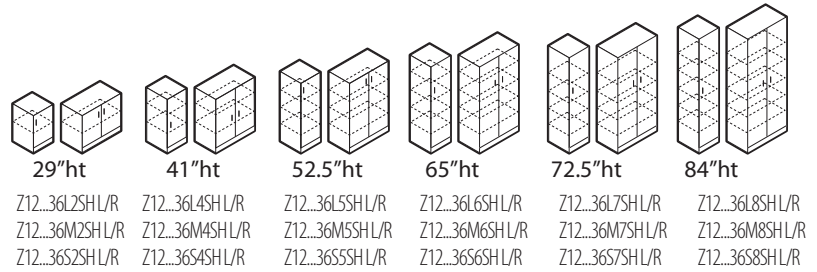

ZIRA

Storage Cabinet w/door (29"H -84"H)



Disassembly Instructions

TOOLS REQUIRED



WRENCH
Size #16 or 5/8"

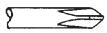

PHILLIPS
Screwdriver size #2

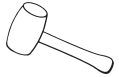

Rubber Mallet



Safety Glasses

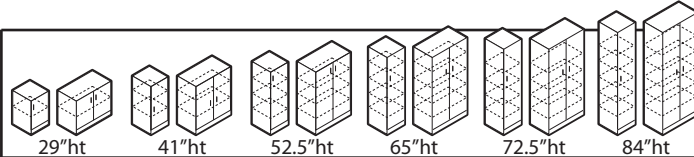
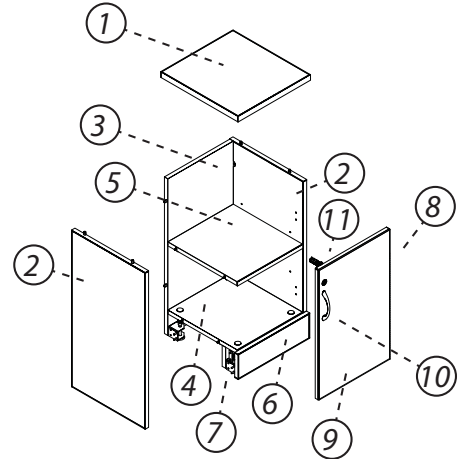
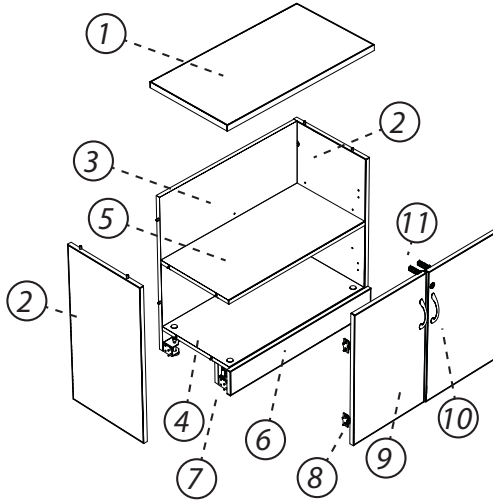

ITEM	DESCRIPTION	QUANTITIES						MATERIAL
		1Door-2Doors	1Door-2Doors	1Door-2Doors	1Door-2Doors	1Door-2Doors	1Door-2Doors	
1	TOP	1	1	1	1	1	1	PARTICLEBOARD
2	SIDE	2	2	2	2	2	2	PARTICLEBOARD
3	BACK	1	1	1	1	1	1	PARTICLEBOARD
4	BOTTOM	1	1	1	1	1	1	PARTICLEBOARD
5	SHELF	1	2	3	4	4	5	PARTICLEBOARD
6	KICKBASE	1	1	1	1	1	1	PARTICLEBOARD
7	CORNER BRACKET W/LEVELER	4	4	4	4	4	4	STEEL
8	HINGES	2 - 4	2 - 4	3 - 6	3 - 6	3 - 6	4 - 8	STEEL
9	DOOR	1 - 2	1 - 2	1 - 2	1 - 2	1 - 2	1 - 2	PARTICLEBOARD
10	HANDLE	1 - 2	1 - 2	1 - 2	1 - 2	1 - 2	1 - 2	ALUMINIUM
11	DOOR LOCK MECHANISM	1	1	1	1	1	1	STEEL
12	SCREWS/BOLTS	54 - 62	58 - 67	64 - 74	67 - 81	70 - 81	76 - 88	STEEL

Please contact Global Customer Care at 905-660-5101 for any questions or concerns.

STEPS

- Remove door by pressing on back of hinges and pulling doors forward.
- Unscrew and remove hinges, handles and door lock mechanism from doors.
- Turn unit. Pull kickbase and unscrew kick base connector. Unscrew door stopper.

- Untighten Blum Connectors. Unscrew and remove corner brackets with leveler.
- Unscrew Blum Bolts

NOTE: Any alterations to listed components will void the manufacturer's warranty. The manufacturer will not be responsible for any damage or bodily harm caused by alterations in accordance with national or local electrical codes and manufacturer's specifications. In accordance with the manufacturer's policy of continual product improvement, the product presented in this document is subject to change without notice or obligation.

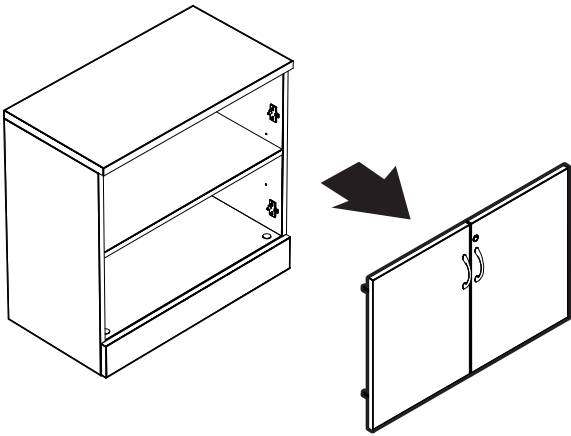
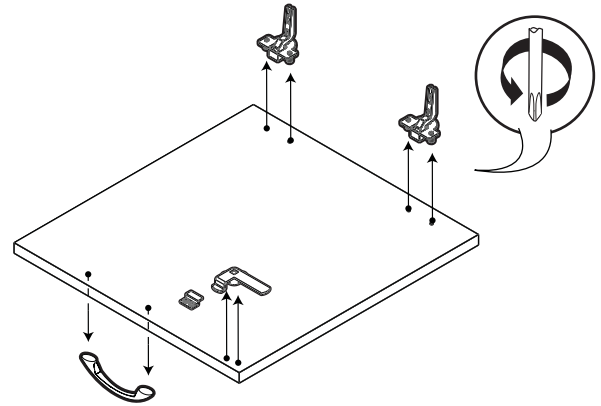
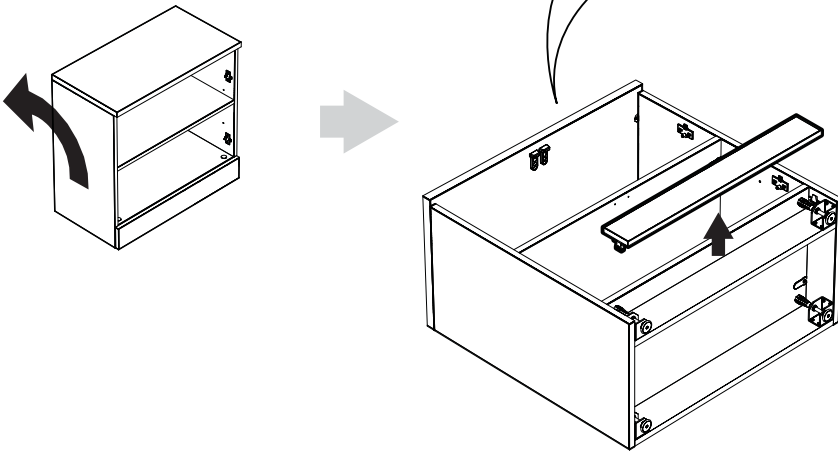
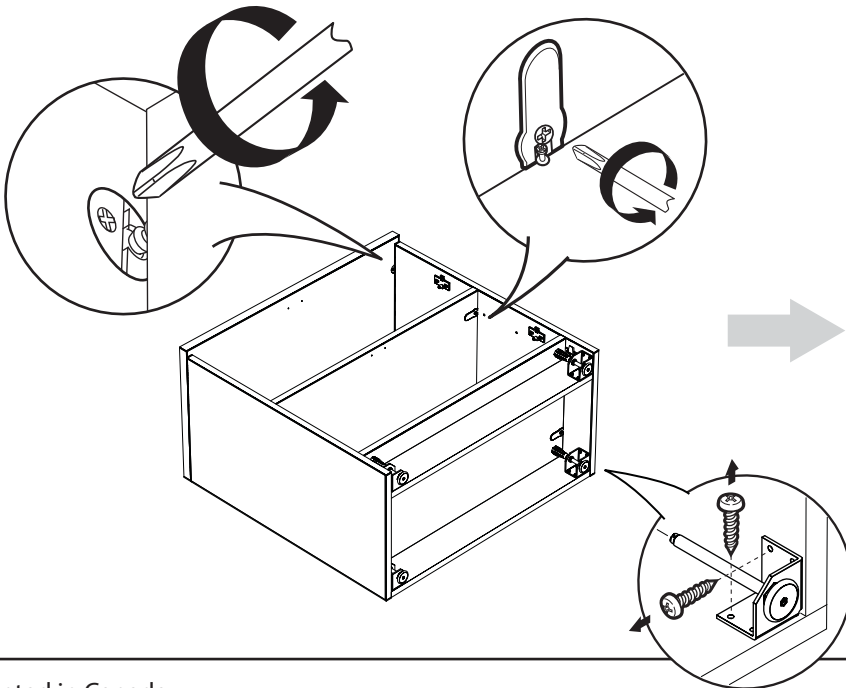
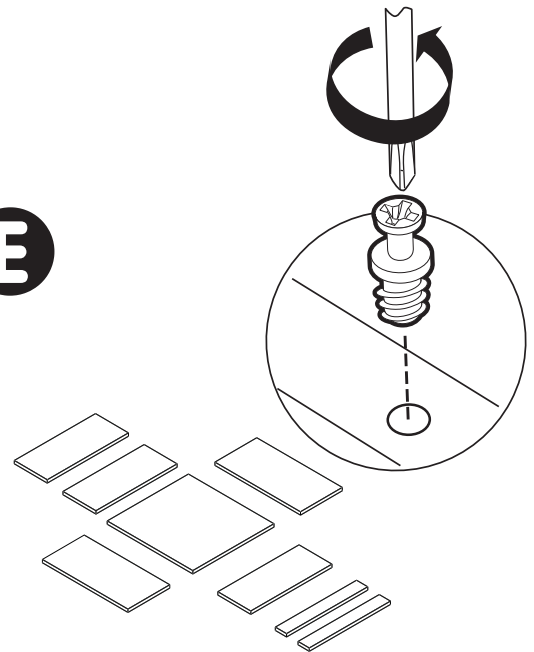
A**B****C****D****E**



ZIRA

Open Storage Cabinet (29"H -84"H)

29"ht	41"ht	52.5"ht	65"ht	72.5"ht	84"ht
Z12...36L2SHN	Z12...36L4SHN	Z12...36L5SHN	Z12...36L6SHN	Z12...36L7SHN	Z12...36L8SHN
Z12...36M2SHN	Z12...36M4SHN	Z12...36M5SHN	Z12...36M6SHN	Z12...36M7SHN	Z12...36M8SHN
Z12...36S2SHN	Z12...36S4SHN	Z12...36S5SHN	Z12...36S6SHN	Z12...36S7SHN	Z12...36S8SHN

Disassembly Instructions

TOOLS REQUIRED



WRENCH
Size #16 or 5/8"

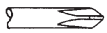

PHILLIPS
Screwdriver size #2

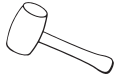

Rubber Mallet



Safety Glasses

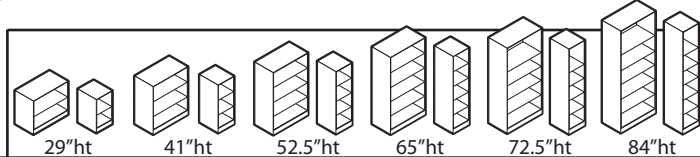
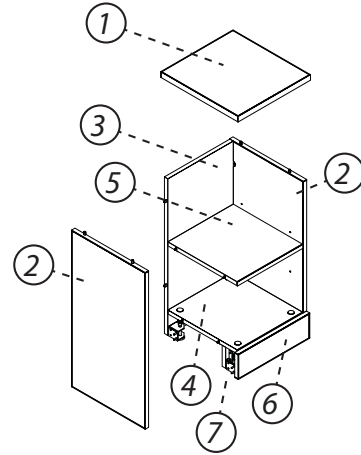
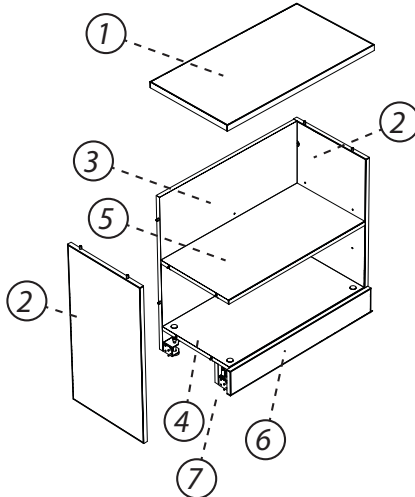

ITEM	DESCRIPTION	QUANTITIES						MATERIAL
		29"ht	41"ht	52.5"ht	65"ht	72.5"ht	84"ht	
1	TOP	1	1	1	1	1	1	PARTICLEBOARD
2	SIDE	2	2	2	2	2	2	PARTICLEBOARD
3	BACK	1	1	1	1	1	1	PARTICLEBOARD
4	BOTTOM	1	1	1	1	1	1	PARTICLEBOARD
5	SHELF	1	2	3	4	4	5	PARTICLEBOARD
6	KICKBASE	1	1	1	1	1	1	PARTICLEBOARD
7	CORNER BRACKET W/LEVELER	4	4	4	4	4	4	STEEL
8	SCREWS/BOLTS	68	73	78	81	83	94	STEEL

Please contact Global Customer Care at 905-660-5101 for any questions or concerns.

STEPS

- Turn unit. Pull kickbase and unscrew kick base connector. Unscrew door stopper.
- Untighten Blum and Rafx Connectors. Unscrew and remove corner brackets with leveler.
- Unscrew Blum and Rafx bolts

NOTE: Any alterations to listed components will void the manufacturer's warranty. The manufacturer will not be responsible for any damage or bodily harm caused by alterations in accordance with national or local electrical codes and manufacturer's specifications. In accordance with the manufacturer's policy of continual product improvement, the product presented in this document is subject to change without notice or obligation.

A

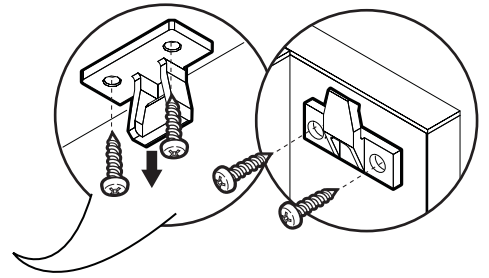
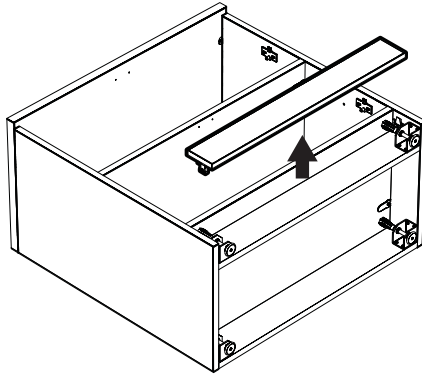
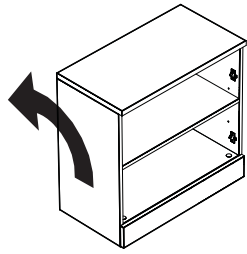

B

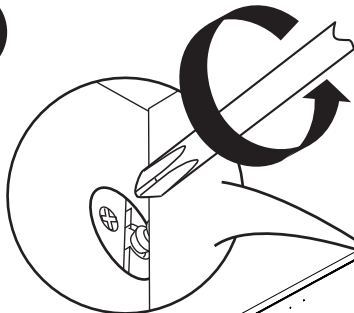

Blum Connector

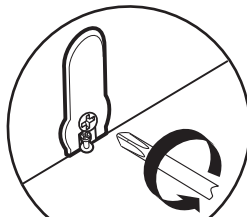

Rafx Connector



C

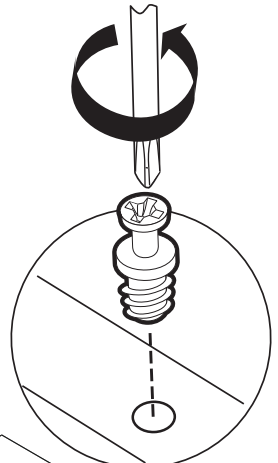

Rafx Bolt

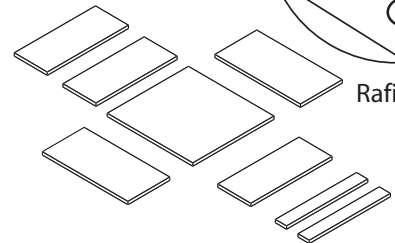



ZIRA

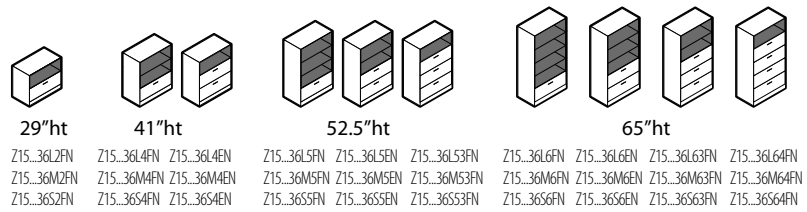

File module with Open Shelves (29"H -84"H)

Disassembly Instructions

TOOLS REQUIRED



WRENCH
Size #16 or 5/8"

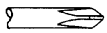

PHILLIPS
Screwdriver size #2

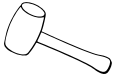

Rubber Mallet



Safety Glasses

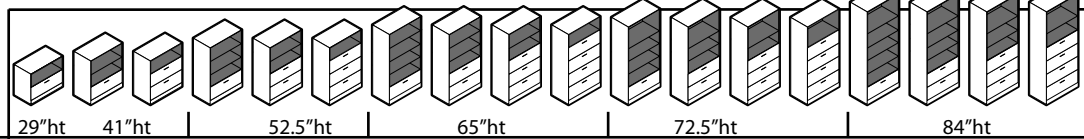
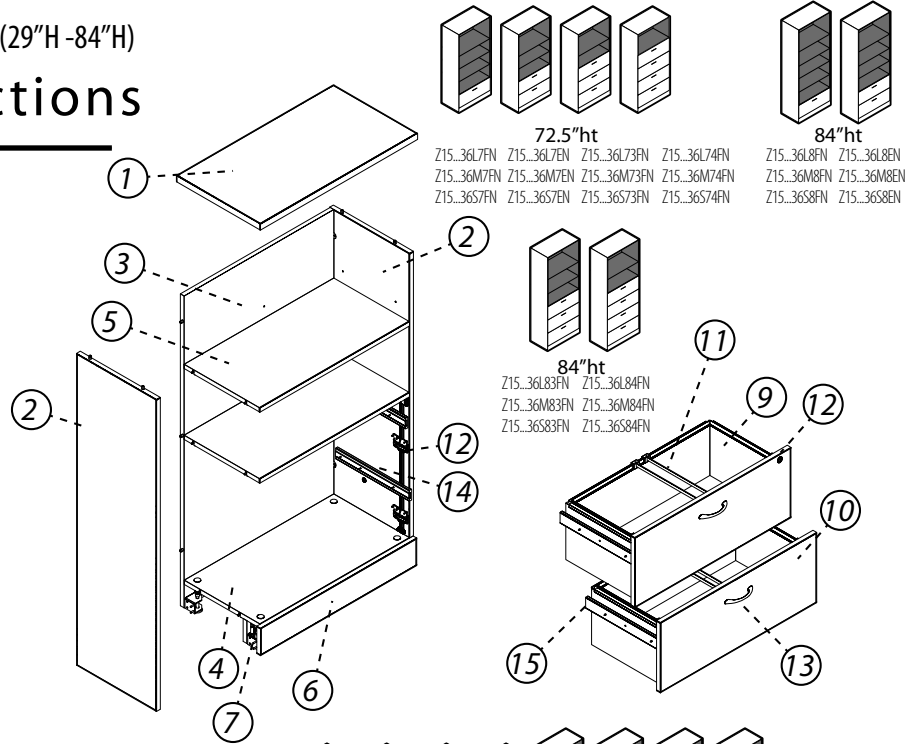

I.	DESCRIPTION	QUANTITIES																		MATERIAL
		29"ht	41"ht	52.5"ht	65"ht	72.5"ht	84"ht													
1	TOP	1	1	1	1	1	1	1	1	1	1	1	1	1	1	1	1	1	1	PARTICLEBOARD
2	SIDE	2	2	2	2	2	2	2	2	2	2	2	2	2	2	2	2	2	2	PARTICLEBOARD
3	BACK	1	1	1	1	1	1	1	1	1	1	1	1	1	1	1	1	1	1	PARTICLEBOARD
4	BOTTOM	1	1	1	1	1	1	1	1	1	1	1	1	1	1	1	1	1	1	PARTICLEBOARD
5	SHELF	0	1	0	2	1	0	3	2	1	0	3	2	1	0	4	3	2	1	PARTICLEBOARD
6	KICKBASE	1	1	1	1	1	1	1	1	1	1	1	1	1	1	1	1	1	1	PARTICLEBOARD
7	CORNER BRACKET W/LEVELER	4	4	4	4	4	4	4	4	4	4	4	4	4	4	4	4	4	4	STEEL
8	SCREWS/BOLTS	61	54	58	82	100	94	89	115	141	161	89	88	115	161	96	122	124	149	STEEL
9	DRAWER	1	1	2	1	2	3	1	2	3	4	1	2	3	4	1	2	3	4	MDF
10	DRAWER FRONT	1	1	2	1	2	3	1	2	3	4	1	2	3	4	1	2	3	4	PARTICLEBOARD
11	HANGING FILE SYSTEM	1	1	2	1	2	3	1	2	3	4	1	2	3	4	1	2	3	4	STEEL/PLASTIC
12	DRAWER LOCK MECHANISM	1	1	1	1	1	1	1	1	1	1	1	1	1	1	1	1	1	1	STEEL/PLASTIC
13	HANDLES	1	1	2	1	2	3	1	2	3	4	1	2	3	4	1	2	3	4	STEEL/PLASTIC
14	SLIDES (BASE PLATE)	2	2	4	2	4	6	2	4	6	8	2	4	6	8	2	4	6	8	STEEL
15	SLIDES (INNER)	2	2	4	2	4	6	2	4	6	8	2	4	6	8	2	4	6	8	STEEL

STEPS

- Remove Drawers by Fully Extending and Disengaging latch on each slide while pulling drawer out. Remove door by pressing on back of hinges and pulling doors forward.
- On Drawer boxes, unscrew and remove slide channels, handles and door lock mechanism . Remove hanging file system.
- Turn unit. Pull kickbase and unscrew kick base connector.
- Untighten Rafix Connectors. Remove shelves.
- Untighten Blum and Rafix Connectors. Unscrew and remove corner brackets with leveler.
- Unscrew and remove glide channels. Unscrew and remove Drawer Lock Mechanism. Unscrew Blum Bolt

NOTE: Any alterations to listed components will void the manufacturer's warranty. The manufacturer will not be responsible for any damage or bodily harm caused by alterations in accordance with national or local electrical codes and manufacturer's specifications. In accordance with the manufacturer's policy of continual product improvement, the product presented in this document is subject to change without notice or obligation.

Please contact Global Customer Care at 905-660-5101 for any questions or concerns.

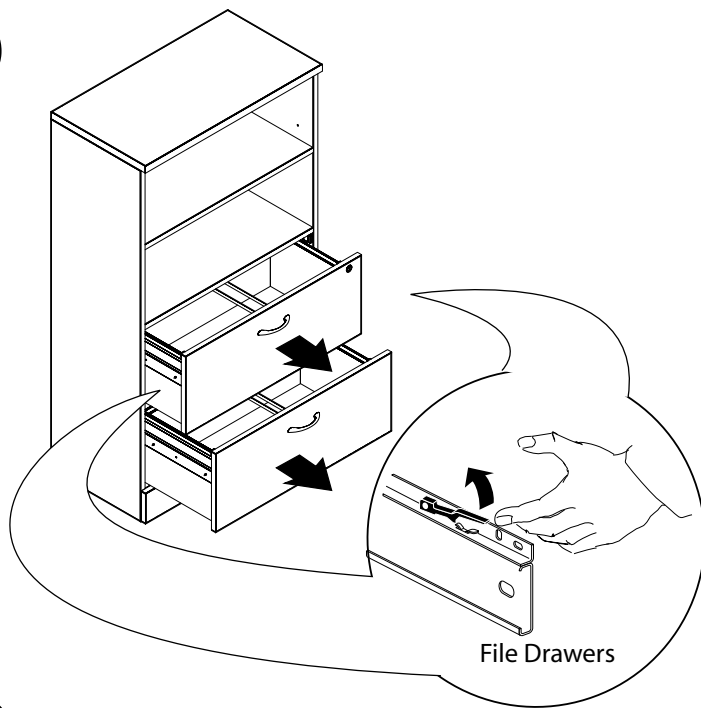
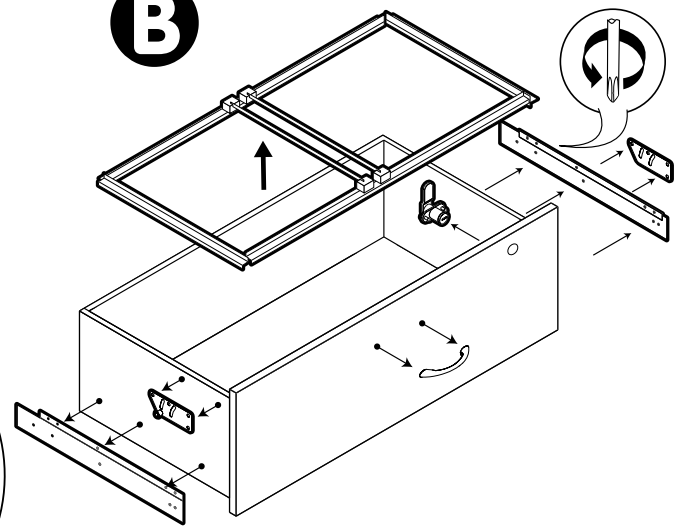
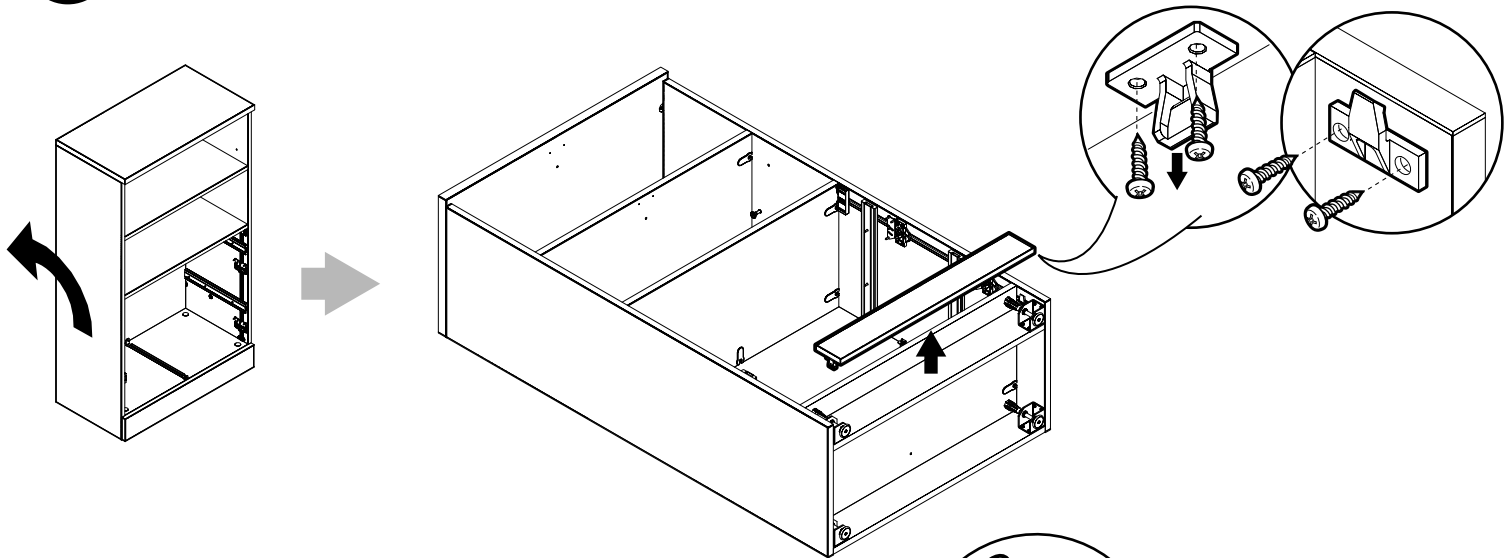
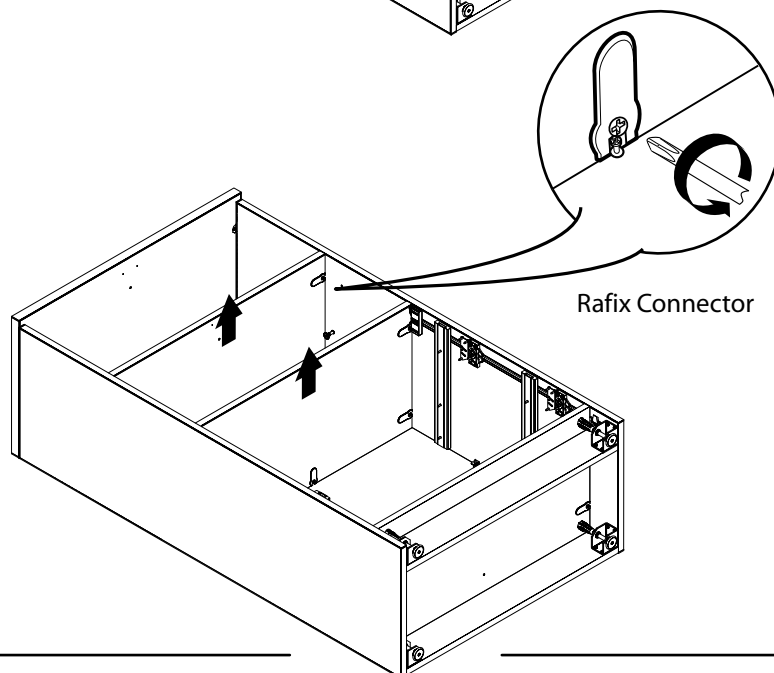
A**B****C****D**

E

Rafix Connector

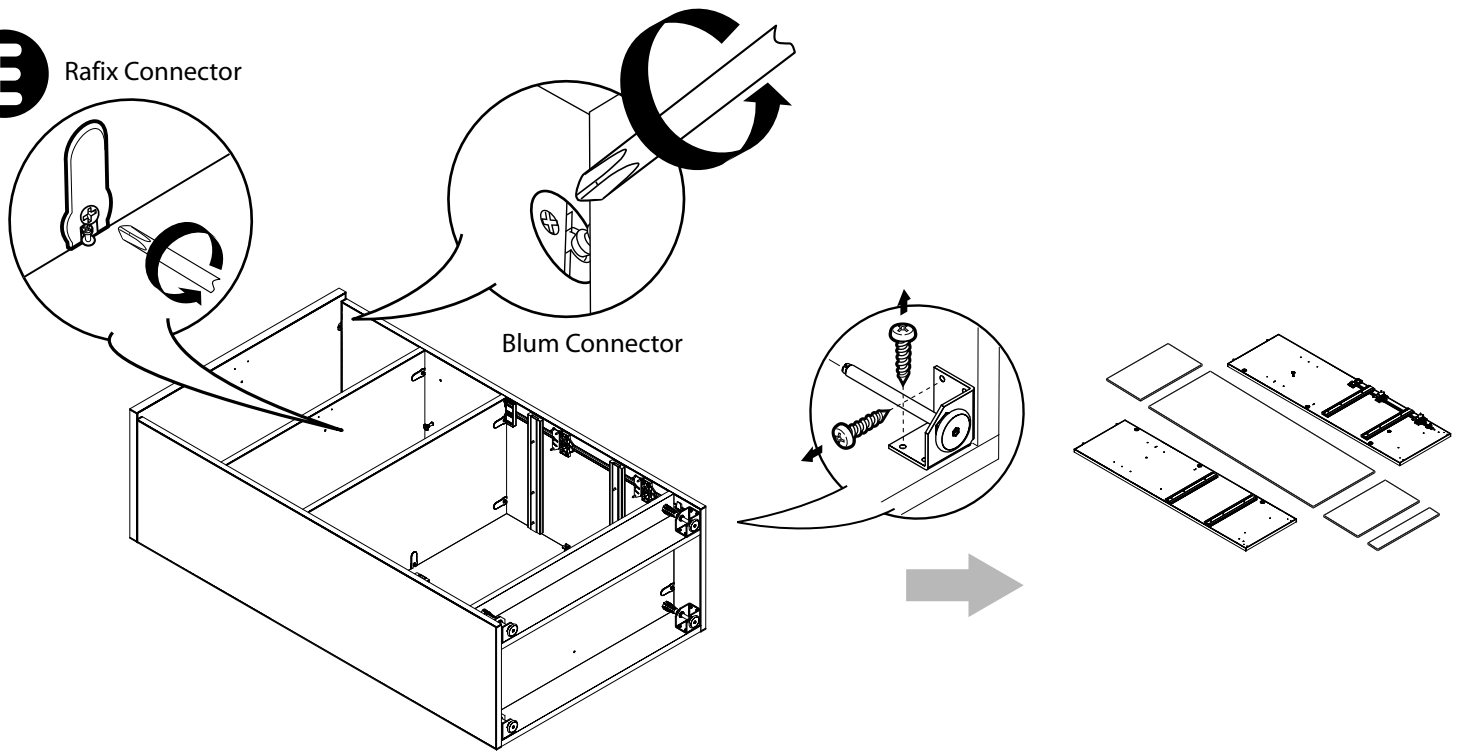
**F**

Blum Bolt

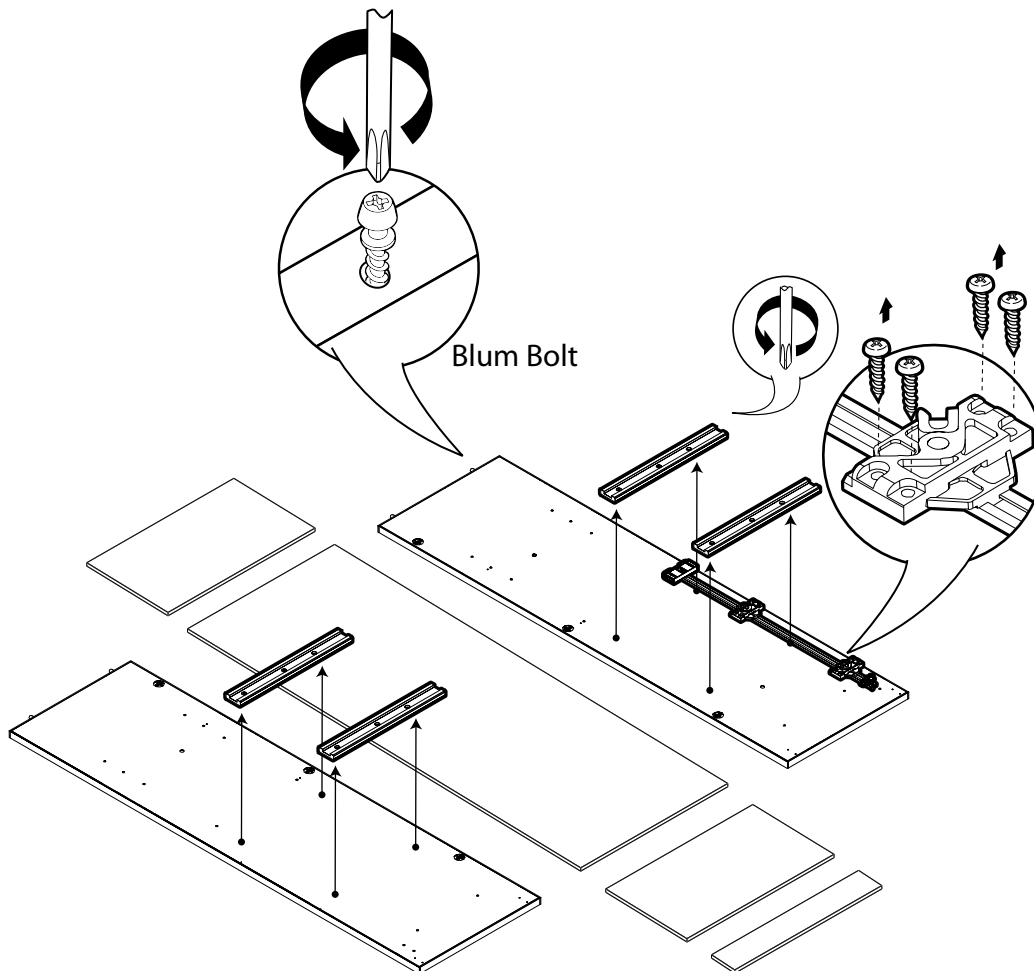



ZIRA

File Storage (29"H -52.5"H)
Mixed Storage (29"H)

File Storage (29"H -52.5"H)						Mixed Storage (29"H)		
Z36L2E	Z16L2E	Z36L43F	Z16L43F	Z36L54F	Z16L54F	Z16L2BF	Z36L2X L/R	Z36L2XN L/R
Z30L2E	Z15L2E	Z30L43F	Z15L43F	Z30L54F	Z15L54F	Z15L2BF	Z30L2X L/R	Z30L2XN L/R
Z36M2E	Z16M2E	Z36M43F	Z16M43F	Z36M54F	Z16M54F	Z16M2BF	Z36M2X L/R	Z36M2XN L/R
Z30M2E	Z15M2E	Z30M43F	Z15M43F	Z30M54F	Z15M54F	Z15M2BF	Z30M2X L/R	Z30M2XN L/R
Z36S2E	Z16S2E	Z36S43F	Z16S43F	Z36S54F	Z16S54F	Z16S2BF	Z36S2X L/R	Z36S2XN L/R
Z30S2E	Z15S2E	Z30S43F	Z15S43F	Z30S54F	Z15S54F	Z15S2BF	Z30S2X L/R	Z30S2XN L/R

Disassembly Instructions

TOOLS REQUIRED



WRENCH
Size #16 or 5/8"



PHILLIPS
Screwdriver size #2

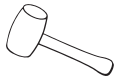

Rubber Mallet



Safety Glasses

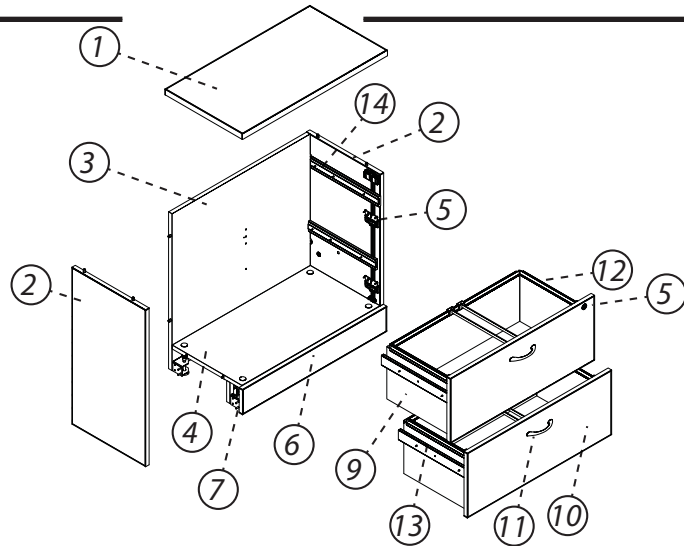

ITEM	DESCRIPTION	QUANTITIES								MATERIAL
		29"ht	41"ht	52.5"ht	29"ht	41"ht	52.5"ht	29"ht	41"ht	
1	TOP	1	1	1	1	1	1	1	1	PARTICLEBOARD
2	SIDE	2	2	2	2	2	2	2	2	PARTICLEBOARD
3	BACK	1	1	1	1	1	1	1	1	PARTICLEBOARD
4	BOTTOM	1	1	1	1	1	1	1	1	PARTICLEBOARD
5	DRAWER LOCK MECHANISM	1	2	3	1	1	1	1	1	PARTICLEBOARD
6	KICKBASE	1	1	1	1	1	1	1	1	PARTICLEBOARD
7	CORNER BRACKET W/LEVELER	4	4	4	4	4	4	4	4	STEEL
8	SCREWS/BOLTS	83	87	106	97	142	125	83	87	STEEL
9	DRAWER	2	3	4	3	4	3	2	3	MDF
10	DRAWER FRONT	2	3	4	3	4	3	2	3	PARTICLEBOARD
11	HANDLES	2	3	4	4	4	4	2	3	ALUMINIUM
12	HANGING FILE SYSTEM	2	3	4	1	2	1	2	3	PLASTIC/STEEL
13	SLIDES (INNER)	4	6	8	6	8	6	4	6	STEEL
14	SLIDES (BASE PLATE)	4	6	8	6	8	6	4	6	STEEL

Please contact Global Customer Care at 905-660-5101 for any questions or concerns.

STEPS

A Remove Drawers by Fully Extending and Disengaging latch on each slide while pulling drawer out.

B On Drawer boxes, unscrew and remove slide channels, handles and door lock mechanism . Remove hanging file system.

C Turn unit. Pull kickbase and unscrew kick base connector.

D Untighten Blum and Rafx Connectors. Unscrew and remove corner brackets with leveler.

E Unscrew Blum and Rafx Bolts. Unscrew and remove drawer mechanism. Unscrew and remove glide channels.

NOTE: Any alterations to listed components will void the manufacturer's warranty. The manufacturer will not be responsible for any damage or bodily harm caused by alterations in accordance with national or local electrical codes and manufacturer's specifications. In accordance with the manufacturer's policy of continual product improvement, the product presented in this document is subject to change without notice or obligation.

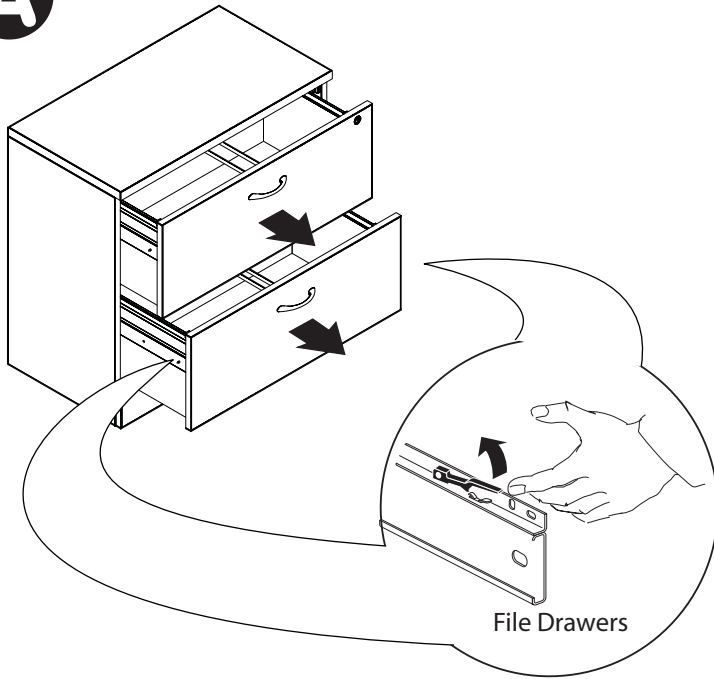
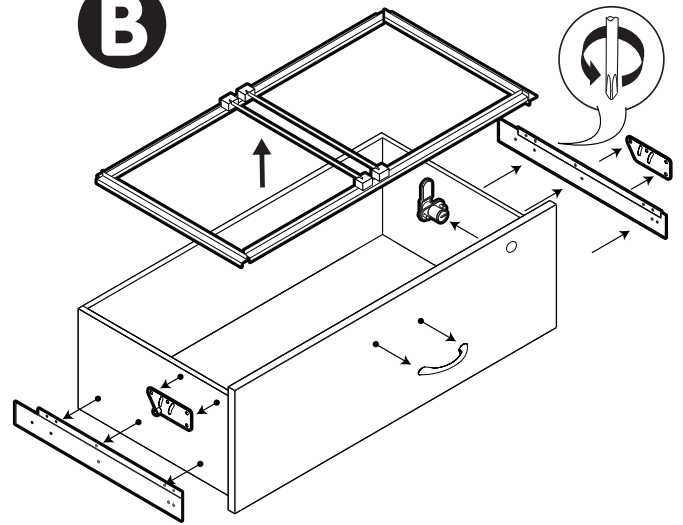
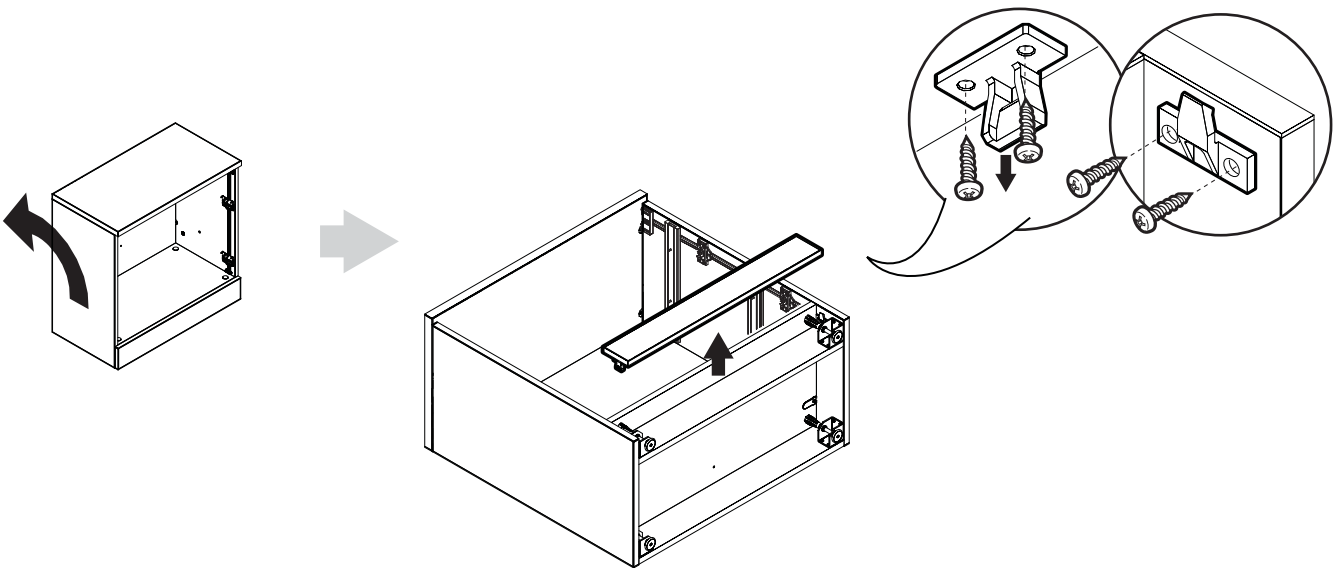
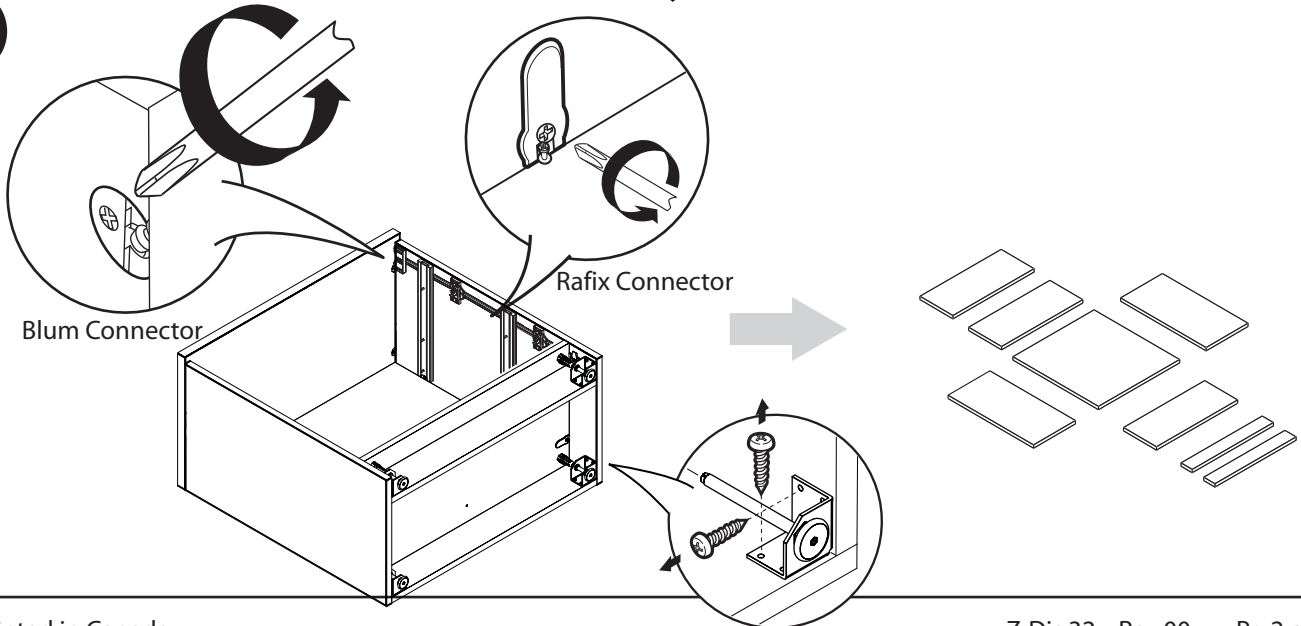
A**B****C****D**

E

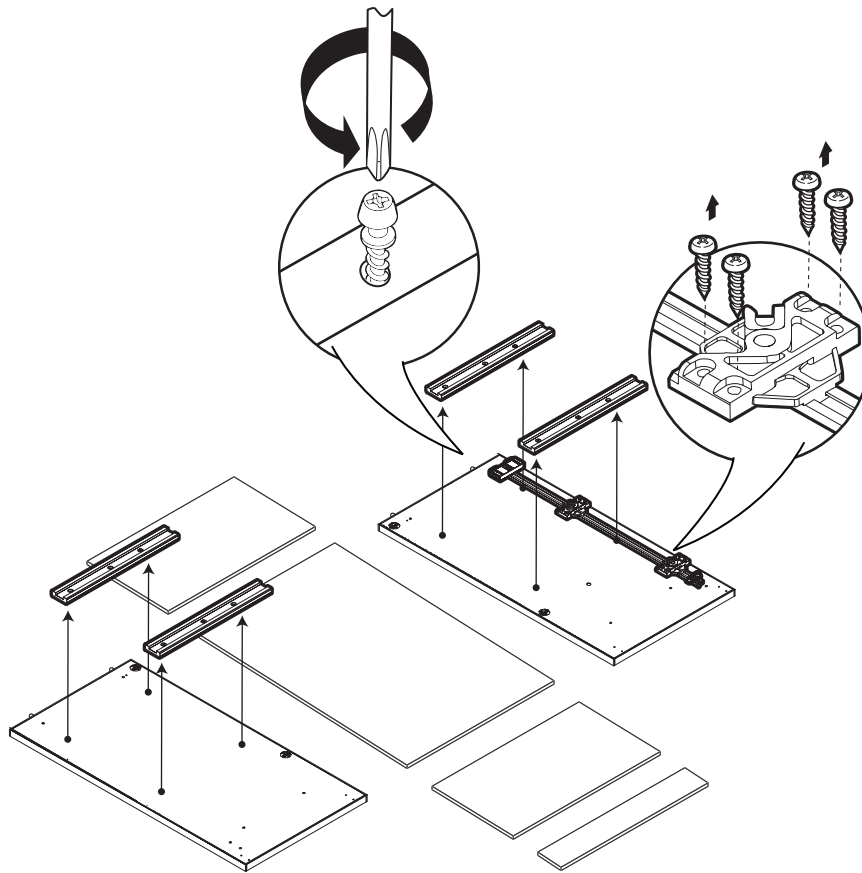

global

ZIRA

Storage Cabinet w/door & Cavity
2File Module w/door & Cavity

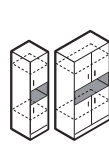
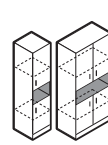
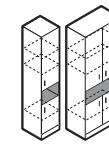
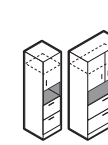
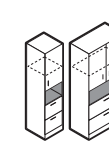
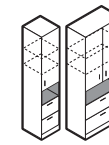
					
65"ht	72.5"ht	84"ht	65"ht	72.5"ht	84"ht
Z12...36L6SHCL/R	Z12...36L7SHCL/R	Z12...36L8SHCL/R	Z15...36L6ECL/R	Z15...36L7ECL/R	Z15...36L8ECL/R
Z12...36M6SHCL/R	Z12...36M7SHCL/R	Z12...36M8SHCL/R	Z15...36M6ECL/R	Z15...36M7ECL/R	Z15...36M8ECL/R
Z12...36S6SHCL/R	Z12...36S7SHCL/R	Z12...36S8SHCL/R	Z15...36S6ECL/R	Z15...36S7ECL/R	Z15...36S8ECL/R

Disassembly Instructions

TOOLS REQUIRED



WRENCH
Size #16 or 5/8"



PHILLIPS
Screwdriver size #2

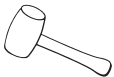



Rubber Mallet

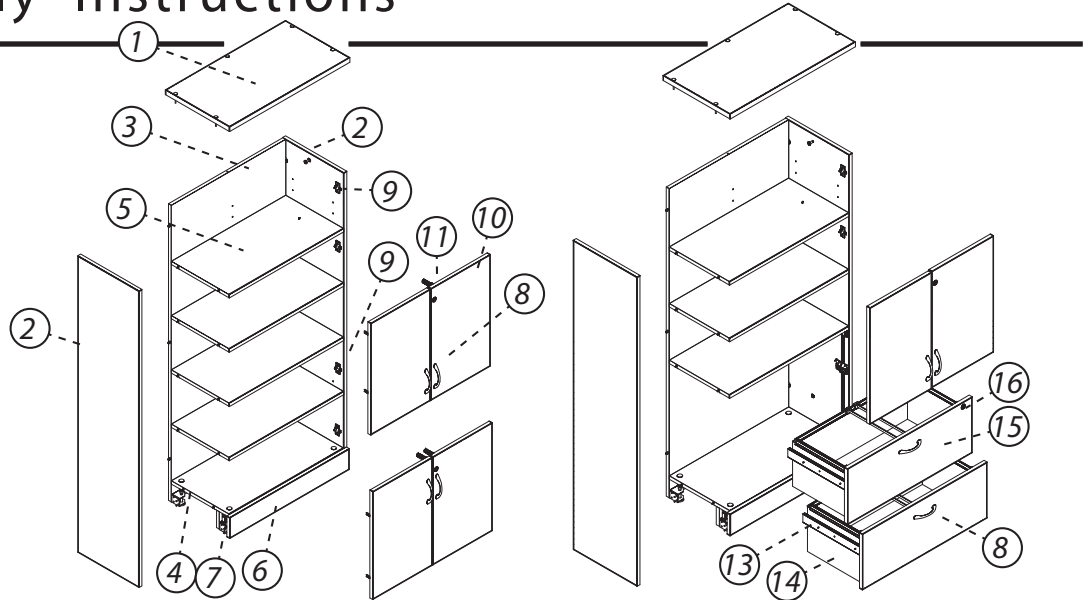

Safety Glasses

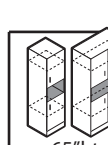
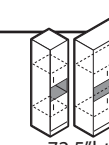
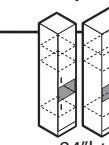
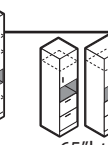

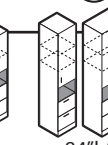
					
65"ht	72.5"ht	84"ht	65"ht	72.5"ht	84"ht

Please contact Global
Customer Care at
905-660-5101 for any
questions or concerns.

ITEM	DESCRIPTION	STORAGE CABINET W/DOOR & CAVITY			2 FILE WITH DOOR AND CAVITY			MATERIAL
		12"to21"W-30",36"W	12"to21"W-30",36"W	12"to21"W-30",36"W	15",16"W-30",36"W	15",16"W-30",36"W	15",16"W-30",36"W	
1	TOP	1	1	1	1	1	1	PARTICLEBOARD
2	SIDE	2	2	2	2	2	2	PARTICLEBOARD
3	BACK	1	1	1	1	1	1	PARTICLEBOARD
4	BOTTOM	1	1	1	1	1	1	PARTICLEBOARD
5	SHELF	4	4	5	3	3	4	PARTICLEBOARD
6	KICKBASE	1	1	1	1	1	1	PARTICLEBOARD
7	CORNER BRACKET W/LEVELER	4	4	4	4	4	4	STEEL
8	HANDLES	2 - 4	2 - 4	2 - 4	3 - 4	3 - 4	3 - 4	ALUMINIUM
9	HINGES	4 - 8	4 - 8	4 - 8	2 - 4	2 - 4	2 - 4	STEEL
10	DOOR	2 - 4	2 - 4	2 - 4	1 - 2	1 - 2	1 - 2	PARTICLEBOARD
11	DOOR LOCK MECHANISM	2	2	2	1	1	1	STEEL
12	SLIDES (BASE PLATE)				4	4	4	STEEL
13	SLIDES (INNER)				4	4	4	STEEL
14	DRAWER				2	2	2	MDF
15	DRAWER FRONT				2	2	2	PARTICLEBOARD
16	DRAWER LOCK MECHANISM				1	1	1	STEEL
17	SCREWS/BOLTS	78 - 96	78 - 96	84 - 103	116 - 130	116 - 130	122 - 137	STEEL

STEPS

- Remove door by pressing on back of hinges and pulling doors forward.
- Unscrew and remove hinges, handles and door lock mechanism from doors.
- For units with drawers: Remove Drawers by Fully Extending and Disengaging latch on each slide while pulling drawer out. Remove door by pressing on back of hinges and pulling doors forward.

- For units with drawers: On Drawer boxes, unscrew and remove slide channels, handles and door lock mechanism . Remove hanging file system.
- Turn unit. Pull kickbase and unscrew kick base connector. Unscrew door stopper.
- Untighten Blum and Rafix Connectors. Unscrew and remove corner brackets with leveler.
- Unscrew Blum and Rafix bolts. For units with drawers: Unscrew and remove glide channels and Drawer Lock Mechanism.

NOTE: Any alterations to listed components will void the manufacturer's warranty. The manufacturer will not be responsible for any damage or bodily harm caused by alterations in accordance with national or local electrical codes and manufacturer's specifications. In accordance with the manufacturer's policy of continual product improvement, the product presented in this document is subject to change without notice or obligation.

