

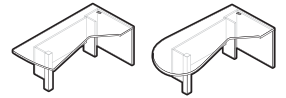

ZIRA

Extended Corner Island (Faux Ped)



Z4272...84EDF L/R
Z3660...72EDF L/R

Z4272...84EPF L/R
Z3660...72EPF L/R

Disassembly Instructions

TOOLS REQUIRED



WRENCH
Size #16 or 5/8"

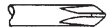

PHILLIPS
Screwdriver size #2

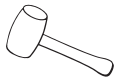

Rubber Mallet



Safety Glasses



ALLEN KEY
Size #5

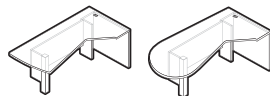
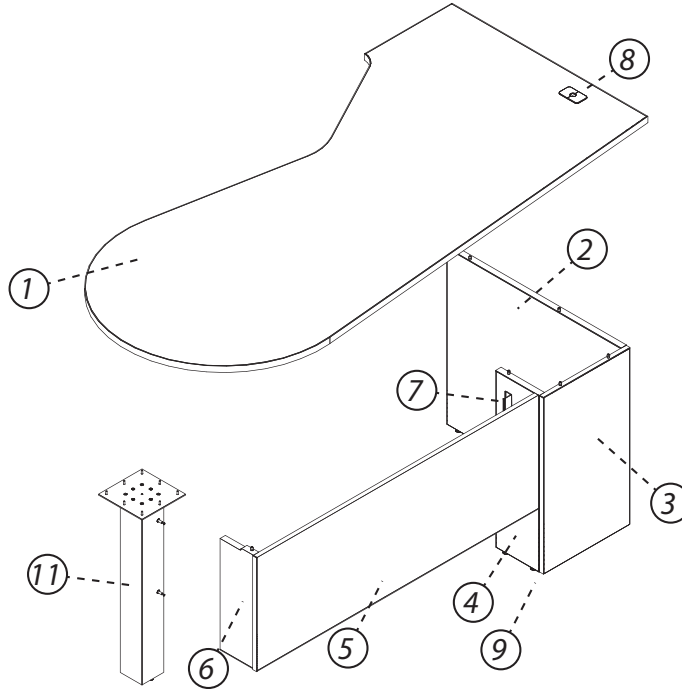

ITEM	DESCRIPTION	QUANTITIES						MATERIAL
		1	1					
1	TOP	1	1					PARTICLEBOARD
2	FAUX PED LARGE GABLE	1	1					PARTICLEBOARD
3	FAUX PED SHORT GABLE	1	1					PARTICLEBOARD
4	FAUX PED BACK	1	1					PARTICLEBOARD
5	MODESTY PANEL	1	1					PARTICLEBOARD
6	MODESTY SIDE	1	1					PARTICLEBOARD
7	ALUMINIUM CLEAT / COVER	1	1					ALUMINIUM
8	GROMMET	1	1					PLASTIC
9	LEVELER	6	6					STEEL/PLASTIC
10	SCREWS/BOLTS	34	34					STEEL
11	LEG	1	1					STEEL

Please contact Global Customer Care at 905-660-5101 for any questions or concerns.

STEPS

- Remove Aluminium Cleat Cover.
- Unscrew and remove leveler. Unscrew and remove Leg and aluminium cleat.
- Untighten Blum Connectors.
- Untighten Minifix Connectors in Modesty panel.
- Untighten Blum Connectors and released Faux ped.
- Untighten Blum Connectors from Faux ped.
- Unscrew Blum and Minifix bolts.

NOTE: Any alterations to listed components will void the manufacturer's warranty. The manufacturer will not be responsible for any damage or bodily harm caused by alterations in accordance with national or local electrical codes and manufacturer's specifications. In accordance with the manufacturer's policy of continual product improvement, the product presented in this document is subject to change without notice or obligation.

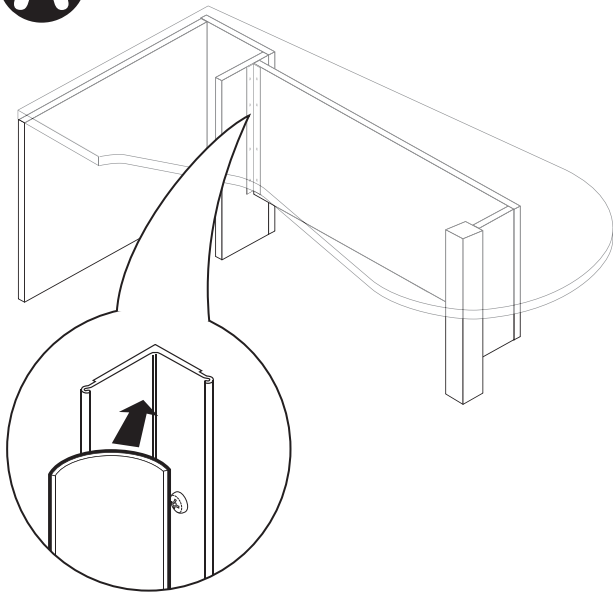
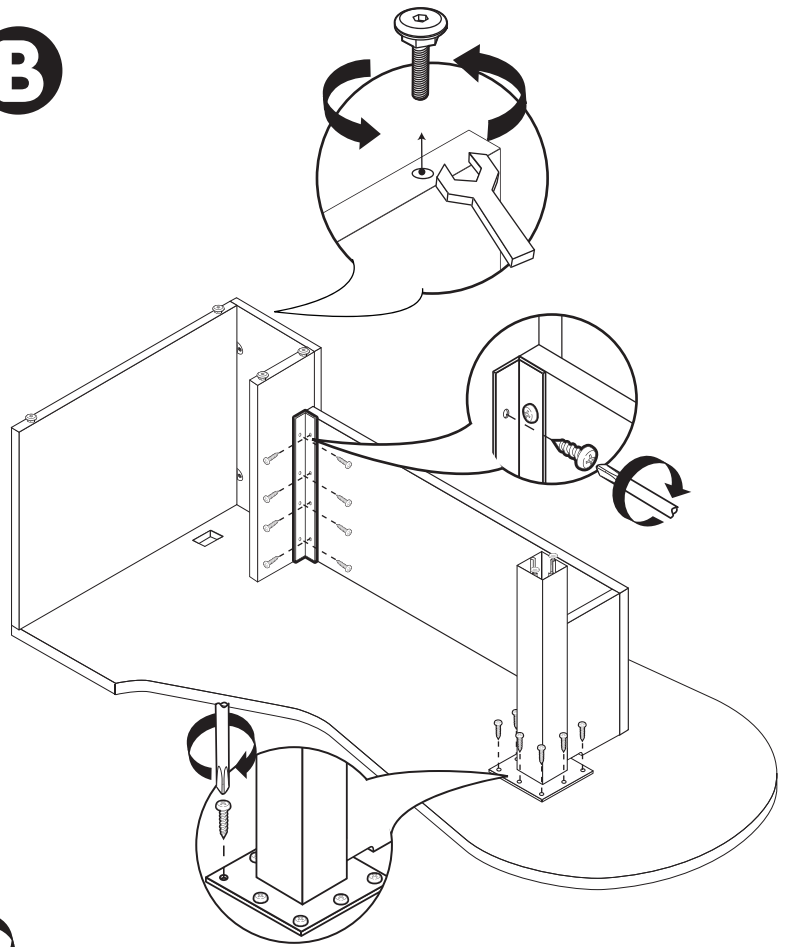
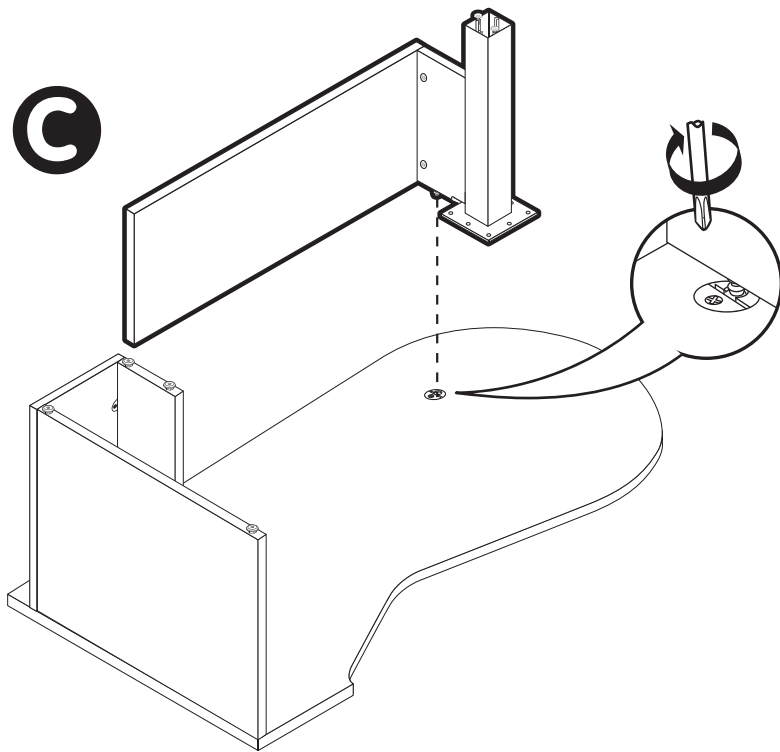
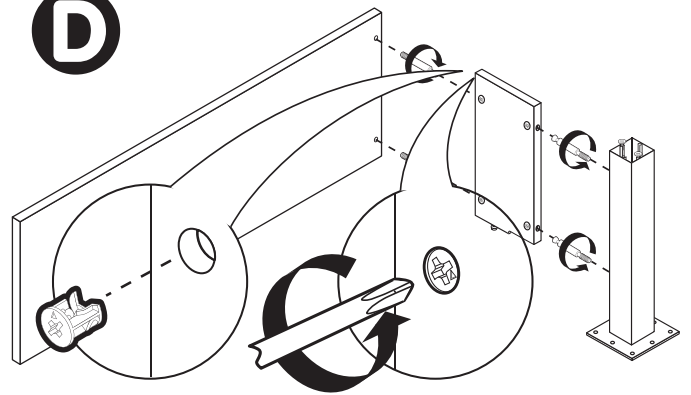
A**B****C****D**

E

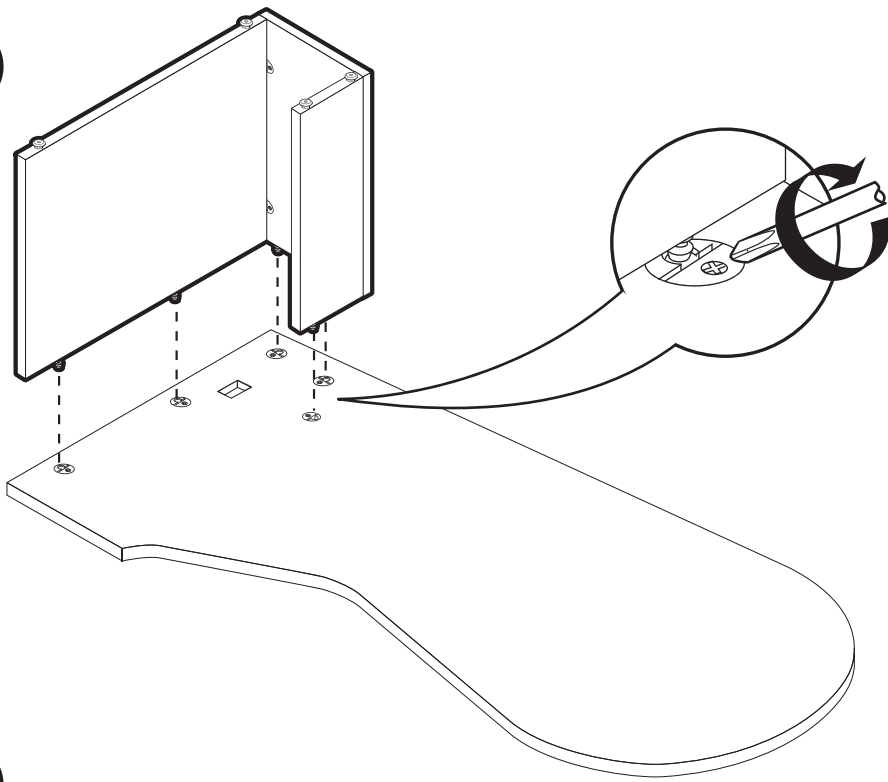

F

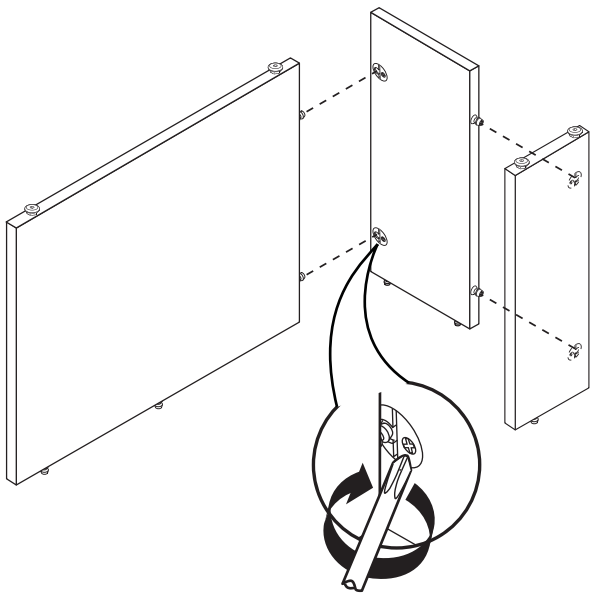

G

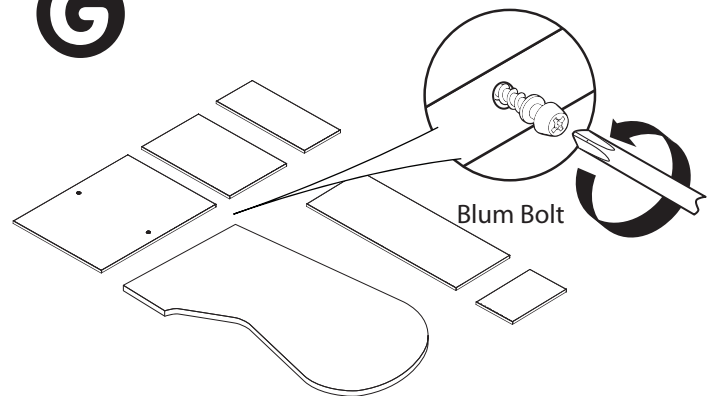



ZIRA

Extended Corner Island (T-Base)

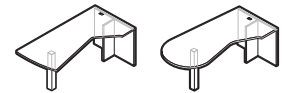

Z4272...84EDT L/R
Z3660...72EDT L/R

Z4272...84EPT L/R
Z3660...72EPT L/R

Disassembly Instructions

TOOLS REQUIRED



WRENCH
Size #16 or 5/8"

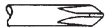

PHILLIPS
Screwdriver size #2

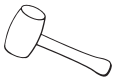

Rubber Mallet



Safety Glasses



ALLEN KEY
Size #5

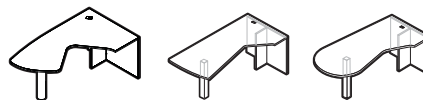
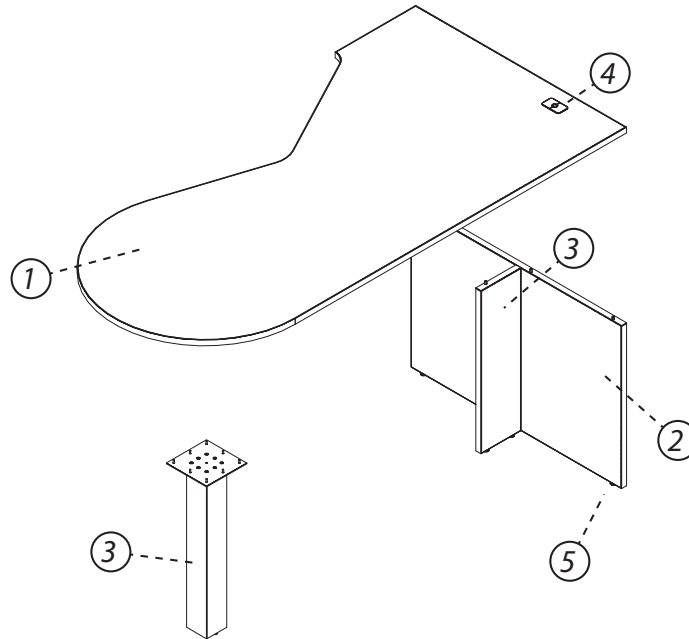

ITEM	DESCRIPTION	QUANTITIES						MATERIAL
1	TOP		1	1	1			PARTICLEBOARD
2	GABLE		2	2	2			PARTICLEBOARD
3	"T" SUPPORT		1	1	1			PARTICLEBOARD
4	GROMMET		2	2	2			PLASTIC
5	LEVELER		4	4	4			STEEL/PLASTIC
6	SCREWS/BOLTS		18	18	18			STEEL
7	LEG		6	6	6			STEEL

Please contact Global Customer Care at 905-660-5101 for any questions or concerns.

STEPS

- Turn unit. Untighten Blum Connectors. Unscrew and remove leveler. Unscrew and remove Leg.
- Untighten Blum Connector from support panel.
- Unscrew Blum bolts.

NOTE: Any alterations to listed components will void the manufacturer's warranty. The manufacturer will not be responsible for any damage or bodily harm caused by alterations in accordance with national or local electrical codes and manufacturer's specifications. In accordance with the manufacturer's policy of continual product improvement, the product presented in this document is subject to change without notice or obligation.

A

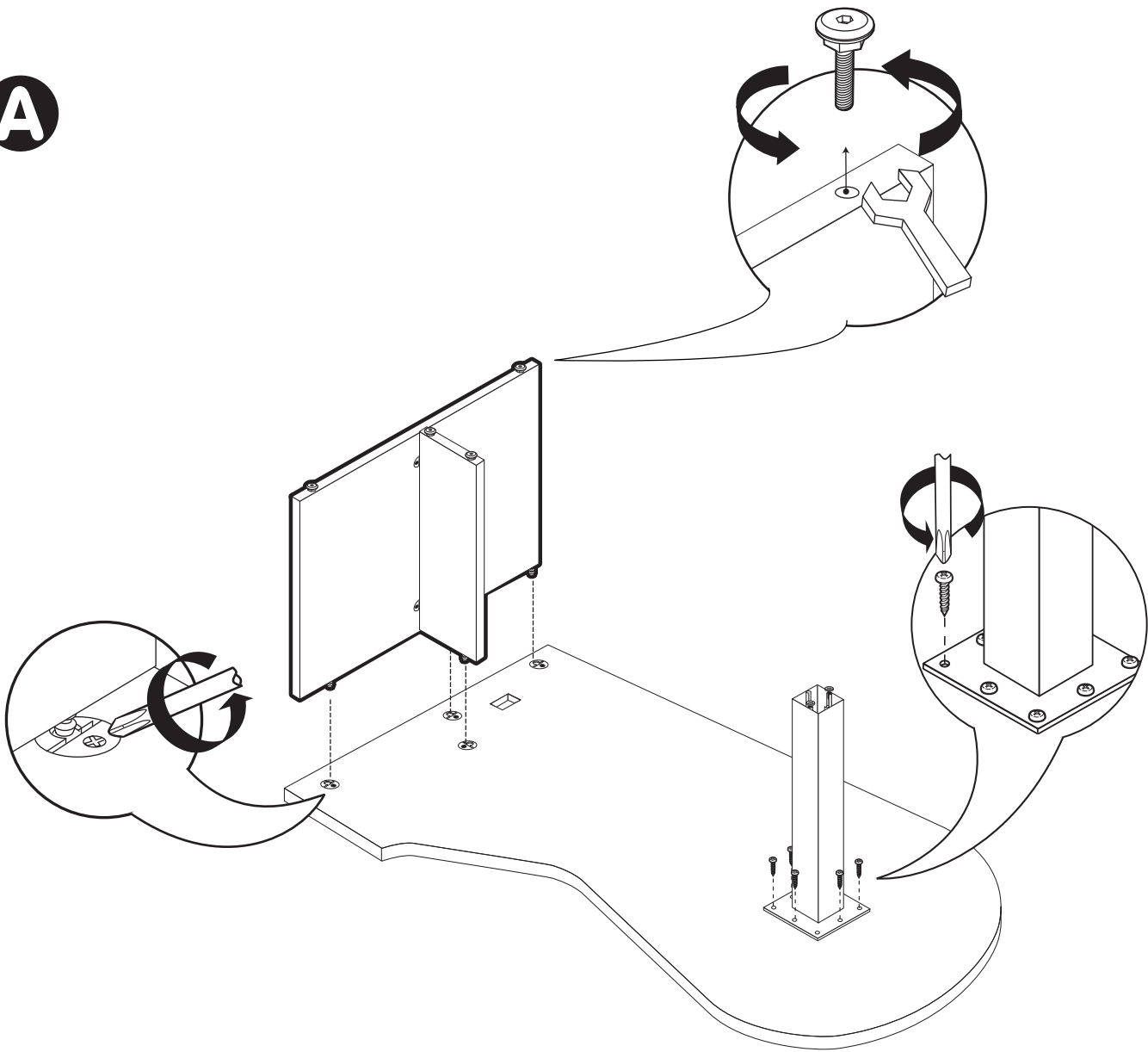

B

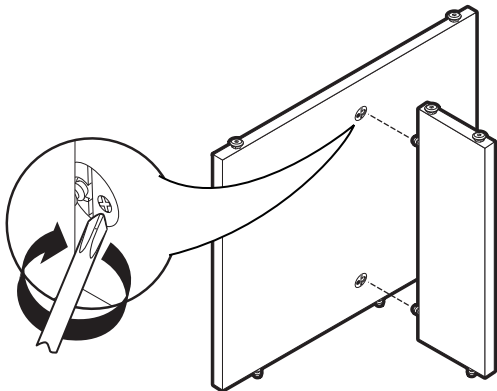

C

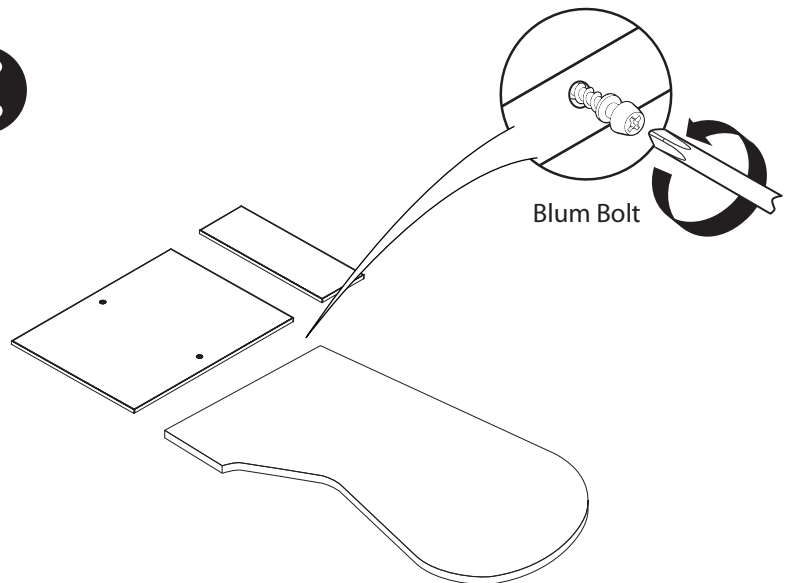



ZIRA

Extended Corner Island (Recessed and Flush)

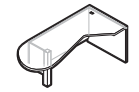
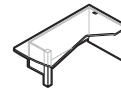
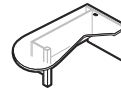
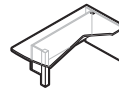

Recessed

Z4272...84EDR L/R
Z3660...72EDR L/R

Z4272...84EPR L/R
Z3660...72EPR L/R

Flush

Z4272...84EDM L/R
Z3660...72EDM L/R

Z4272...84EPM L/R
Z3660...72EPM L/R

Disassembly Instructions

TOOLS REQUIRED



WRENCH
Size #16 or 5/8"

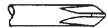

PHILLIPS
Screwdriver size #2

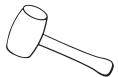

Rubber Mallet



Safety Glasses



ALLEN KEY
Size #5

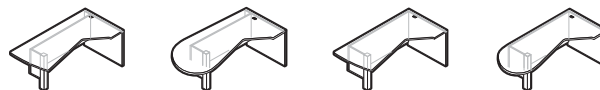
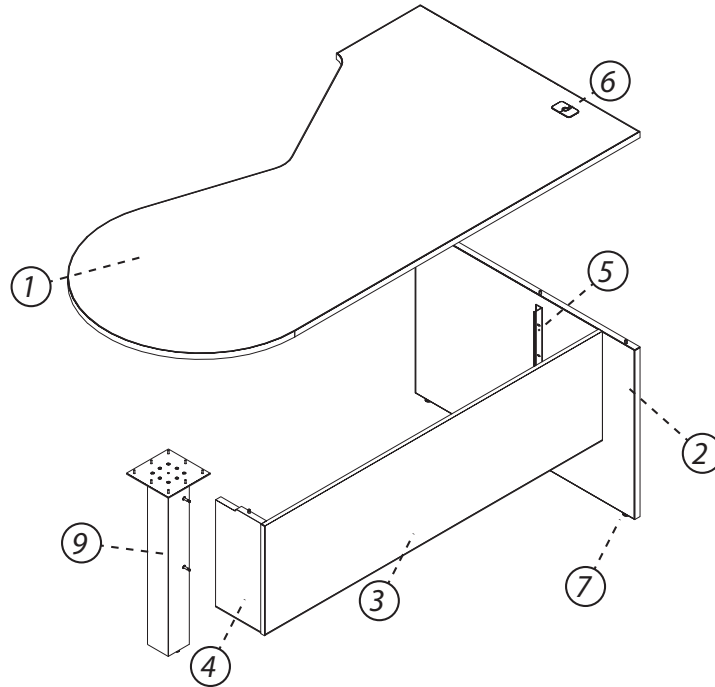

ITEM	DESCRIPTION	QUANTITIES				MATERIAL
1	TOP	1	1	1	1	PARTICLEBOARD
2	GABLE	1	1	1	1	PARTICLEBOARD
3	MODESTY PANEL	1	1	1	1	PARTICLEBOARD
4	MODESTY SIDE	1	1	1	1	PARTICLEBOARD
5	ALUMINIUM CLEAT / COVER	1	1	1	1	ALUMINIUM
6	GROMMET	1	1	1	1	PLASTIC
7	LEVELER	4	4	4	4	STEEL/PLASTIC
8	SCREWS/BOLTS	28	28	28	28	STEEL
9	LEG	1	1	1	1	STEEL

Please contact Global Customer Care at 905-660-5101 for any questions or concerns.

STEPS

- Remove Aluminium Cleat Cover.
- Unscrew and remove leveler. Unscrew and remove aluminium cleat and Leg with modesties.
- Untighten Blum Connectors.
- Untighten Minifix Connectors in Modesty panel.
- Unscrew Blum and Minifix bolts .

NOTE: Any alterations to listed components will void the manufacturer's warranty. The manufacturer will not be responsible for any damage or bodily harm caused by alterations in accordance with national or local electrical codes and manufacturer's specifications. In accordance with the manufacturer's policy of continual product improvement, the product presented in this document is subject to change without notice or obligation.

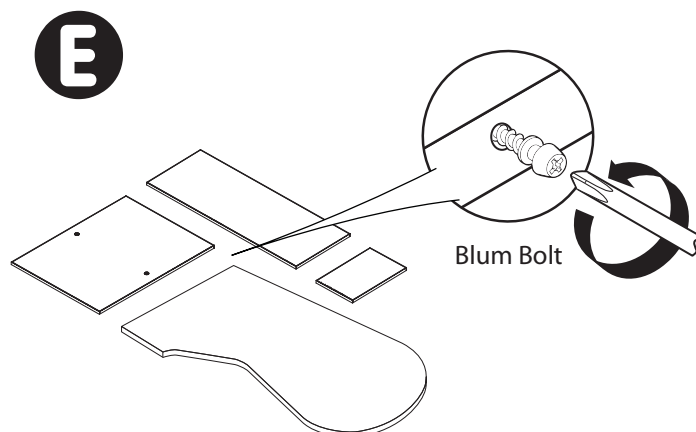
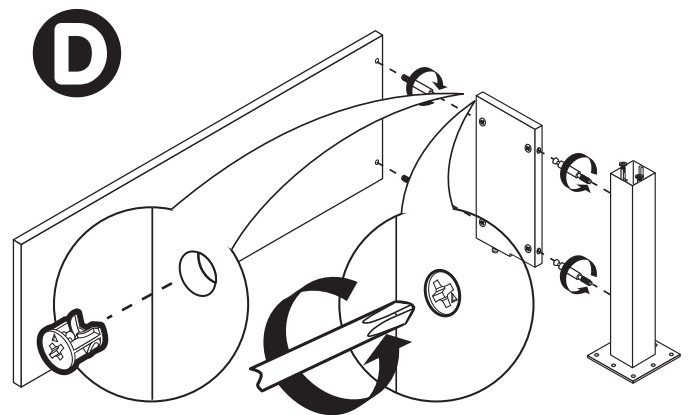
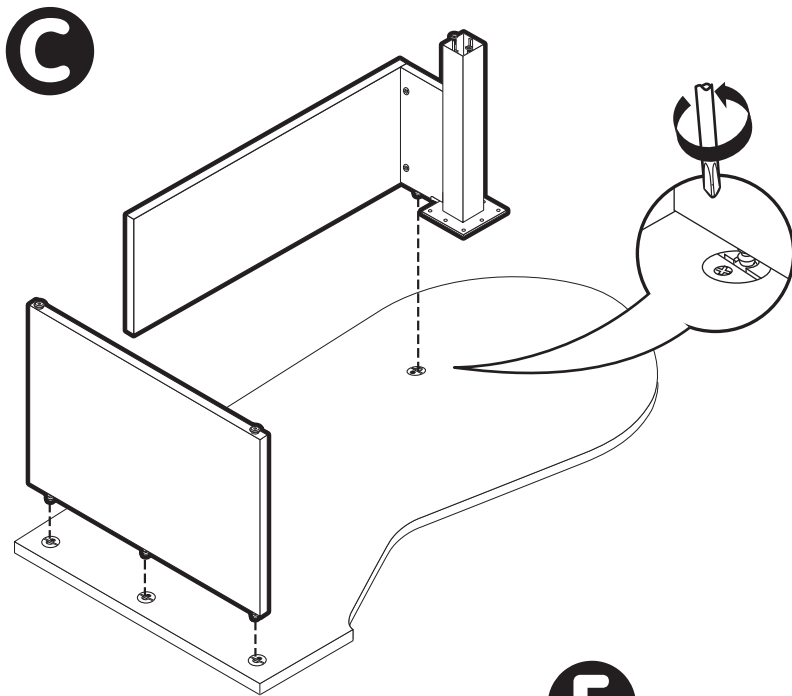
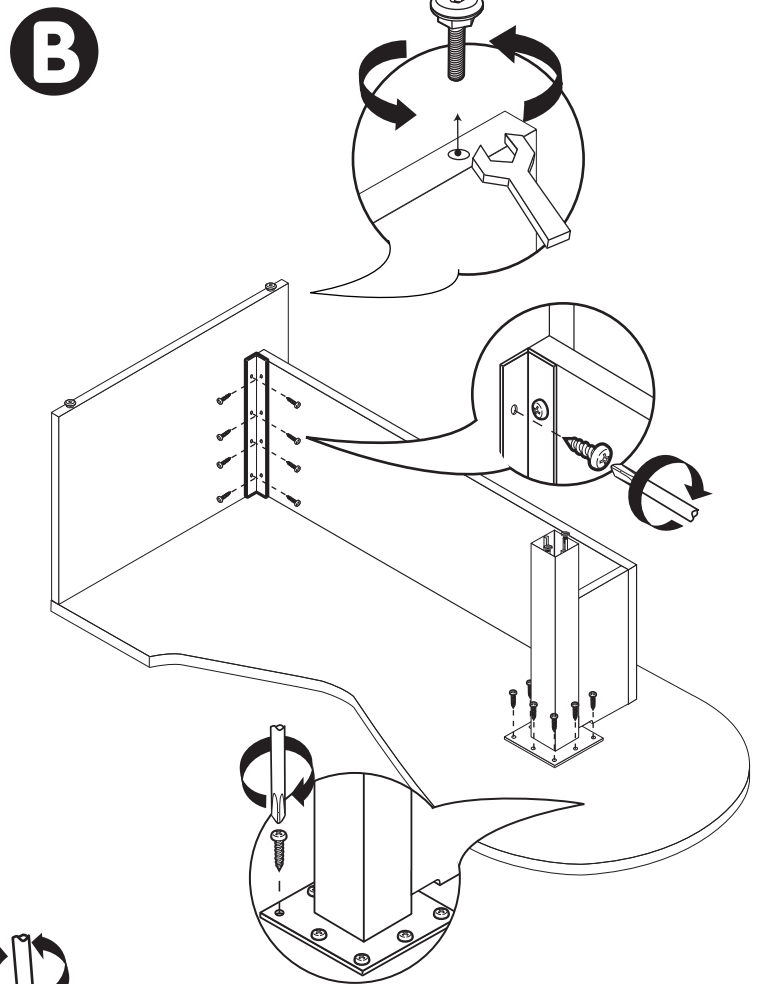
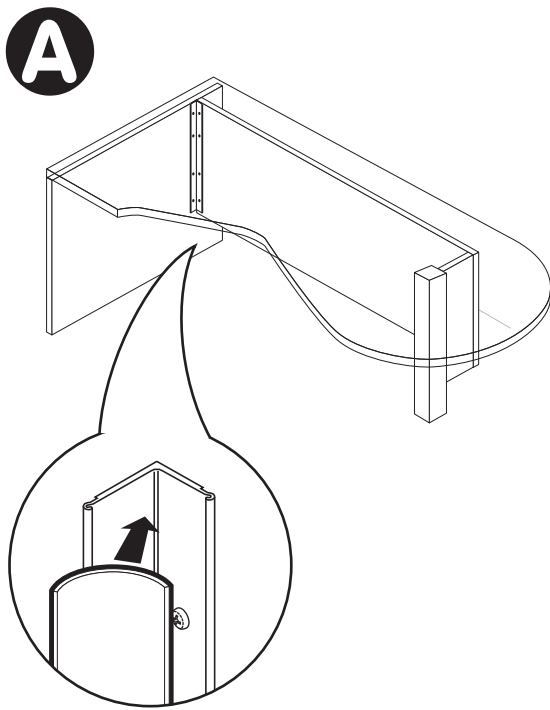



ZIRA

Freestanding Tables
Connectable Tables

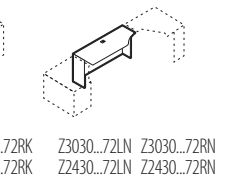
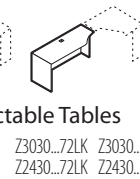
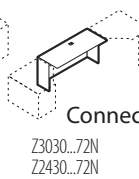
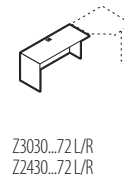

Disassembly Instructions

TOOLS REQUIRED



WRENCH
Size #16 or 5/8"

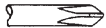

PHILLIPS
Screwdriver size #2

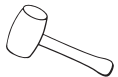

Rubber Mallet



Safety Glasses

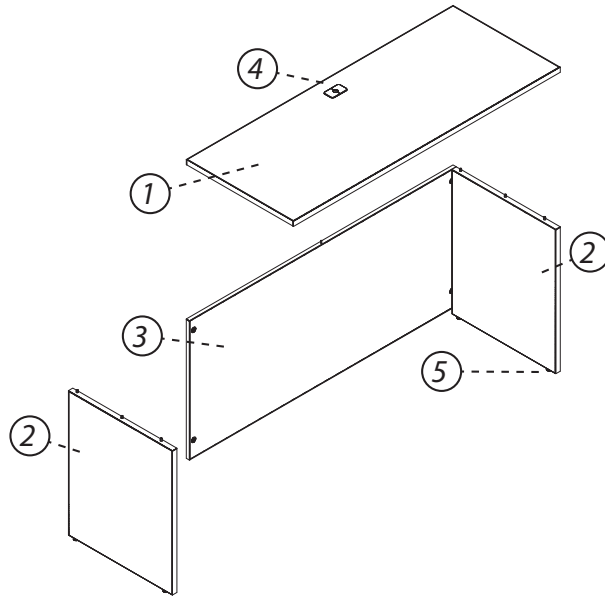

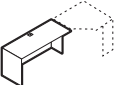
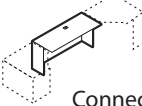
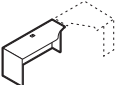
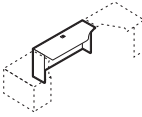
		<div><div></div><div></div><div></div><div></div><div></div></div> <div>Freestanding</div> <div>Connectable Tables</div>						
ITEM	DESCRIPTION	QUANTITIES					MATERIAL	
1	TOP	1	1	1	1	1	PARTICLEBOARD	
2	SIDE	2	2	2	2	2	PARTICLEBOARD	
3	BACK	1	1	1	1	1	PARTICLEBOARD	
4	GROMMET	1	1	1	1	1	PLASTIC	
5	LEVELER	4	4	4	4	4	STEEL/PLASTIC	
6	SCREWS/BOLTS	10	17	16	17	16	STEEL	

Please contact Global Customer Care at 905-660-5101 for any questions or concerns.

STEPS

A Turn unit. Untighten Blum Connectors.
Unscrew and remove leveler.

B Unscrew Blum bolts.

NOTE: Any alterations to listed components will void the manufacturer's warranty. The manufacturer will not be responsible for any damage or bodily harm caused by alterations in accordance with national or local electrical codes and manufacturer's specifications. In accordance with the manufacturer's policy of continual product improvement, the product presented in this document is subject to change without notice or obligation.

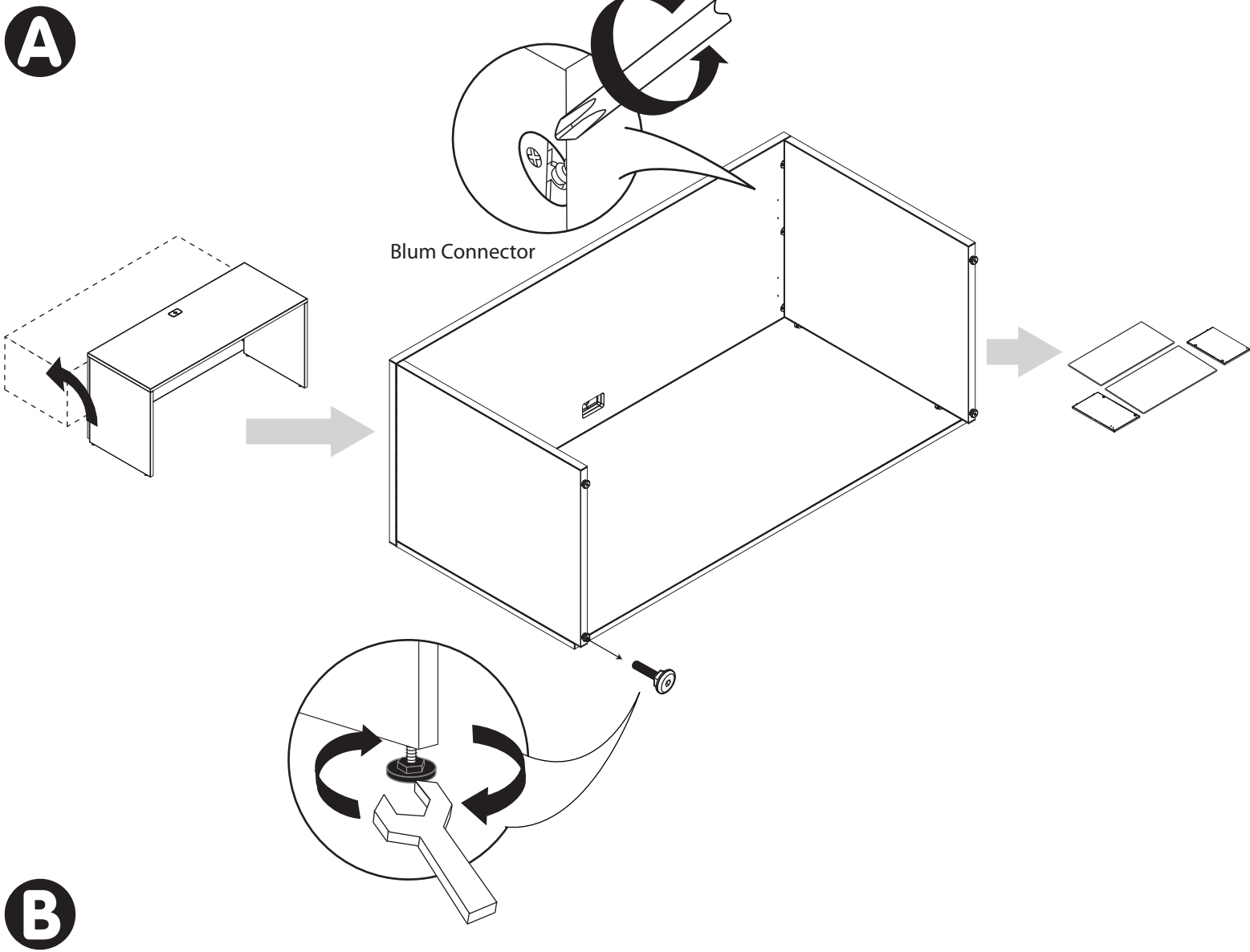



ZIRA

"P"/"D" Island w/ "H" Base

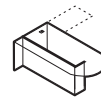

Z3672FI L/R
Z3060...66FI L/R

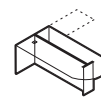

Z3672FIC
Z3060...66FIC

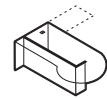

Z3660...72PL/R

Disassembly Instructions

TOOLS REQUIRED



WRENCH
Size #16 or 5/8"

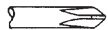

PHILLIPS
Screwdriver size #2

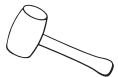

Rubber Mallet



Safety Glasses



ALLEN KEY
Size #5

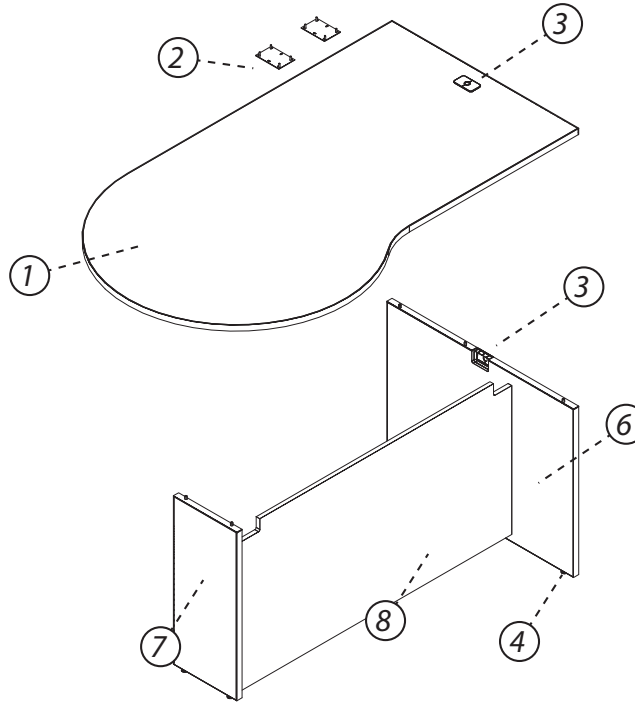

ITEM	DESCRIPTION	QUANTITIES						MATERIAL
		1	2	3	4	5	6	
1	TOP	1	1	1				PARTICLEBOARD
2	BRACKET/PLATE	2	2	2				STEEL
3	GROMMET	2	2	2				PLASTIC
4	LEVELER	4	4	4				STEEL/PLASTIC
5	SCREWS/BOLTS	17	17	17				STEEL
6	GABLE WIDE	1	1	1				PARTICLEBOARD
7	GABLE NARROW	1	1	1				PARTICLEBOARD
8	BACK	1	1	1				PARTICLEBOARD

Please contact Global Customer Care at 905-660-5101 for any questions or concerns.

STEPS

- Unscrew and remove brackets/plate.
- Unscrew and remove Leg and Leveler.
Untighten Blum Connectors.
- Unscrew Blum bolts.

NOTE: Any alterations to listed components will void the manufacturer's warranty. The manufacturer will not be responsible for any damage or bodily harm caused by alterations in accordance with national or local electrical codes and manufacturer's specifications. In accordance with the manufacturer's policy of continual product improvement, the product presented in this document is subject to change without notice or obligation.

A

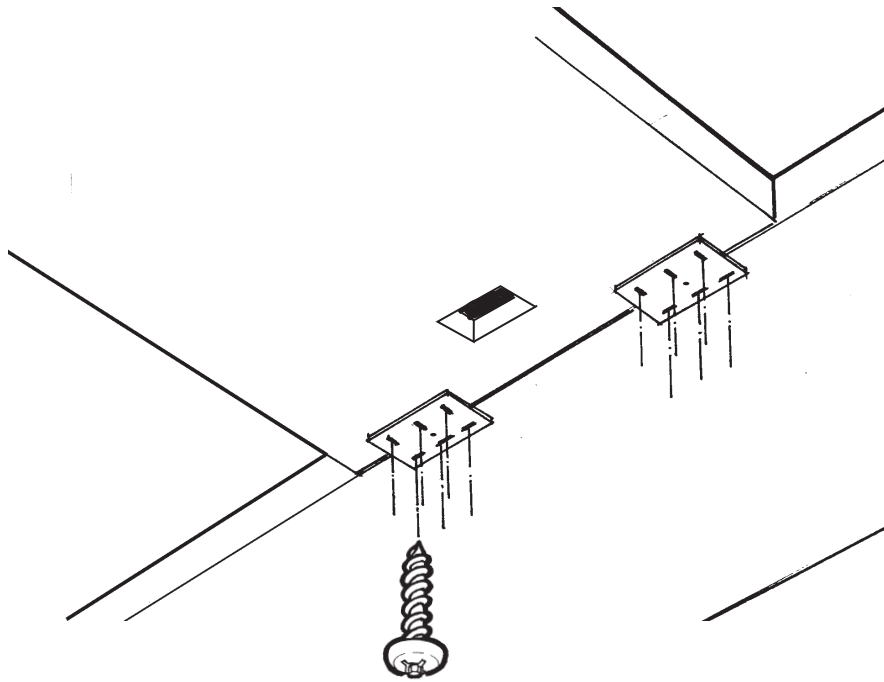

B

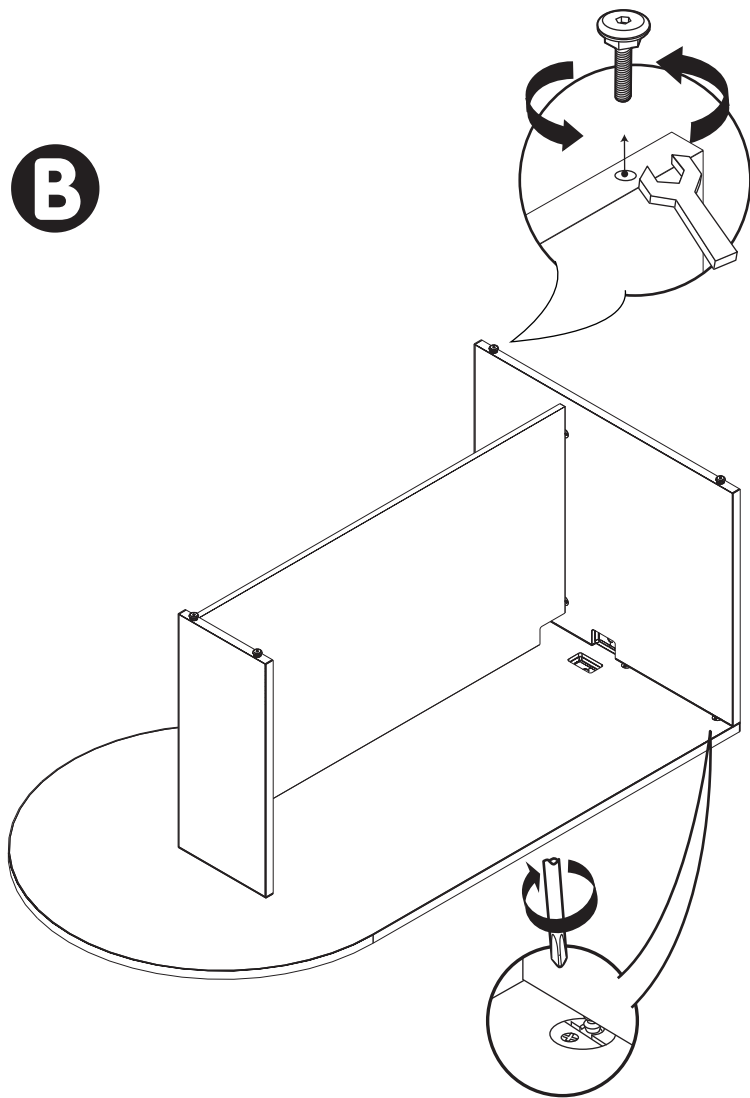

C

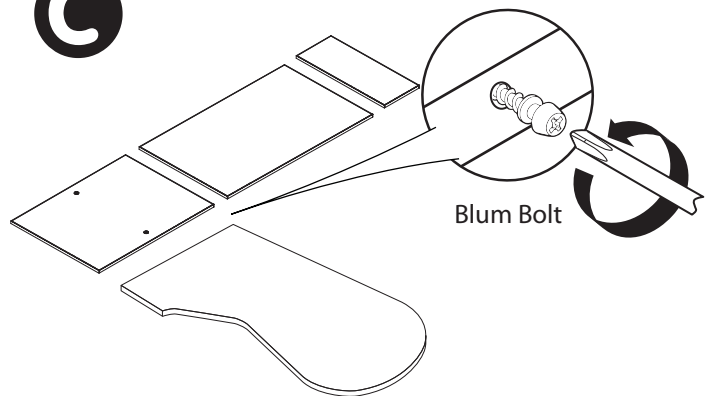



ZIRA

"P"/"D" Island w/ "T" Base

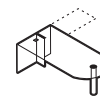

Z3672FI

Z3060...72FI

Z2448...66FI

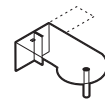

Z3660...72FPL/R

Disassembly Instructions

TOOLS REQUIRED



WRENCH

Size #16 or 5/8"

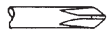

PHILLIPS

Screwdriver size #2

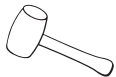

Rubber Mallet



Safety Glasses



ALLEN KEY

Size #5

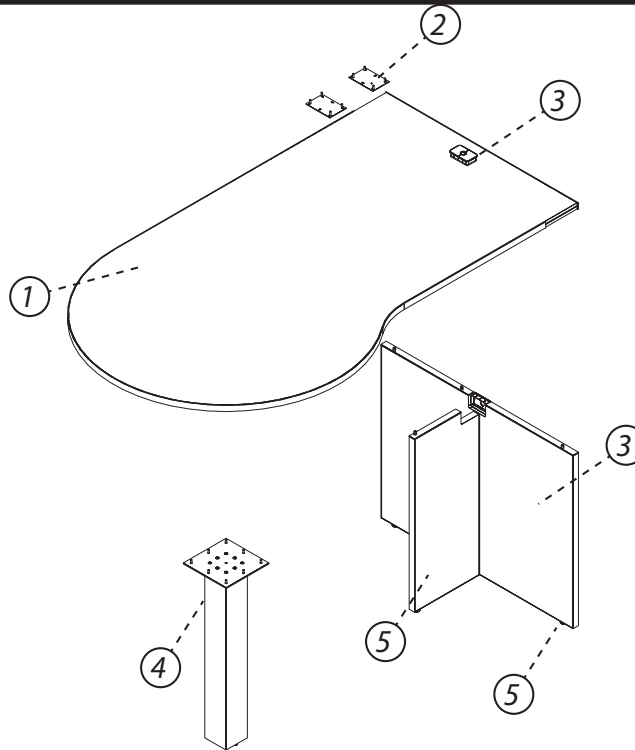

ITEM	DESCRIPTION	QUANTITIES						MATERIAL
1	TOP	1	1					PARTICLEBOARD
2	BRACKET/PLATE	2	2					STEEL
3	GROMMET	2	2					PLASTIC
4	LEG	1	1					STEEL
5	LEVELER	2	2					STEEL/PLASTIC
6	SCREWS/BOLTS	26	26					STEEL
7	"T" BASE PANEL 1	1	1					PARTICLEBOARD
8	"T" BASE PANEL 2	1	1					PARTICLEBOARD

Please contact Global Customer Care at 905-660-5101 for any questions or concerns.

STEPS

- Unscrew and remove brackets/plate.
- Unscrew and remove Leg and Leveler.
Untighten Blum Connectors.
- Unscrew Blum bolts.

NOTE: Any alterations to listed components will void the manufacturer's warranty. The manufacturer will not be responsible for any damage or bodily harm caused by alterations in accordance with national or local electrical codes and manufacturer's specifications. In accordance with the manufacturer's policy of continual product improvement, the product presented in this document is subject to change without notice or obligation.

A

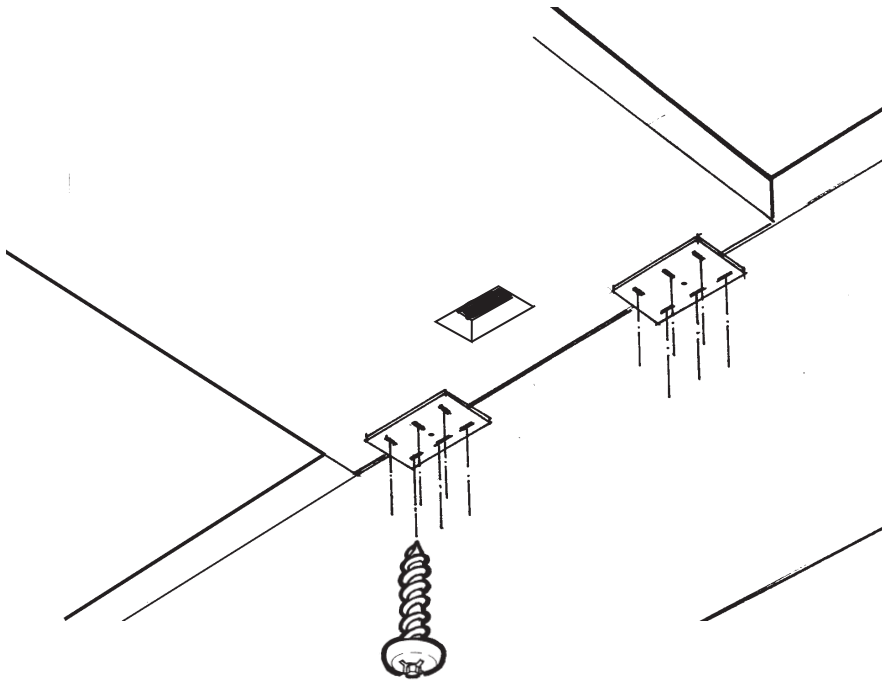

B

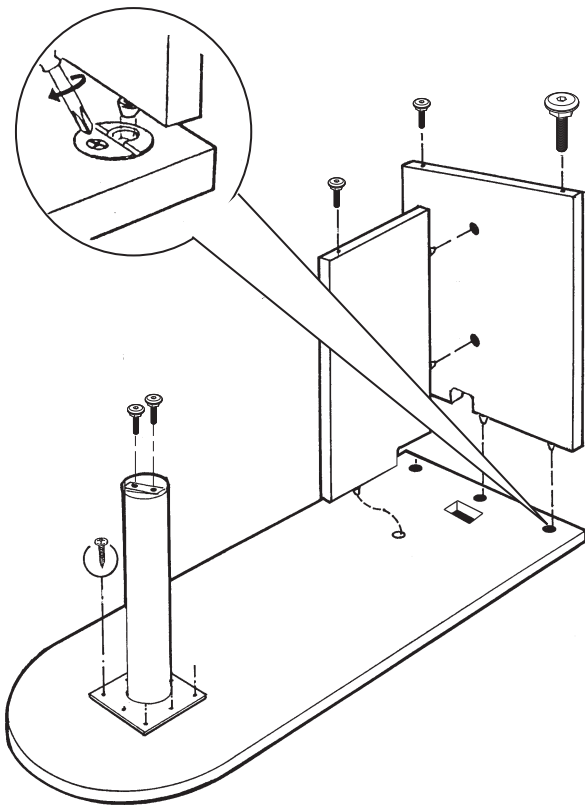

C

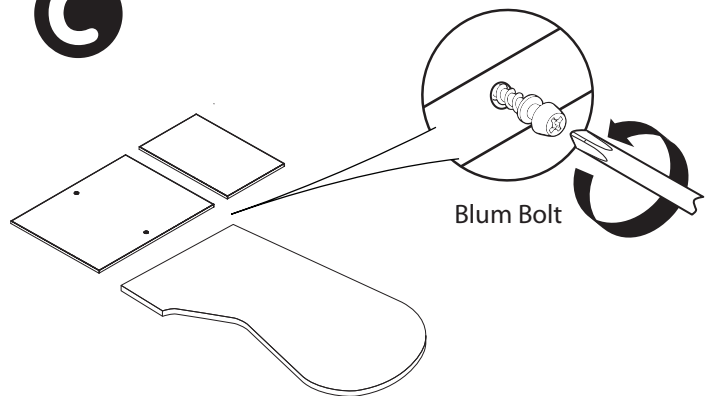



ZIRA

"P"/"D"/Radius Spanner Island

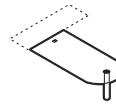

Z3672I
Z3060...66I
Z2448...66I

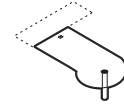

Z3660...72IP L/R



Z62RS
Z50RS
Z42RS
Z60RS
Z48RS
Z40RS

Disassembly Instructions

TOOLS REQUIRED



WRENCH
Size #16 or 5/8"

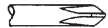

PHILLIPS
Screwdriver size #2

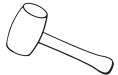

Rubber Mallet



Safety Glasses



ALLEN KEY
Size #5

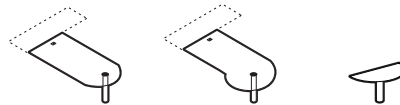
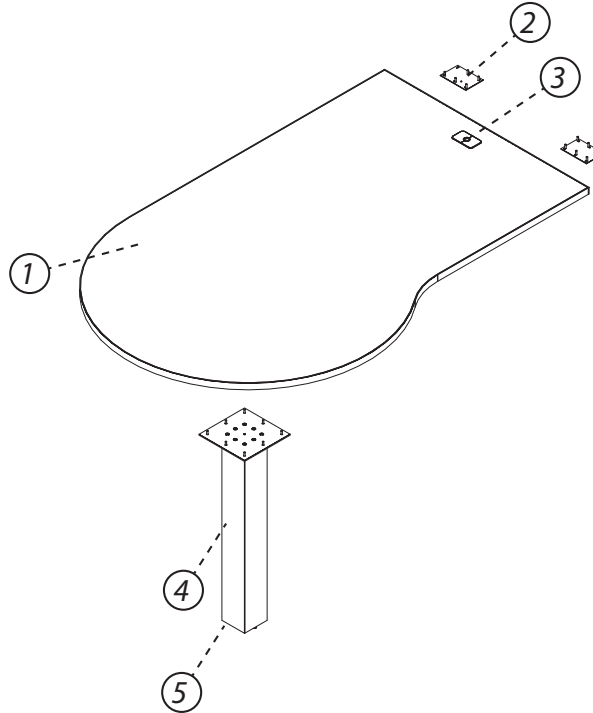

ITEM	DESCRIPTION	QUANTITIES					MATERIAL
1	TOP	1	1	1			PARTICLEBOARD
2	BRACKET/PLATE	2	2	2			STEEL
3	GROMMET	1	1	1			PLASTIC
4	LEG	1	1	1			STEEL
5	LEVELER	2	2	2			STEEL/PLASTIC
6	SCREWS/BOLTS	24	24	24			STEEL

Please contact Global Customer Care at 905-660-5101 for any questions or concerns.

STEPS

- Unscrew and remove brackets/plate.
- Unscrew and remove Leg and Leveler.

NOTE: Any alterations to listed components will void the manufacturer's warranty. The manufacturer will not be responsible for any damage or bodily harm caused by alterations in accordance with national or local electrical codes and manufacturer's specifications. In accordance with the manufacturer's policy of continual product improvement, the product presented in this document is subject to change without notice or obligation.

A

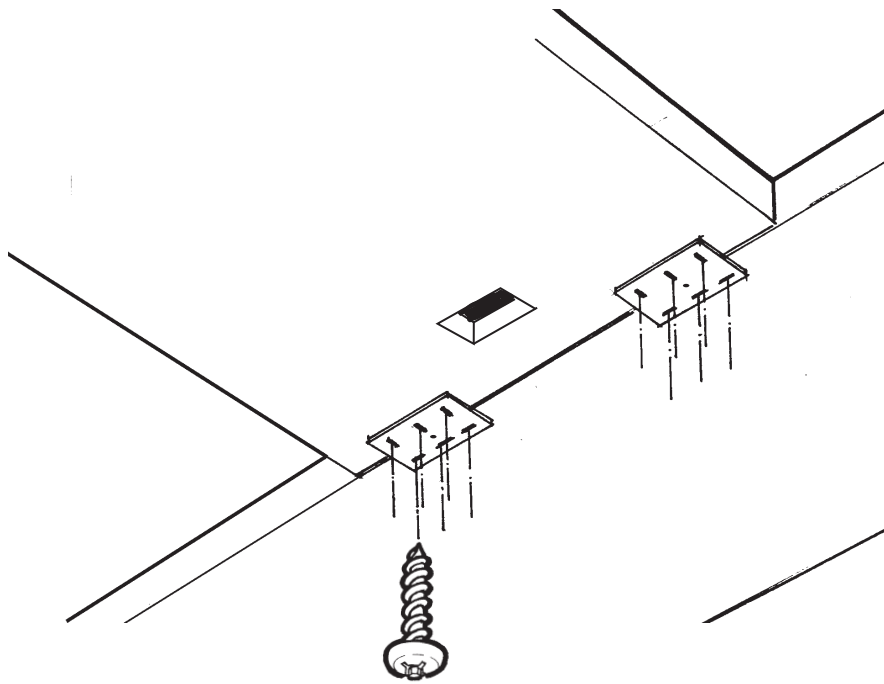

B

