

ABxx(LB/HB) Freestanding Bookcase

Item#	Description	Qty.	Material
1	BASE BOTTOM	1	MDF
2	BOTTOM	1	PARTICLE BOARD
3	TOP	1	PARTICLE BOARD
4	GABLE LH	1	PARTICLE BOARD
5	GABLE RH	1	PARTICLE BOARD
6	DIVIDER	1	PARTICLE BOARD
7	FIXED SHELF	1	PARTICLE BOARD
8	FIXED SHELF	2	PARTICLE BOARD
9	BACK	2	MELAMINE
10	DOOR	2	PARTICLE BOARD
11	ADJ. SHELF	2	PARTICLE BOARD
12	MAGIC WIRE	4	STEEL
13	CAM DOWEL	14	PLASTIC
14	LEGS	4	SOLID WOOD
15	SHELF PIN	4	STEEL
16	CONFIRMAT	13	STEEL
17	TITUS CAM	6	STEEL
18	TITUS SCREW	6	STEEL
19	DOWEL PIN	4	WOOD
20	INSERT	4	STEEL
21	GLIDE	4	STEEL, PLASTIC(PVC#3)
22	DOOR HINGE	4	STEEL
23	CAM SCREW	14	STEEL

DISASSEMBLY INSTRUCTIONS

Product designed for disassembly in a reasonable time frame.

- a. Remove hinges(22) to detach doors(10)
- b. Pull out the fixed shelf(8)(7) and adj. shelf(11)
- c. Unscrew the Cam screw(23) from top(3)
- d. Unscrew Titus CAM(17) from Back(9)
- e. Unscrew confirmat(16) from back(9)
- f. Dismantle glides(21), legs(14), dowel pin(19)and unscrew the base bottom screws
- g. Unscrew confirmat(16) from bottom(2)

Please contact your Descor Service Representative at 905-470-0010 for any questions or concerns

REQUIRED TOOLS

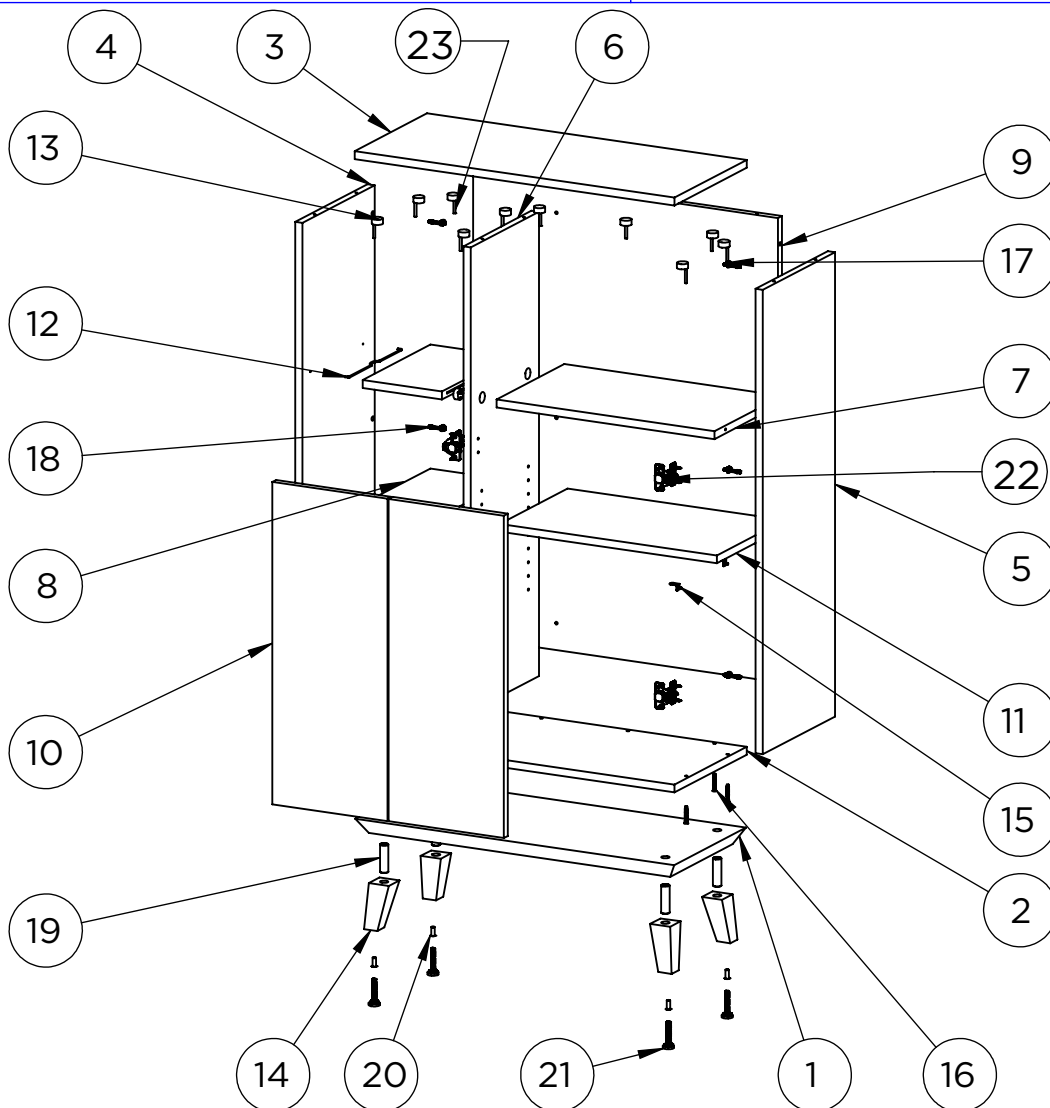
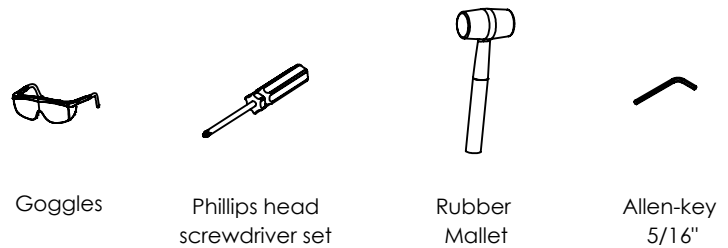

NOTE: Any alterations to listed components will void the manufacturer's warranty. The manufacturer will not be responsible for any damage or bodily harm caused by alterations in accordance with national or local electrical codes and manufacturer's applications. In accordance with the manufacturer's policy of continual product improvement, the product presented in this document is subject to change without notice or obligation.