

PSMA1 + PSMA2

EVMA1/EVMA2 + GAMA1/GAMA2

Mini Slide Monitor Arm Installation Guide

Effective June 2022



G7 MONITOR ARMS
productivity solutions



MONITOR ARM INSTALLATION GUIDE

PSMA1 OVERVIEW

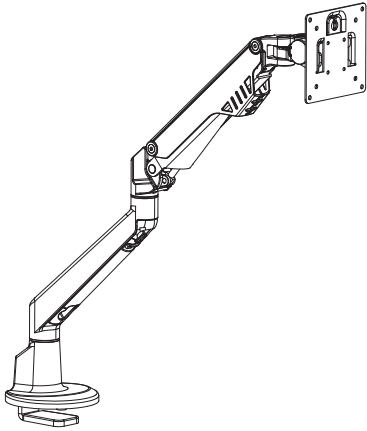

LOADING CAPACITY: 4.4 - 19.8 lbs. per monitor
SCREEN SIZE: 17" - 34"

PSMA1 PARTS LIST

Components

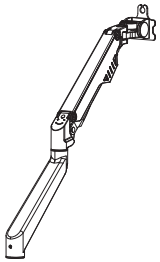

1. Arm (x1)

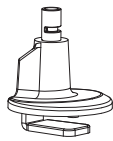

2. Base (x1)

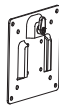

3. VESA Plate (x1)

Parts in hardware pack



A. M4 x 9 Screw (x4)



B. M4 x 12 Screw (x4)



C. 3mm Allen Key (x1)



D. 5mm Allen Key (x1)



E. 180° lock-out screw (x1)

WARNING: Hold the arm tightly while removing the strap. The arm is under tension and can potentially snap loose, causing injury.

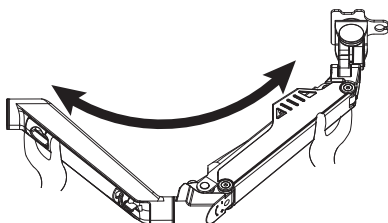

PSMA2 OVERVIEW

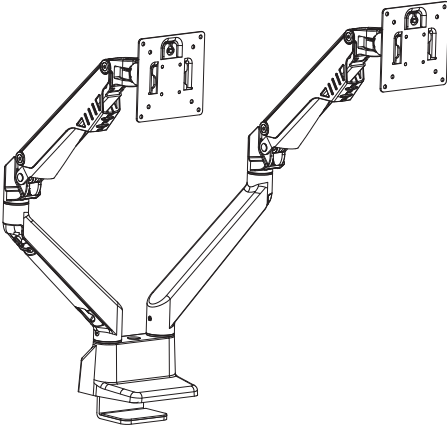

LOADING CAPACITY: 4.4 - 19.8 lbs. per monitor
SCREEN SIZE: 17" - 34"

PSMA2 PARTS LIST

Components

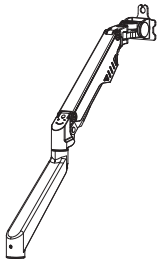

1. Arm (x2)

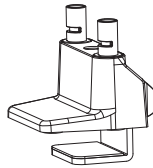

2. Base (x1)

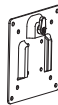

3. VESA Plate (x2)

Parts in hardware pack



A. M4 x 9 Screw (x8)



B. M4 x 12 Screw (x8)



C. 3mm Allen Key (x1)



D. 5mm Allen Key (x1)



E. 180° lock-out screw (x2)

Parts in grommet installation pack

(used for optional grommet installation)



F. Grommet Screw (x1)

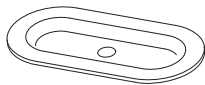

G. Fixing Plate (x1)

WARNING: Hold the arm tightly while removing the strap. The arm is under tension and can potentially snap loose, causing injury.

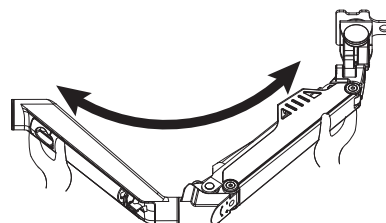

MONITOR ARM INSTALLATION GUIDE

STEP 1 - SELECT A BASE INSTALLATION OPTION

Option 1a - Clamp method

PSMA2 (EVMA2/GAMA2) shown. Instructions are applicable for both **PSMA1 (EVMA1/GAMA1)** and **PSMA2 (EVMA2/GAMA2)** monitor arms.

 Thickness of worksurface: 1" - 1.75"

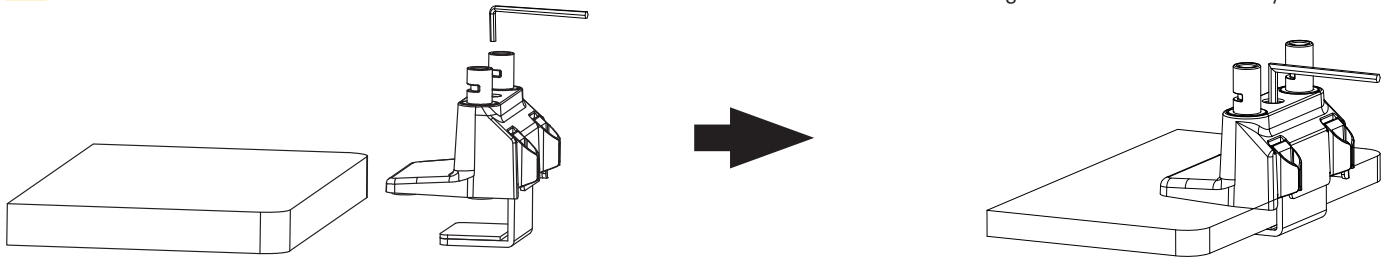

Option 1b - Grommet method - PSMA1 (EVMA1/GAMA1) only

Loosen with 5mm Allen key

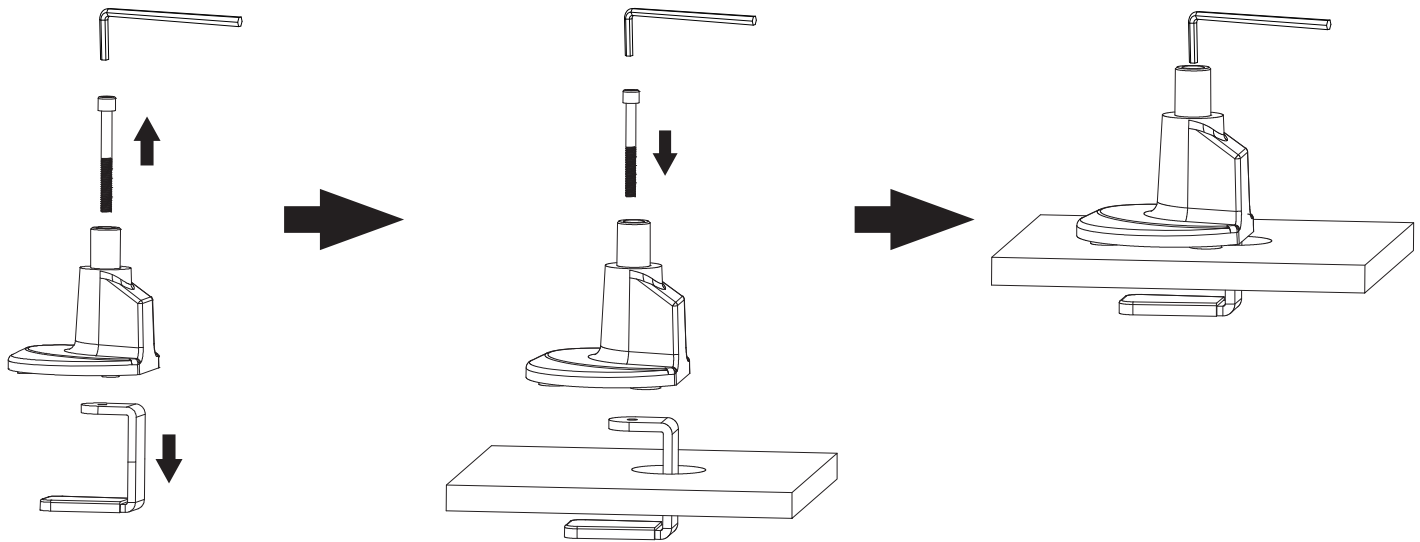

Option 1c - Grommet method - PSMA2 (EVMA2/GAMA2) only

Tighten with 5mm Allen key

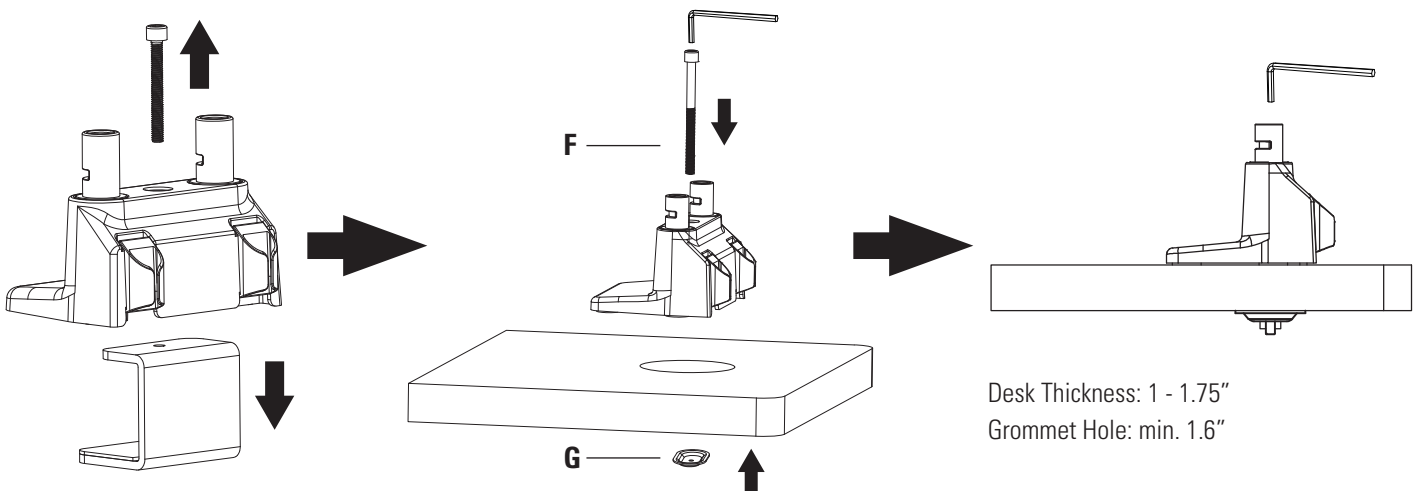

STEP 2 - ARM INSTALLATION

Tighten the screw on the back of the arm to secure.

PSMA2 shown. Instructions are applicable for both PSMA1 and PSMA2 monitor arms.

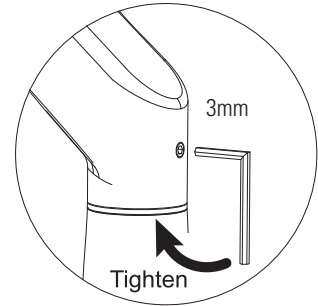
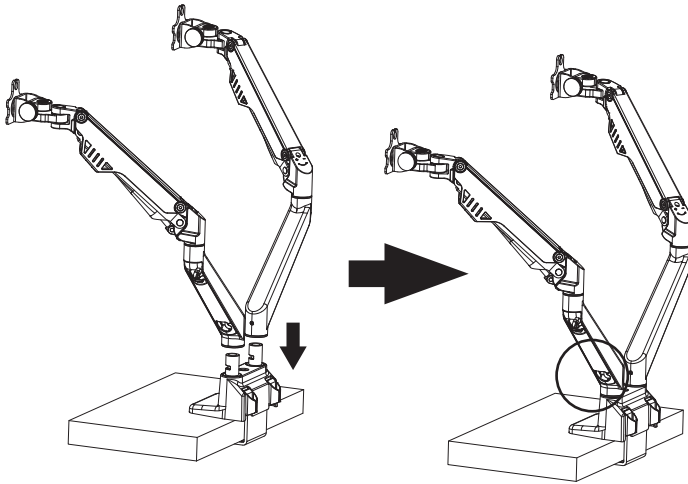

STEP 3 - VESA PLATE INSTALLATION

Tighten screws into VESA plate on VESA compliant monitor.

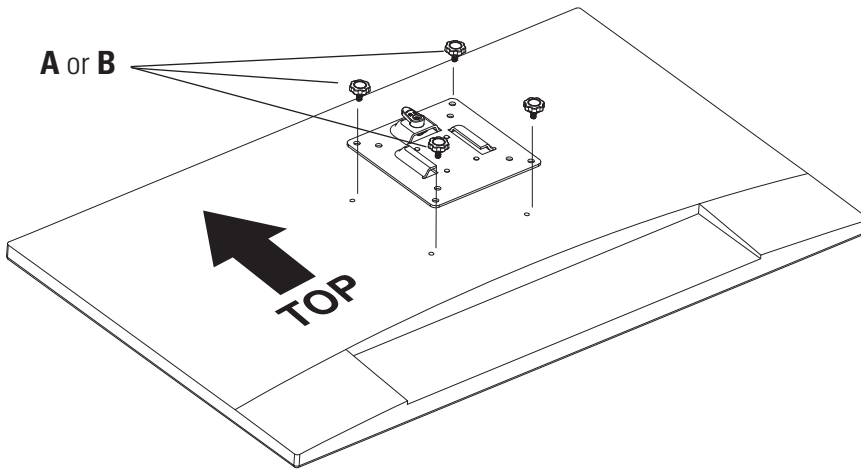

Part A - M4 x 9 screw is the default VESA screw size for most monitors and is designed to be hand-tightened.

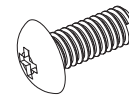

Part B - M4 x 12 screw is provided to accommodate monitors requiring longer VESA screws.

MONITOR ARM INSTALLATION GUIDE

STEP 4 - MONITOR INSTALLATION

Slide and lock-in.



Before sliding in, please make sure the knob on the VESA plate is vertical.



Then turn the knob to right to lock and fix the VESA plate

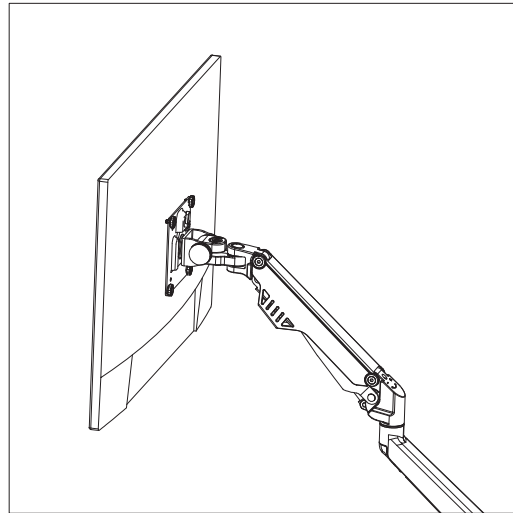
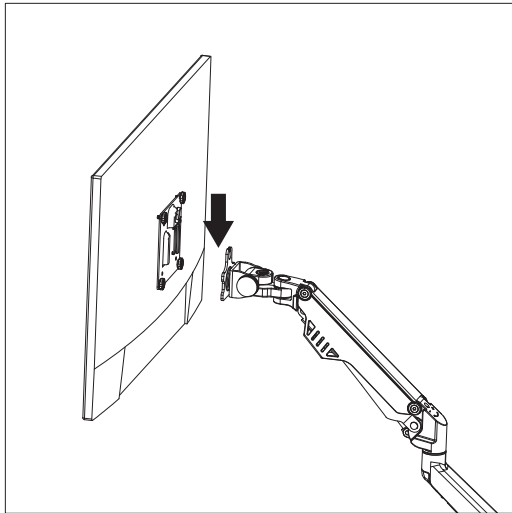

STEP 5 - MONITOR ARM TENSION ADJUSTMENT

Hold the arm in horizontal position during tension adjustment.

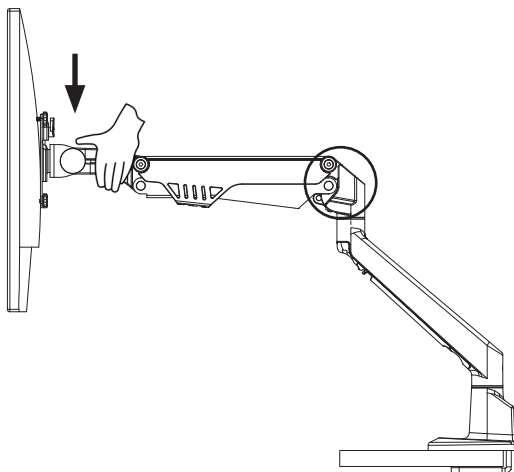

To counterbalance the arm, turn clockwise (-) to reduce tension or turn counter-clockwise (+) to increase tension until the monitor stays in place and can move up and down easily.

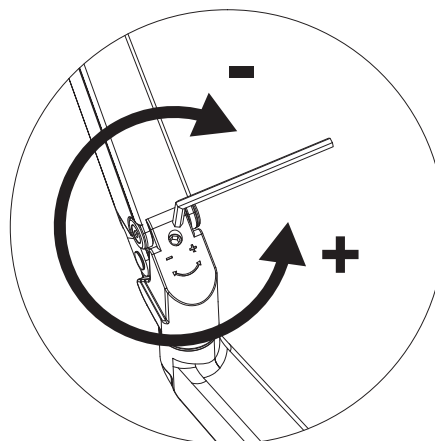

If the monitor drops, please turn the adjustment screw counter-clockwise (+) until it stays in place.

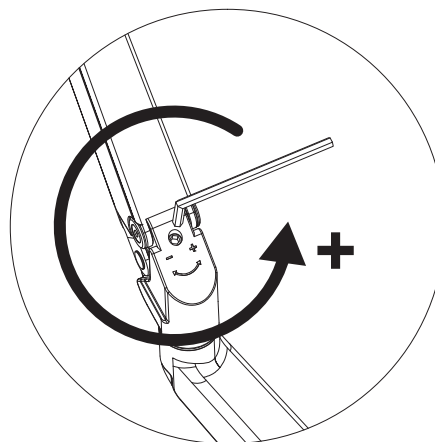
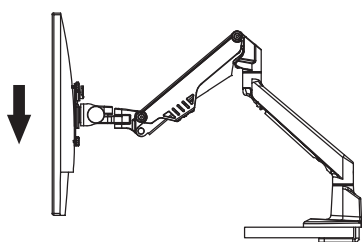

If the monitor goes up, please turn the adjustment screw clockwise (-) until it stays in place.

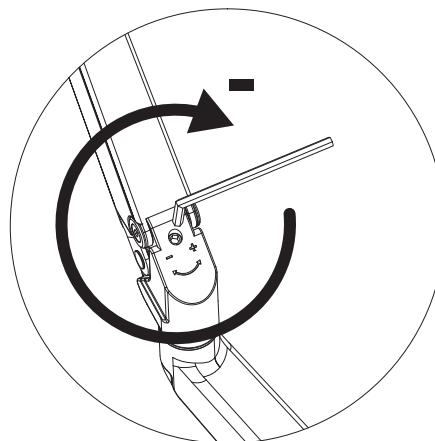
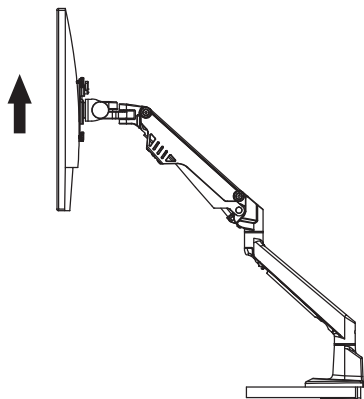

MONITOR ARM INSTALLATION GUIDE

NOTE - TILT ADJUSTMENT

Tighten the side and top tilt screws to lock the tilt angle for heavier monitors if necessary.

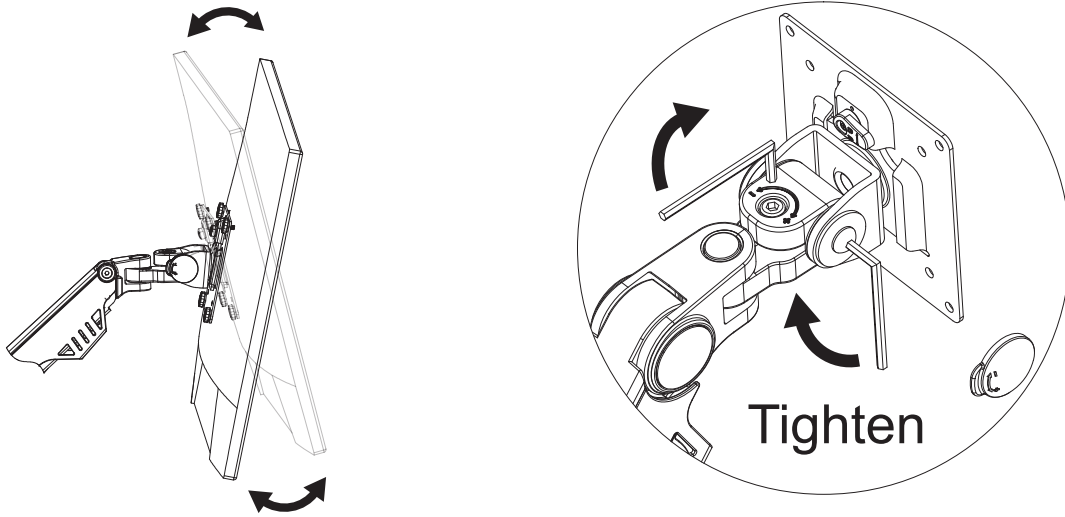

STEP 6 - CABLE MANAGEMENT

PSMA2 shown. Instructions are applicable for both PSMA1 and PSM2 monitor arms.

Cables can be threaded through upper and lower arm sections.

Note: Cable slack should be left to accommodate arm movement.

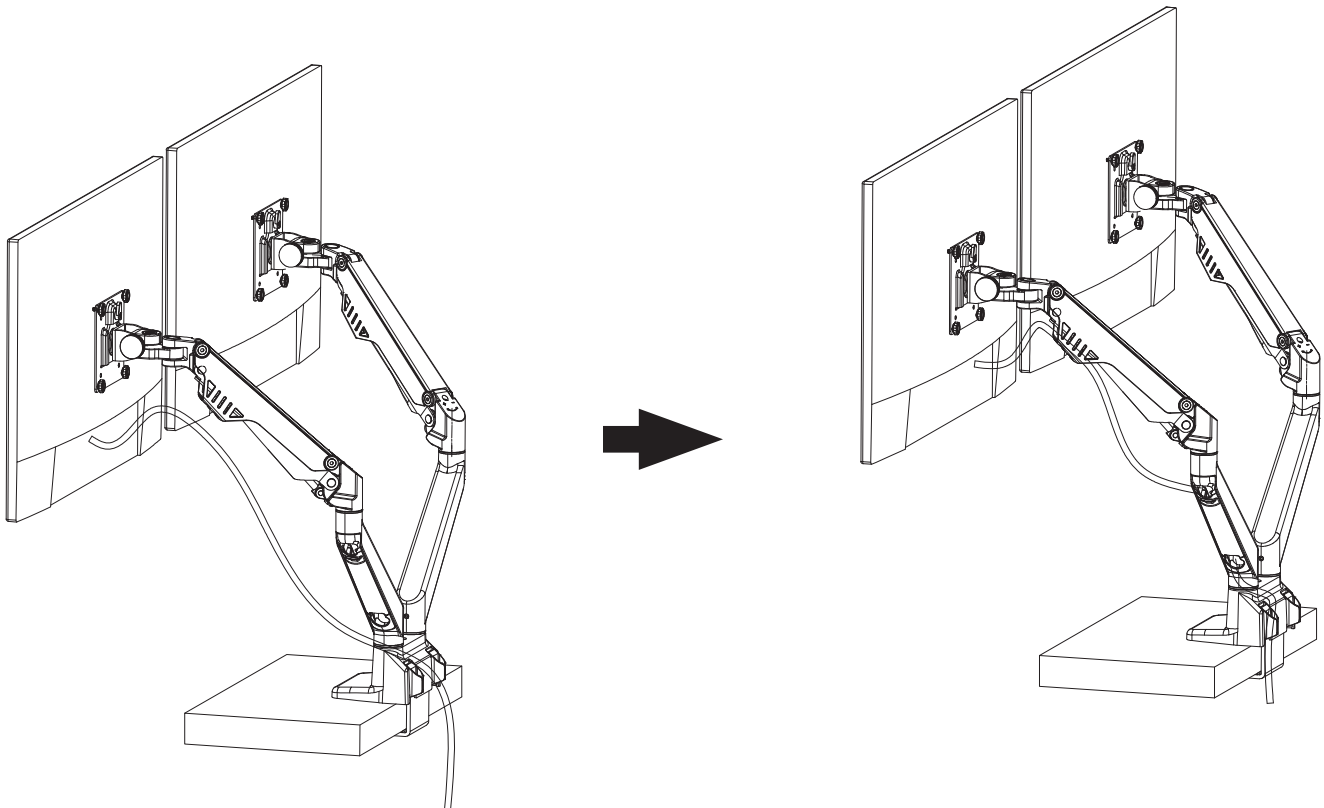

NOTE: OPTIONAL FUNCTION - 180° LOCK-OUT FUNCTION

PSMA2 shown. Instructions are applicable for both PSMA1 and PSM2 monitor arms.

The 180° lock-out function is optional, and is used to prevent the monitor arm from hitting into desktop dividers/screens or walls.

Make sure the lower section of the arm faces toward desktop area.

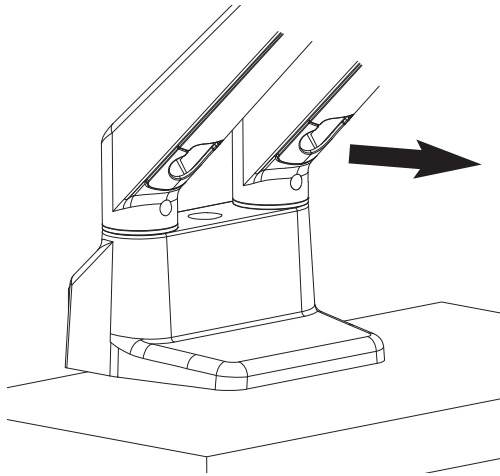

Remove the rubber cap on the front of the lower section arm.

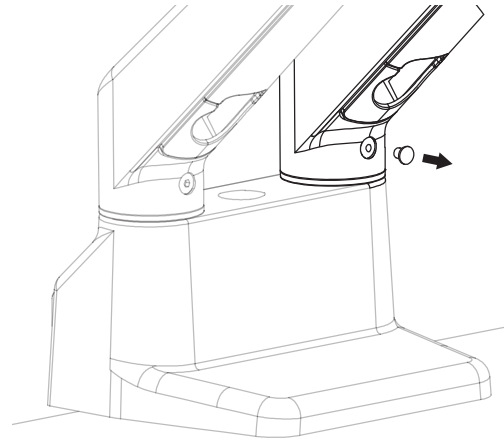

Insert and tighten the lock-out screw (Part E) to enable the 180° lock-out feature.

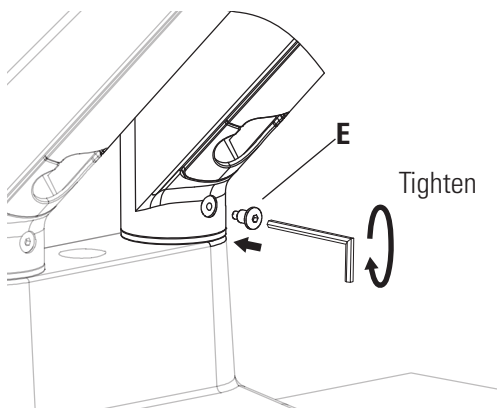

Tighten the lock-out screw.

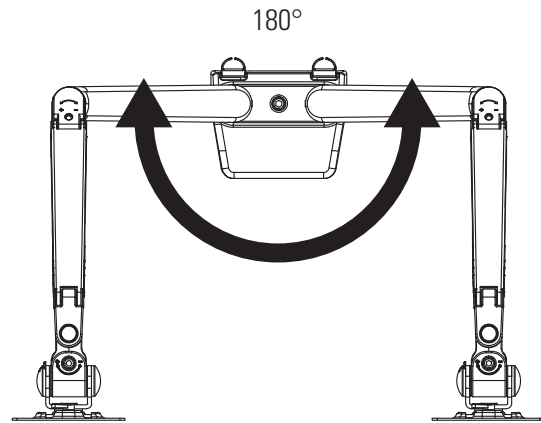

Arm can rotate 180°.

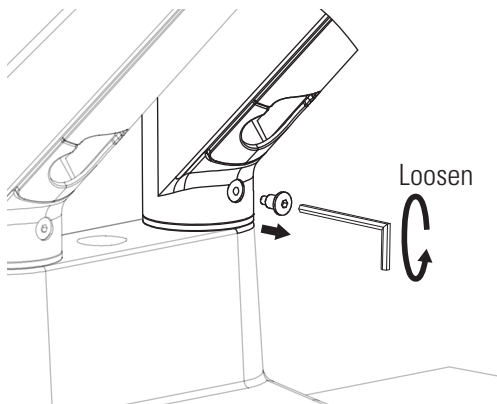

Remove the lock-out screw.

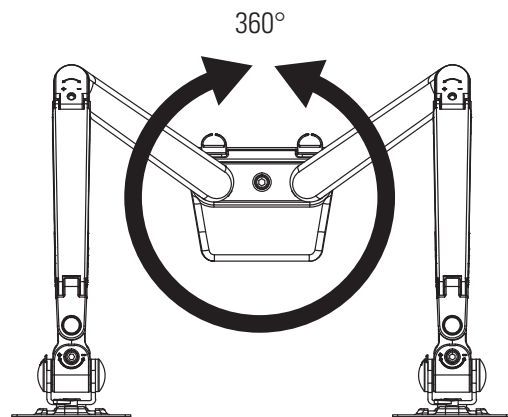

Arm can rotate 360°.