

# Kadin Installation Guide

Effective June 2024

---



# KADIN INSTALLATION GUIDE

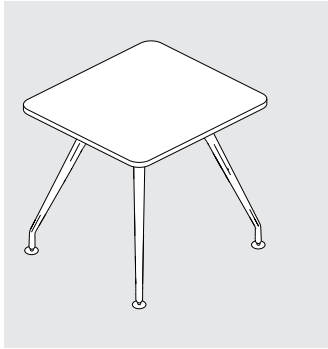

## Required Tools

Safety Glasses



Allenkey 3/16"

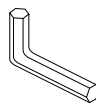

Rubber Mallet

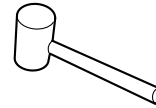

Drill



## Included Hardware

2 Way Connector

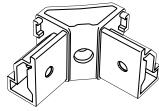

3 Way Connector

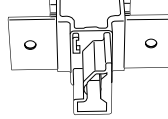

2 Way Connector 60 Degree

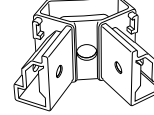

Beam

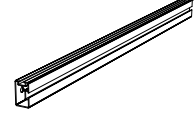

1/4 -20-0.5 Screw



Plastic Support



Diecast Support

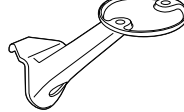

Leg



Slider



## KADIN PARTS BREAKDOWN:

SHAPE	SIZE	2 WAY 90 DEGREE	3 WAY 90 DEGREE RH	3 WAY 90 DEGREE LH	2 WAY 60 DEGREE	SCREW TO ATTACH LEG	PLASTIC SUPPORT	DIECAST SUPPORT	LEG	SLIDER	BEAM
		KDP2CNTR	KDP3CNTRR	KDP3CNTRL	KDP60CNTR	7280021	KDPS002P	KDPS001C	KDPLEG/ KDPLEGC	<i>ships installed on supports</i>	
<b>Square</b>	36-48	4				8			4		4
	54-60	4				16		4	4		4
<b>Round 3-leg</b>	36-48				3	6			3		3
	54-60				3	12		3	3		3
<b>Round 4-leg</b>	36-60	4				8			4		4
<b>Rectangular</b>	48	4				8			4		2 short, 2 long
	54-96	4				12		2	4		2 short, 2 long
<b>2 piece</b>	108-168	4	1	1		20	1	4	6		3 short, 4 long
<b>3 piece</b>	48x192	4	2	2		28	2	6	8		4 short, 4 long, 2 mid
	54/60 x 192-240	4	2	2		32	2	8	8		4 short, 4 long, 2 mid

Note: First assemble the depth, then assemble the width of the table.

Start at one end of the table and work your way through to the other end

STEP 1: Insert the slider into the groove. Align the slider's hole with the diecast support's hole (Or plastic support's Hole) and secure them together with the provided screw.

STEP 1b: Plastic supports are to be used at the seams between two adjoining table tops.

STEP 2: Attach the legs to either side of the beam with the provided screws.

STEP 3: Once one side is complete, attach the remaining beams to the assembly and add the provided diecast supports (tables up to 48" will not include diecast supports).

STEP 4: Each top will include metal inserts - connect the legs and supports to the top with the provided machine screws.

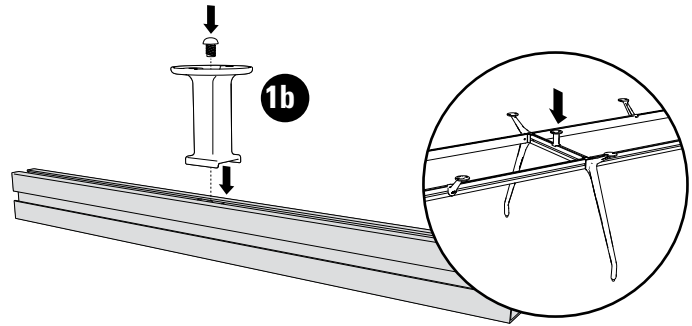
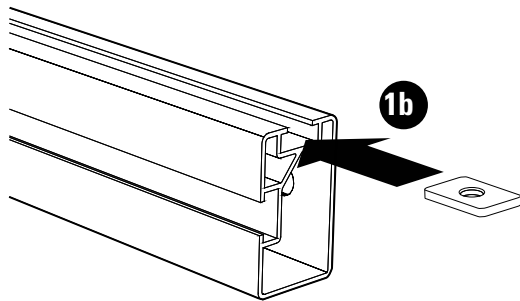
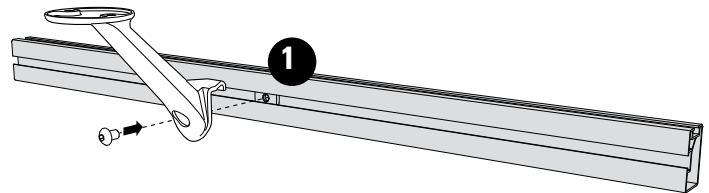
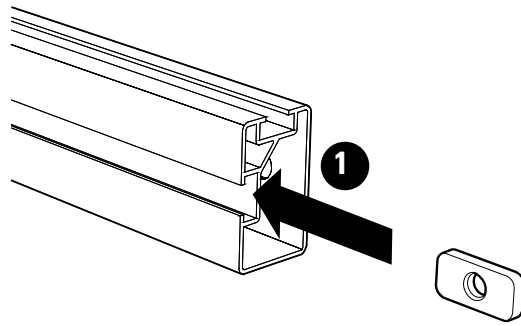

# KADIN INSTALLATION GUIDE

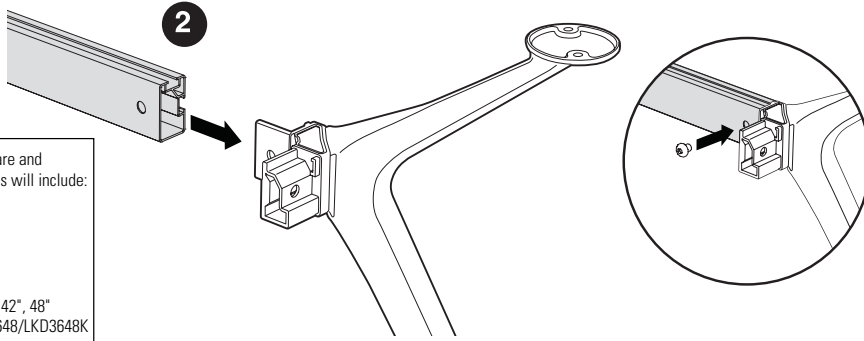

4-leg round, 4-leg square and 4-leg rectangular tables will include:  
 2-way connectors  
 Beams  
 Screws  
 Sliders  
 \*Diecast Supports  
 \*Not included on 36", 42", 48" round/square or LKD3648/LKD3648K

6-leg rectangular tables in two pieces will include:  
 2-way connectors  
 3-way connectors  
 Beams  
 Screws  
 Slides  
 Diecast Supports  
 Plastic Supports

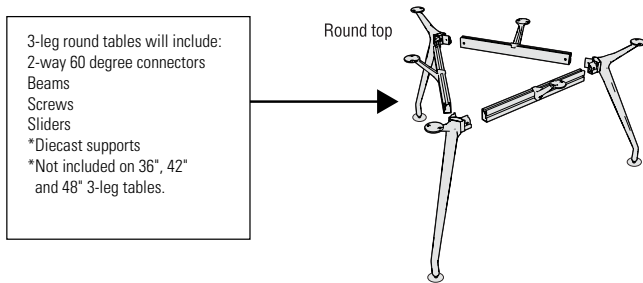
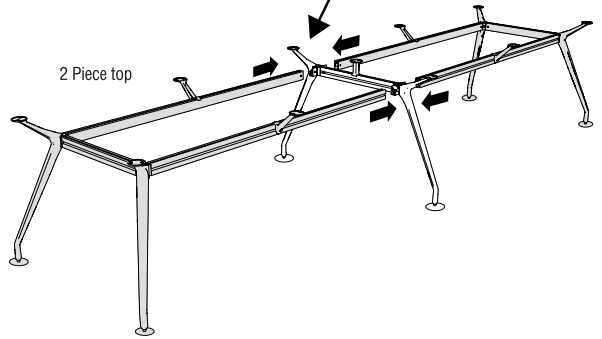
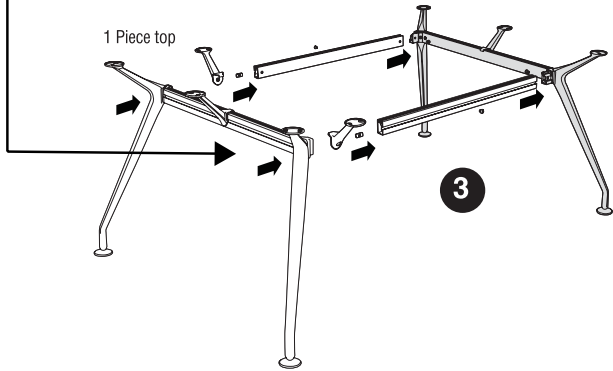

3-leg round tables will include:  
 2-way 60 degree connectors  
 Beams  
 Screws  
 Sliders  
 \*Diecast supports  
 \*Not included on 36", 42" and 48" 3-leg tables.

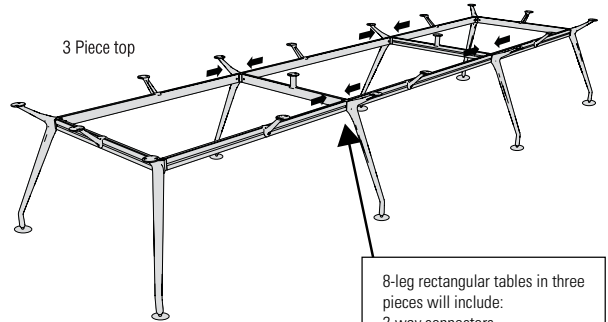

8-leg rectangular tables in three pieces will include:  
 2-way connectors  
 3-way connectors  
 Beams  
 Screws  
 Slides  
 Diecast Supports  
 Plastic Supports

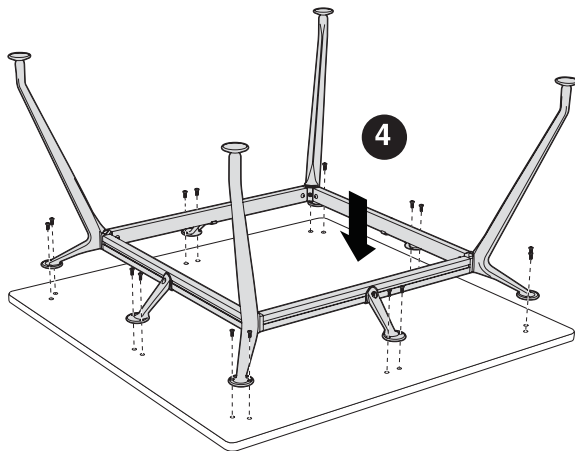

## Kadin Tables - Veneer and Laminate Tops with KL edge

### Freestanding Table Joint Connector

STEP 1: Insert wooden biscuits into slots provided.

STEP 2: Insert the long threaded screw into either section of the table. Push the screw all the way in and place the male connector into the top hole. Make sure the male connector slot is facing towards the threaded screw hole opening.

STEP 3: If required, rotate the threaded screw to lock the male connector as shown.

STEP 4: Insert the female connector on the other section. Bring the table section together and connecting the threaded screws with female connector.

STEP 5: Using the key provided, rotate the female connector to tighten the threaded screw.

